

Buy. Sell. Rent. Let.



Springbank, Grimsby



3



1



1

When it comes to
property it must be

lovelle



£85,000



This immaculate, terraced property features three bedrooms, a fully tiled bathroom, a modern kitchen with dining space, a spacious lounge with a bay window, UPVC double glazing, gas central heating, a low maintenance garden, and is conveniently located near public transport, local amenities, and schools, making it an ideal home for families, first-time buyers, or investors.

Key Features

- Terraced House
- Three Bedrooms
- Spacious Lounge
- Modern Kitchen
- Family Bathroom
- No Chain
- EPC rating E
- Tenure: Freehold





We are proud to present this immaculate, terraced property, currently listed for sale. Decorated to perfection, this residence offers an array of features that make it a truly unique home.

The property boasts three bedrooms, each tastefully decorated and ready to move into. The first two bedrooms are spacious and double-sized, providing ample room for a large bed and additional bedroom furniture. The third bedroom is a single room, perfect for a child's bedroom or home office.

The bathroom in this property is fully tiled and fitted with a WC, sink, and a bath with a shower over it, providing convenience.

The kitchen is a real highlight of this house. It includes a dining space, modern units, an oven and gas hob, and plumbing for a washer. The 1 & 1/3 sink offers plenty of space for washing up and preparing meals.

The reception room is a spacious lounge with a beautiful bay window, providing a generous amount of natural light.

Adding to the charm of this house are the UPVC double glazing and gas central heating, keeping the house warm and cosy throughout the year. The house has been freshly decorated, enhancing its attractiveness and making it an even more appealing option for prospective buyers.

The low maintenance garden is an added bonus, providing an outdoor space that requires minimal upkeep, allowing more time to relax and enjoy the surroundings.

Located with easy access to public transport links, local amenities, and nearby schools, this property is ideally placed for families, first-time buyers, or BTL investors.

In conclusion, this immaculately presented terraced property offers a wealth of features and a favourable location, making it a fantastic buying opportunity. With its modern decor, spacious rooms, and convenient location, it is a home ready to be moved into and enjoyed.

Measurements

Lounge 4.54m X 3.74m

Kitchen 3.05m X 4.62m

Bathroom 2.18m X 1.71m

Bedroom 1 3.96m X 2.81m

Bedroom 2 3.08m X 2.90m

Bedroom 3 1.66m X 2.45m

Disclaimer

We endeavour to make our sales particulars accurate and reliable, however, they do not constitute or form part of an offer or any contract and none is to be relied upon as statements of representation or fact. Any services, systems and appliances listed in this specification have not been tested by us and no guarantee as to their operating ability or efficiency is given. All measurements have been taken as a guide to prospective buyers only, and are not precise. If you require clarification or further information on any points, please contact us, especially if you are travelling some distance to view.

Mobile and broadband

It is advised that prospective purchasers visit checker.ofcom.org.uk in order to review available wifi speeds and mobile connectivity at the property.

Ground Floor

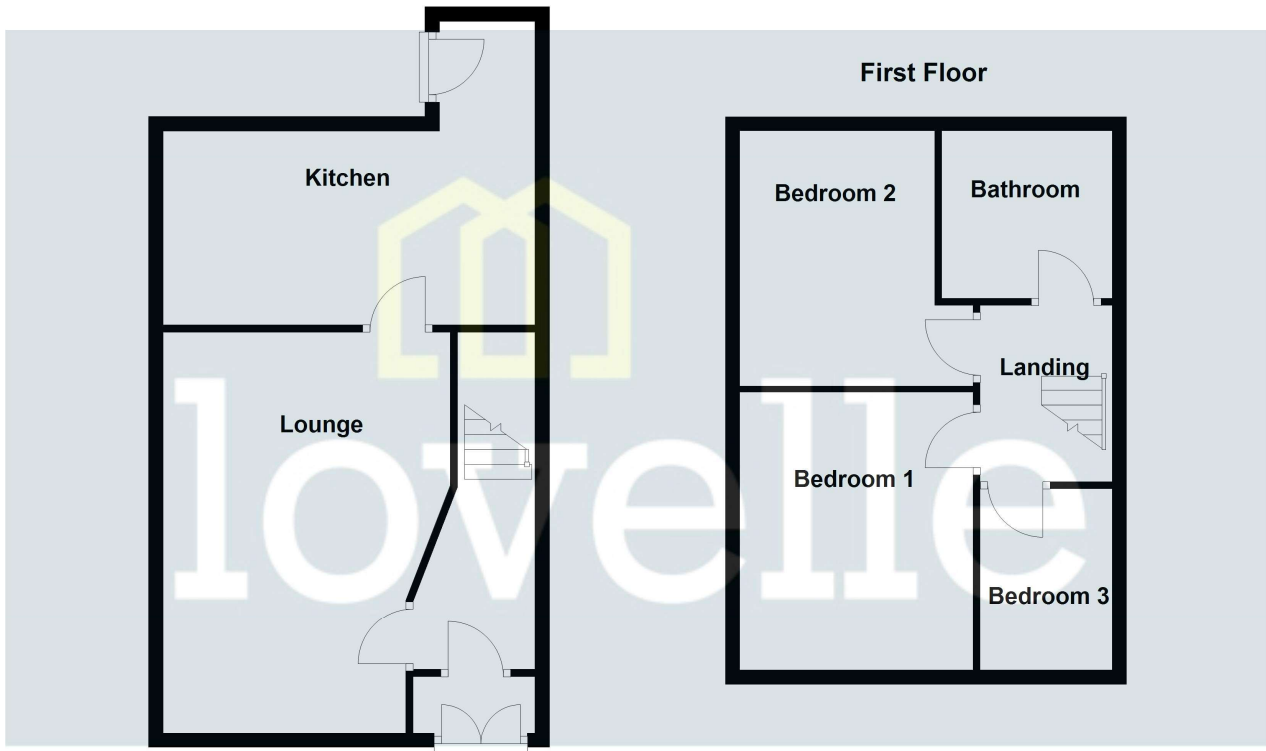

Please be advised that the floor plan is not drawn to scale and is to be used for illustrative purposes only.
Plan produced using PlanUp.

Springbank, Grimsby

When it comes to **property**
it must be

lovelle

01472 251918

grimsby@lovelle.co.uk