

Buy. Sell. Rent. Let.

lovelle



Oxford Street, Grimsby



When it comes to
property it must be

lovelle



£69,950



A ready made investment opportunity! A wonderful semi-detached house currently LET on an assured shorthold tenancy producing £6,480 per annum and having a valid EPC, EICR and Gas Safety Certificates. Don't miss out on this fantastic opportunity!

Key Features

- Semi-Detached House
- Ideal First Time Purchase Or Investment
- Currently LET
- Two Bedrooms
- Lounge, Kitchen & Bathrooms
- Gas Central Heating & Timber SG Windows
- EPC rating D
- Tenure: Freehold



****CURRENTLY LET AT £6,480per annum**** A spacious semi-detached house comprising of two bedrooms, lounge, bathroom and kitchen. Benefitting from gas central heating and timber single glazed windows. Located within a well established town centre residential area boasting ease of access to a vast range of local amenities.

Measurements

-

Lounge 4.60m X 3.66m

Kitchen 3.62m X 2.89m

Bedroom 1 3.66m X 3.52m

Bedroom 2 2.89m X 1.94m

Bathroom 1.70m X 1.90m

Disclaimer

-

We endeavour to make our sales particulars accurate and reliable, however, they do not constitute or form part of an offer or any contract and none is to be relied upon as statements of representation or fact. Any services, systems and appliances listed in this specification have not been tested by us and no guarantee as to their operating ability or efficiency is given. All measurements have been taken as a guide to prospective buyers only, and are not precise. If you require clarification or further information on any points, please contact us, especially if you are travelling some distance to view.

Mobile and broadband

-

It is advised that prospective purchasers visit [checker . ofcom . org . uk](http://checker.ofcom.org.uk) in order to review available wifi speeds and mobile connectivity at the property.

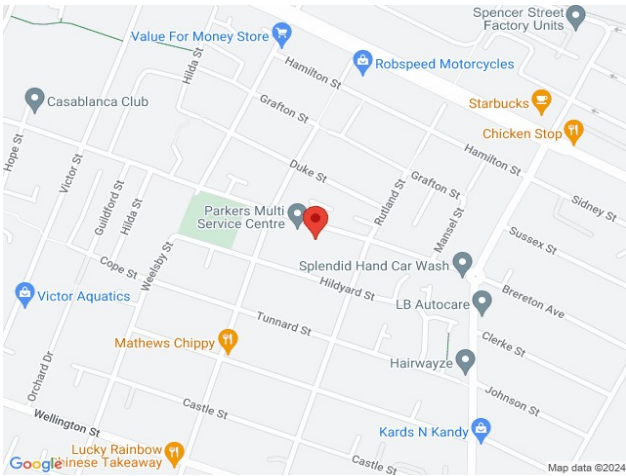
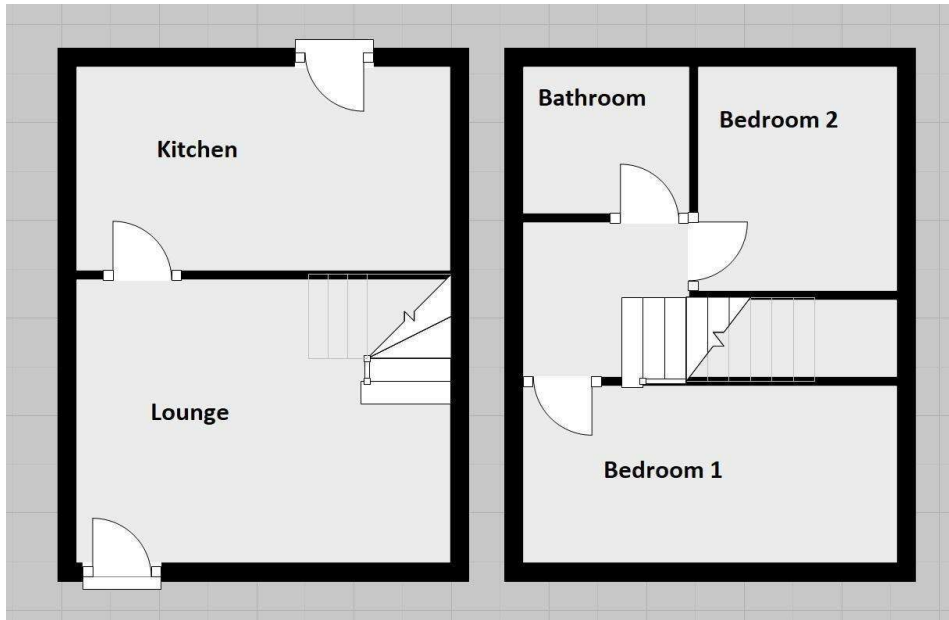

When it comes to **property**
it must be



lovelle

01472 251918
grimsby@lovelle.co.uk

