

Buy. Sell. Rent. Let.



Ainslie Street, Grimsby



When it comes to
property it must be

lovelle



£74,950



A wonderful two-bedroom first floor apartment located in the immediate town centre of Grimsby.

Key Features

- Stunning First Floor Apartment
- Spacious Accommodation
- Two Double Bedrooms
- Exquisite Kitchen/Diner
- Modern Bathroom
- uPVC Double Glazed & Gas Central Heated
- EPC rating C
- Tenure: Freehold



****FREEHOLD**** Lovelle offer to market with NO ONWARD CHAIN this stunning first floor apartment having recently been refurbished to a high standard throughout whilst also benefitting from uPVC double glazing and gas central heating. Located within a popular town centre location within easy reach to the vast range of local amenities including being just 100m from the beautiful tree lined 'Peoples Park'. This spacious apartment really must be viewed in order to fully appreciate all it has to offer.

Communal Hall

N/a

Entered through a composite entrance door, wood effect laminate flooring and entrance door leading to Flat 3.

Hall Stairs And Landing

N/a

Welcoming hall with hanging space for jackets and coats. Stairs lead to the first floor split-level landing where you are greeted with a sense of space and a range of attractive period features.

Lounge

5.67m x 4.29m (18'7" x 14'1")

Neutrally decorated with laminate flooring, two radiators and three windows to the front aspect.

Kitchen/Diner

3.83m x 3.65m (12'7" x 12'0")

Well fitted modern wall and base units with complimentary worktops over incorporating sink with mixer tap. Built in appliances to include; oven, hob and extra hood. Plumbing and space for washing machine. Space for dining table, radiator and window to the rear aspect.

Bathroom

1.62m x 2.53m (5'4" x 8'4")

Stunning suite comprising of; panelled bath with shower over, wash hand basin, wc, extractor fan, towel radiator and window to the side aspect.

Bedroom 1

3.72m x 3.69m (12'2" x 12'1")

Neutrally decorated, laminate flooring, radiator and window to the rear aspect.

Bedroom 2

0.00m x 0.00m (0'0" x 0'0")

Neutrally decorated, laminate flooring, radiator and window to the side aspect.

Disclaimer

0.00m x 0.00m (0'0" x 0'0")

We endeavour to make our sales particulars accurate and reliable, however, they do not constitute or form part of an offer or any contract and none is to be relied upon as statements of representation or fact. Any services, systems and appliances listed in this specification have not been tested by us and no guarantee as to their operating ability or efficiency is given. All measurements have been taken as a guide to prospective buyers only, and are not precise. If you require clarification or further information on any points, please contact us, especially if you are travelling some distance to view.

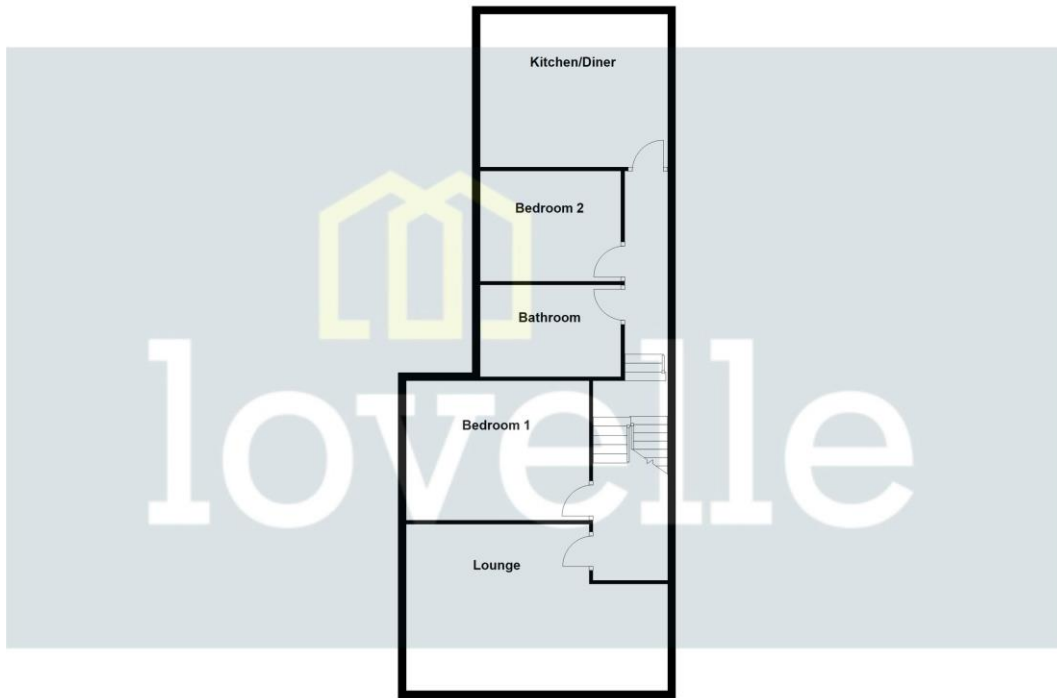

Ainslie Street, Grimsby



When it comes to **property**
it must be

01472 251918
grimsby@lovelle.co.uk

