

Buy. Sell. Rent. Let.

lovelle



Arnold Close , Laceby



3



2



2

When it comes to
property it must be

lovelle



£199,950.



An immaculate three-bedroom detached home, situated in the sought after village of Laceby with open fields to the rear....

Key Features

- Detached Home
- Three Bedrooms
- Kitchen Diner
- Lounge
- Downstairs Wc
- Family Bathroom
- EPC rating C
- Tenure: Freehold



Situated in a prominent position within a quiet cul-de-sac on the edge of Laceby. The property enjoys open countryside to the rear, three bedrooms, open plan kitchen diner, lounge, bathroom, ensuite and integral garage.

Entrance

n/a

Entered through a composite door to the entrance porch. Door to the lounge.

Lounge

3.58m x 5.05m (11'8" x 16'7")

UPVC window to the front, central heating radiator, laminate flooring, electric fire and door to the dining area.

Dining Area

2.40m x 3.41m (7'11" x 11'2")

UPVC double doors to the rear garden. Central heating radiator and laminate flooring. Open plan to the kitchen.

Kitchen

3.16m x 2.61m (10'5" x 8'7")

Having a range of wall and base units incorporating a four ring gas hob, electric cooker, plumbing for washing machine, space for tumble dryer. Sink with mixer tap. Laminate flooring. UPVC window to the rear. Central heating radiator.

Cloakroom WC

n/a

With a two-piece suite including a wc and sink.

UPVC window to the side elevation. Central heating radiator.

Bedroom One

3.81m x 3.36m (12'6" x 11'0")

UPVC window to the rear looking over open countryside. Central heating radiator. Built in wardrobe. Door to the ensuite.

Ensuite

1.60m x 1.58m (5'2" x 5'2")

A three-piece suite including a shower cubicle, wc, sink. UPVC window. Central heating radiator.

Bedroom Two

3.09m x 3.42m (10'1" x 11'2")

Central heating radiator.

UPVC window to the front elevation.

Bedroom Three

2.62m x 2.64m (8'7" x 8'8")

Central heating radiator. UPVC window to the front.

n/a

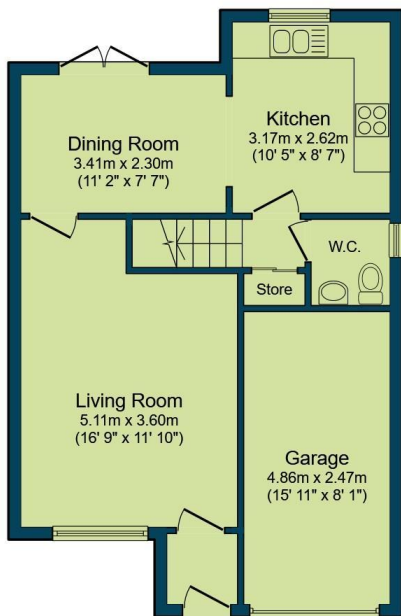

Ground Floor

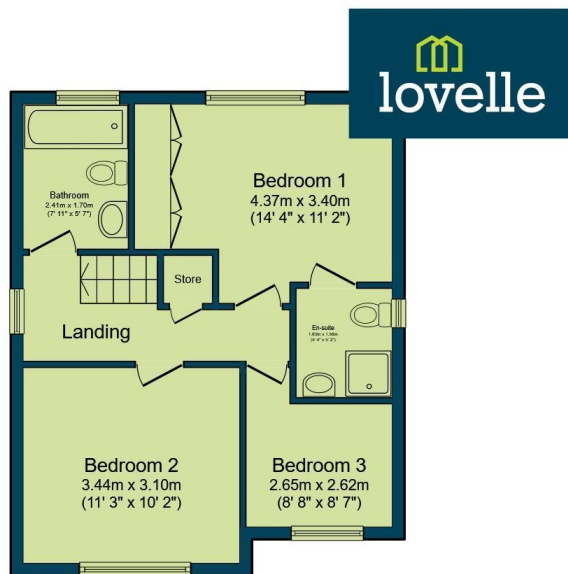

First Floor



Total floor area 98.2 m² (1,057 sq.ft.) approx

This floor plan is for illustrative purposes only. It is not drawn to scale. Any measurements, floor areas (including any total floor area), openings and orientation are approximate. No details are guaranteed, they cannot be relied upon for any purpose and they do not form part of any agreement. No liability is taken for any error, omission or misstatement. A party must rely upon its own inspection(s). Powered by www.focalagent.com



When it comes to **property** it must be

01472 251918
grimsby@lovelle.co.uk

