

Buy. Sell. Rent. Let.



Beeson Street, Grimsby



3



1



2

When it comes to
property it must be

lovelle



£59,950



A spacious three bedroom mid-terrace house located within Grimsby Town Centre.

Key Features

- Mid-Terrace
- Spacious Accommodation
- Three Bedrooms
- Two Reception Rooms
- GF Bathroom
- FF Separate WC
- EPC rating D
- Tenure: Freehold



Lovelle offer to market this spacious mid-terrace house offering spacious accommodation that benefits from uPVC double glazing, gas central heating and briefly comprises of; entrance hall, lounge, dining room, kitchen, bathroom, landing, separate wc and three bedrooms. Externally there are gardens to both the front and rear. Located within a well established area of Grimsby Town Centre and boasting ease of access to the vast range of local amenities on offer.

Measurements

0.00m x 0.00m (0'0" x 0'0")

Lounge 4.52m X 3.00m

Dining Room 2.58m X 4.03m

Kitchen 2.36m X 4.79m

Bathroom 1.84m X 2.22m

Bedroom 1 4.04m X 3.43m

Bedroom 2 3.64m X 3.10m

Bedroom 3 2.42m X 2.30m

First Floor Wc 0.65m X 2.36m

Disclaimer

0.00m x 0.00m (0'0" x 0'0")

We endeavour to make our sales particulars accurate and reliable, however, they do not constitute or form part of an offer or any contract and none is to be relied upon as statements of representation or fact. Any services, systems and appliances listed in this specification have not been tested by us and no guarantee as to their operating ability or efficiency is given. All measurements have been taken as a guide to prospective buyers only, and are not precise. If you require clarification or further information on any points, please contact us, especially if you are travelling some distance to view.



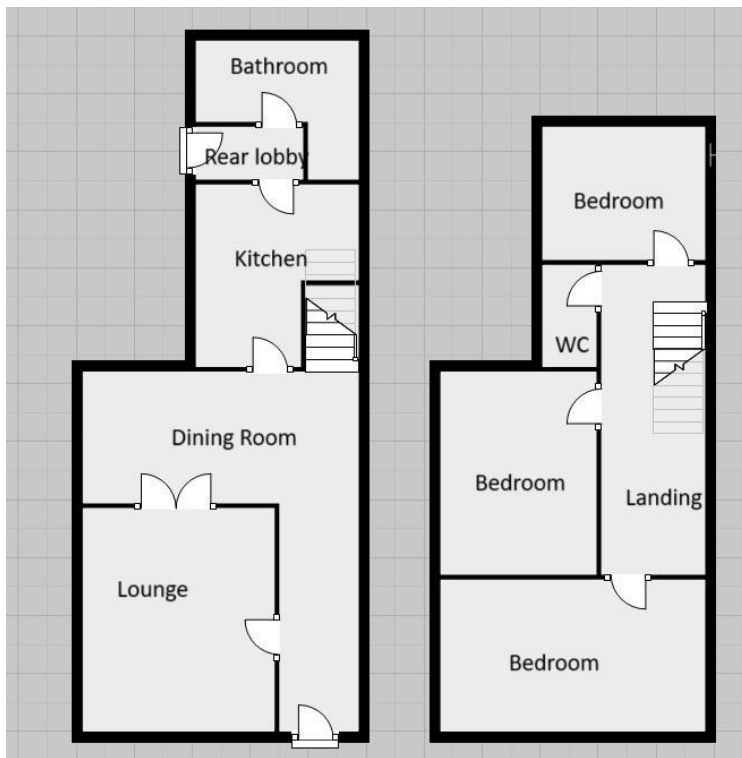

When it comes to **property**
it must be

01472 251918
grimsby@lovelle.co.uk

