

Buy. Sell. Rent. Let.

lovelle



Chelmsford Avenue, Grimsby



When it comes to
property it must be

lovelle



£134,500



Well presented three bedroom semi-detached house located in Grimsby Town Centre.

Key Features

- Semi-Detached House
- Three Bedrooms
- Two Reception Rooms
- Modern Kitchen & Bathroom
- Sun Room
- Front & Rear Gardens
- EPC rating D
- Tenure: Freehold



Lovelle offer to market with NO ONWARD CHAIN this spacious and well presented three bedroom semi-detached house, located within a well established area of Grimsby Town Centre and positioned well for ease of access to the vast range of local amenities on offer.

Benefitting from uPVC double glazing and gas central heating throughout, the accommodation briefly comprises of; entrance hall, lounge, sitting room, kitchen, sun room, three bedrooms and family bathroom.

Externally there are well landscaped and well stocked gardens to both the front and rear, there is ample off-road parking and detached rear garage.

Disclaimer

We endeavour to make our sales particulars accurate and reliable, however, they do not constitute or form part of an offer or any contract and none is to be relied upon as statements of representation or fact. Any services, systems and appliances listed in this specification have not been tested by us and no guarantee as to their operating ability or efficiency is given. All measurements have been taken as a guide to prospective buyers only, and are not precise. If you require clarification or further information on any points, please contact us, especially if you are travelling some distance to view.



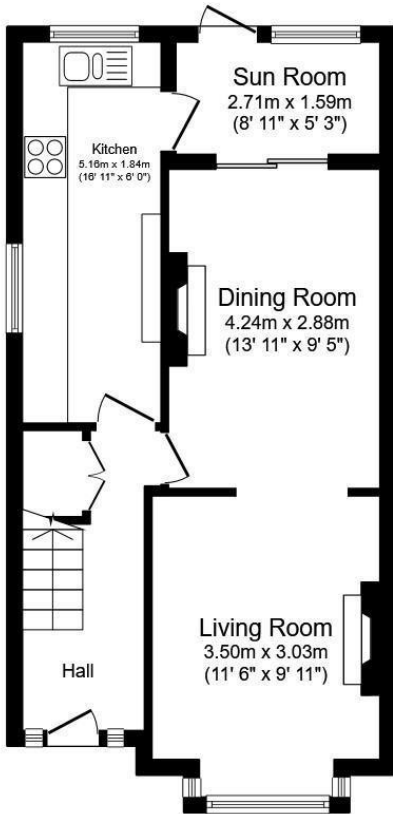

Ground Floor

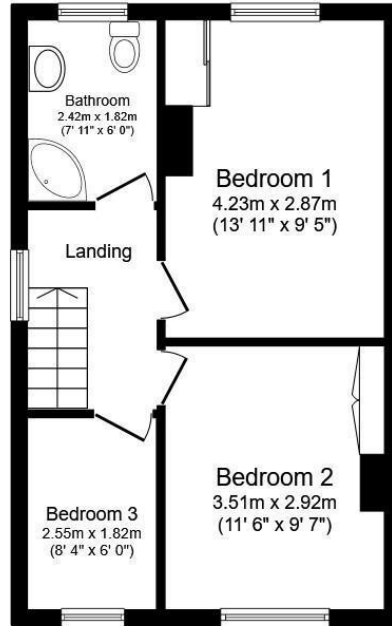

First Floor

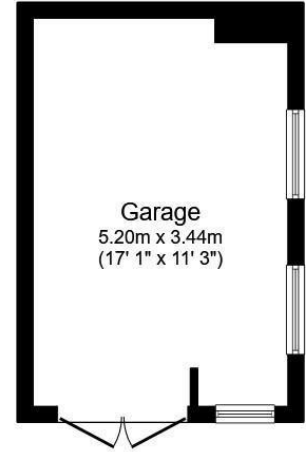

Garage



When it comes to **property**
it must be

lovelle

01472 251918

grimsby@lovelle.co.uk

