



stevengoates.com



Oak Lodge Ponsbourne Manor

Newgate Street Village, Hertford, SG13 8QR

Price Guide £875,000



5



3



2



Floor Plan

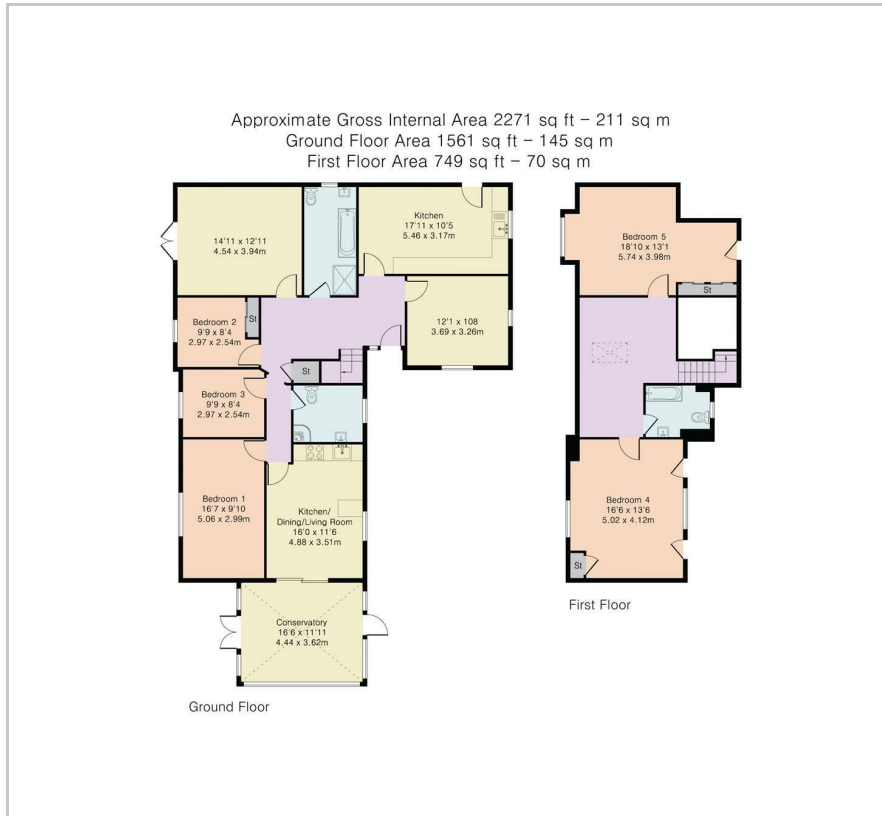

Area Map



Energy Efficiency Graph

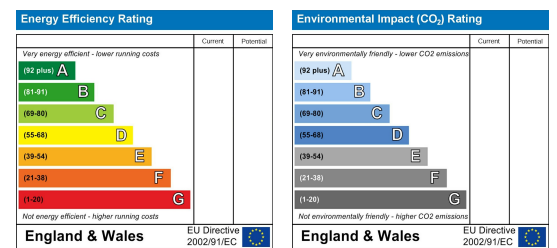

Viewing

Please contact our Hertford Office on 01992303300 if you wish to arrange a viewing appointment for this property or require further information.

- Three Bedroom Chalet ■ Two Reception Rooms Bungalow
- Detached Family Home ■ Oil Fired Central Heating
- Secluded Village Location ■ Carriage Driveway
- Two Bathrooms ■ Self Contained Annex

**** CHAIN FREE **** Steven Oates are delighted to offer for sale this five bedroom detached chalet bungalow situated in the popular village of Newgate Street. The property offers good sized accommodation to include a living room, separate dining room, large fitted kitchen, downstairs bedroom/study and downstairs bathroom. The first floor comprises of two large sized double bedrooms and family bathroom. The property currently has been divided to offer a self contained 2 bedroom annex with own open plan living area/kitchen and bathroom. Externally the property offers a large driveway with carriage circle and good sized rear garden. Priced to sell.



These particulars, whilst believed to be accurate are set out as a general outline only for guidance and do not constitute any part of an offer or contract. Intending purchasers should not rely on them as statements of representation of fact, but must satisfy themselves by inspection or otherwise as to their accuracy. No person in this firm's employment has the authority to make or give any representation or warranty in respect of the property.