



8, Fallow Rise, Hertford
SG13 7NL
Guide Price £220,000



stevenoates.com



8 Fallow Rise, Hertford, Herts, SG13 7NL

**** Brand New Lease **** A spacious first floor apartment located within a popular development close to Hertford town centre. The property offers 'light & airy' accommodation including a good size living room, separate kitchen, double bedroom and a bathroom. Externally, there is allocated parking. BEING OFFERED NO ONWARD CHAIN.

Fallow Rise is a popular development located within a short distance of Hertford town centre and Hertford East station. Hertford town centre offers a wide choice of shops, restaurants, bars and coffee shops, along with Hertford East train station which offers services to both London's Tottenham Hale and Liverpool Street. Hartham Common is also close by providing excellent green space and Hartham Leisure Centre.



70 Fore Street, Hertford, Hertfordshire, SG14 1BY

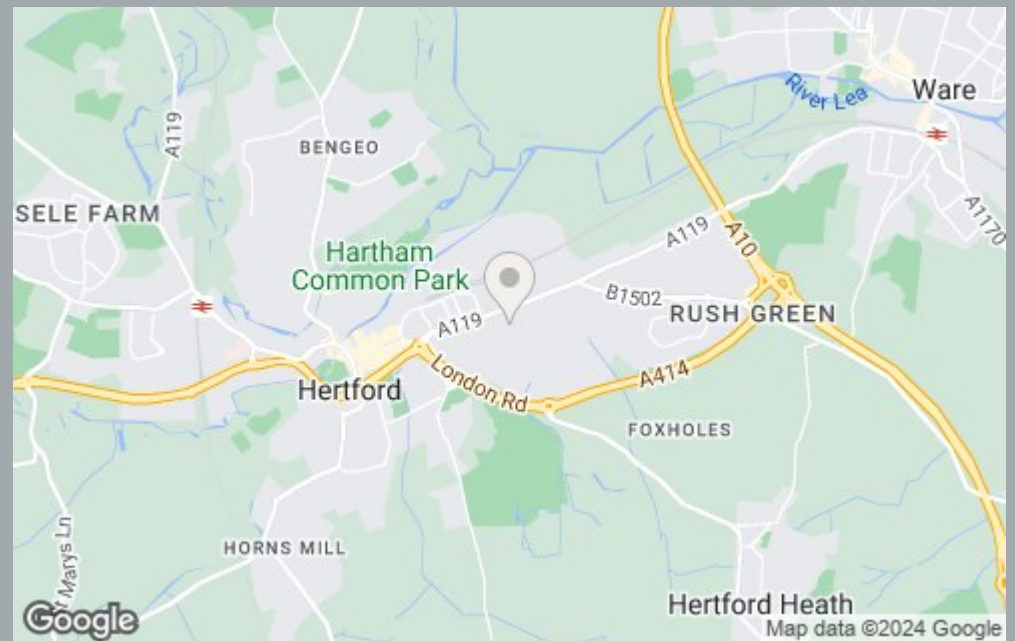

70 Fore Street, Hertford, Hertfordshire, SG14 1BY

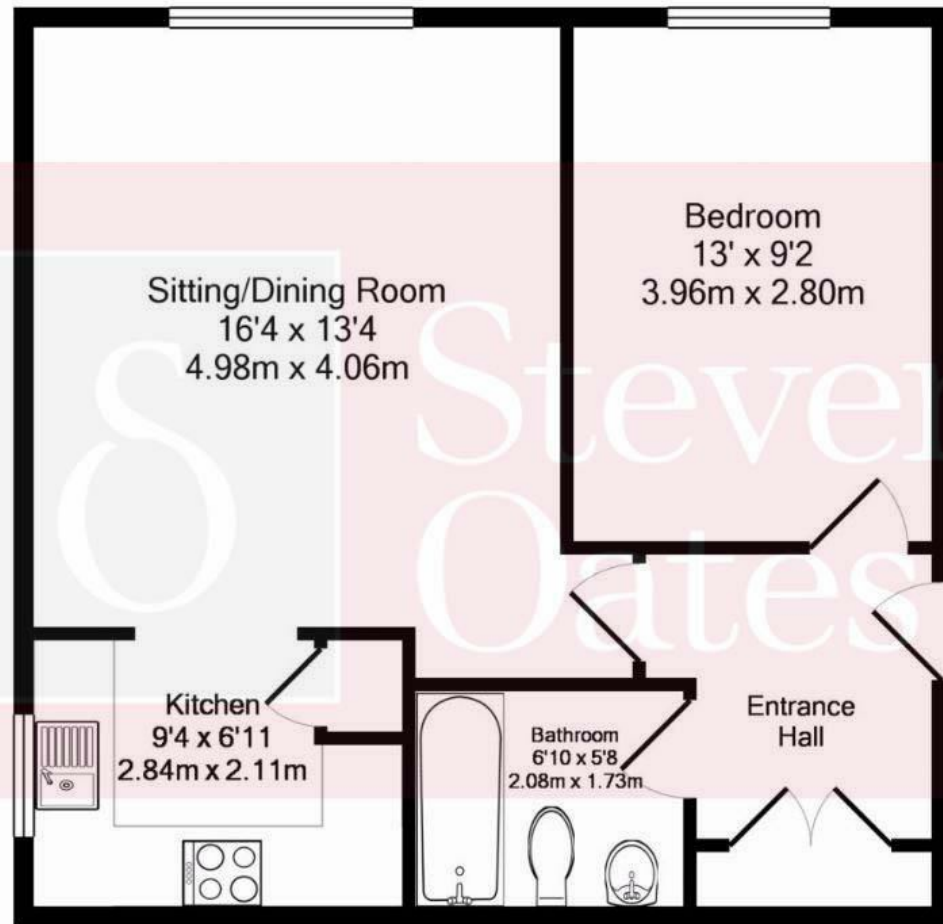

These particulars, whilst believed to be accurate are set out as a general outline only for guidance and do not constitute any part of an offer or contract. Intending purchasers should not rely on them as statements of representation of fact, but must satisfy themselves by inspection or otherwise as to their accuracy. No person in this firm's employment has the authority to make or give any representation or warranty in respect of the property.



stevenoates.com