

Est. 1947

tomkinsdavis

www.tomkinsdavis.co.uk



**Providence Lane, Middlesex
UB3 5EF**

Asking Price £485,000

EPC Current Band: C

A well-presented three bed family home offering accommodation on a peaceful cul-de-sac directly off Harlington High Street. This smart home comprises; a sizeable lounge, open plan kitchen-diner, three double bedroom, modern bath suite and spacious rear garden.

With amenities nearby including popular schools, local shops, healthcare facilities and ample green spaces, the property also benefits numerous transport links within easy reach including the M4 Motorway and Hayes & Harlington Railway Station connecting to Heathrow Airport and Central London.



Ground Floor

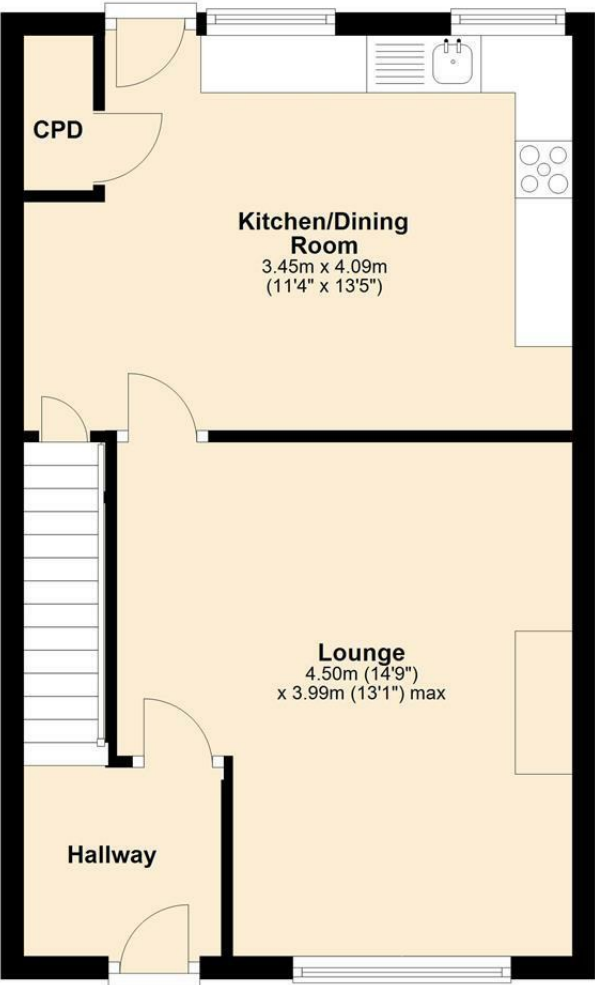

First Floor

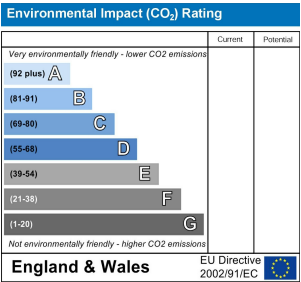
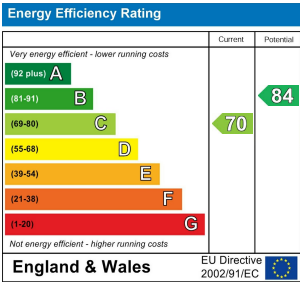
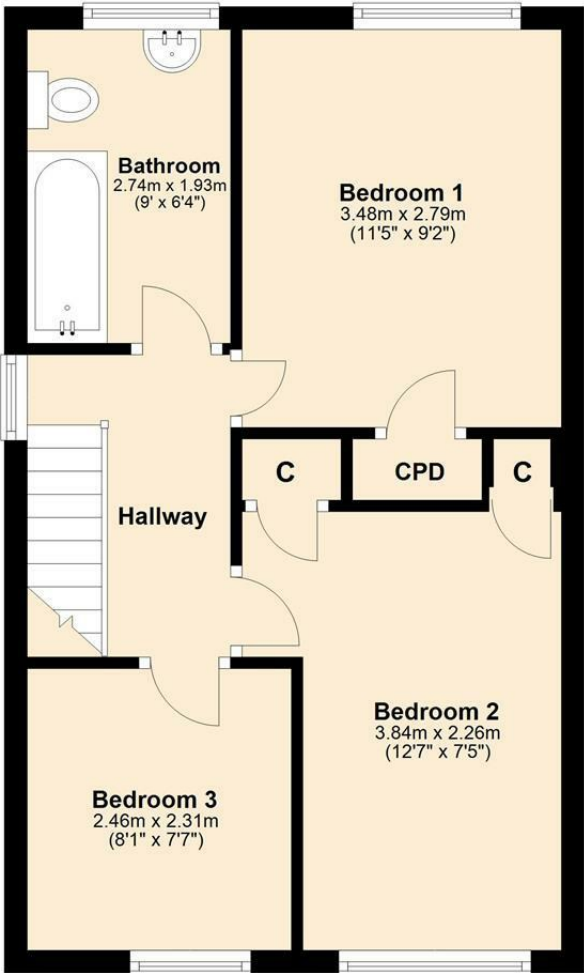

Whilst every attempt has been made to ensure the accuracy of the floor plan contained here, measurements of doors, windows, rooms and other areas are approximate and no responsibility taken for any error, omission or mis-statement. This plan is for illustration purposes only and should be used as such by any prospective purchaser or advisor. Tomkins Davis have not tested any apparatus, equipment, fixtures and fittings or services therefore cannot verify that they are in good working order or fit for purpose. Neither have we checked any legal documentation to verify the leasehold or freehold status of the property and advise any purchaser to obtain verification from their solicitor or surveyor.