



12 RHODES CLOSE, HASLINGTON, CREWE, CW1
5ZF

OFFERS IN THE REGION OF £365,000



STEPHENSON BROWNE

ONWARD CHAIN SECURED. This immaculately decorated detached family home offers a perfect blend of comfort and convenience. With its attractive façade and well-maintained exterior, this property is sure to capture your attention.

Upon entering through the new addition porch, you are greeted by a grand entrance hall with new oak bannister and balustrades, leading through to the spacious living room that flows seamlessly into a dining room, providing an ideal space for family gatherings and entertaining guests. A study offers a quiet retreat for work or relaxation, while the conservatory invites natural light and views of the garden, creating a serene atmosphere. The well-appointed kitchen, complete with a separate utility area, ensures that all your culinary needs are met, with the added bonus of an understairs pantry.

The first floor boasts four generously sized double bedrooms, each equipped with built-in wardrobes, providing ample storage space. The main bedroom is impressive in size and style, with new carpets and decor, with ample space for furniture and featuring its own ensuite, offering a private sanctuary, while a family bathroom and a convenient WC on the ground floor cater to the needs of the household.

Outside, the property benefits from driveway parking for multiple vehicles, along with a garage for additional storage or workshop space. The enclosed and private rear garden is perfect for outdoor activities, gardening, or simply enjoying the fresh air in a tranquil setting.

This home is ideally situated in a popular village, making it a wonderful choice for families seeking a peaceful yet connected lifestyle. With its spacious layout and desirable features, this property is not to be missed. Come and experience the charm of Haslington living in this lovely family home.



Porch

Renovated in 2024. Adding to security and warmth in winter.

Hallway

18'7" x 5'8"
With new oak bannister and balustrades.

Living Room

18'10" x 10'8"
A remote controlled electric fire. Bay window.

Dining Room

9'6" x 8'7"
Space for a large dining table.

Kitchen

10'7" x 9'6"
A range of wall and base units with work surface over. Neff electric oven and four ring gas hob with extractor above. Integrated Bosch dishwasher. Space for a fridge / freezer. Understairs pantry.

Utility

9'6" x 4'11"
A wall unit and worksurface with ample space underneath for a variety of appliances and storage solutions. Space and plumbing for a washing machine, tumble dryer, under counter fridge or freezer and space for a tall fridge freezer.

Conservatory

11'1" x 9'10"
With electric underfloor heating. Gas radiator, power sockets and fitted vertical blinds.

Study

8'0" x 6'6"
40% of the garage has been converted to accommodate this useful study space. Could be utilised as a home office, play room, games room, snug, gym etc.

WC

7'2" x 2'9"
WC and basin.



Landing

11'10" x 9'5"
With storage cupboard.

Bedroom One

12'0" x 10'9"
A substantially large bedroom. Newly carpeted. Bay window. Fitted wardrobes with sliding mirrored doors. Recently decorated in March 2025.

Ensuite

7'3" x 5'4"
Walk-in power shower. Vanity sink with storage. WC. LED mirror. Heated towel rail.

Bedroom Two

11'11" x 8'6"
A double bedroom with fitted wardrobe with sliding mirrored door.

Bedroom Three

9'10" x 8'6"
Currently utilised as a home office however previously a double bedroom. Sliding mirrored fitted wardrobe.

Bedroom Four

9'10" x 8'6"
With fitted wardrobe.

Bathroom

7'9" x 6'4"
A bathtub with mixer shower above. Sink and WC. Heated towel rail and separate radiator.

Garage

60% of the previous garage remaining to accommodate ample storage. Plumbing and tap.

Externally

To the front, a widened driveway to accommodate four vehicles, plus a lawned area. To the rear, a private and recently landscaped garden with gazebo and pergola. A shed with power.



General Notes

Composite front doors.
Oak doors throughout.
Decorated throughout in 2024.
Three year old, annually serviced boiler.
The loft is partially boarded with fitted loft ladder and a light.

AML Disclosure

Agents are required by law to conduct Anti-Money Laundering checks on all those buying a property. Stephenson Browne charge £49.99 plus VAT for an AML check per purchase transaction. This is a non-refundable fee. The charges cover the cost of obtaining relevant data, any manual checks that are required, and ongoing monitoring. This fee is payable in advance prior to the issuing of a memorandum of sale on the property you are seeking to buy.





Floor Plan

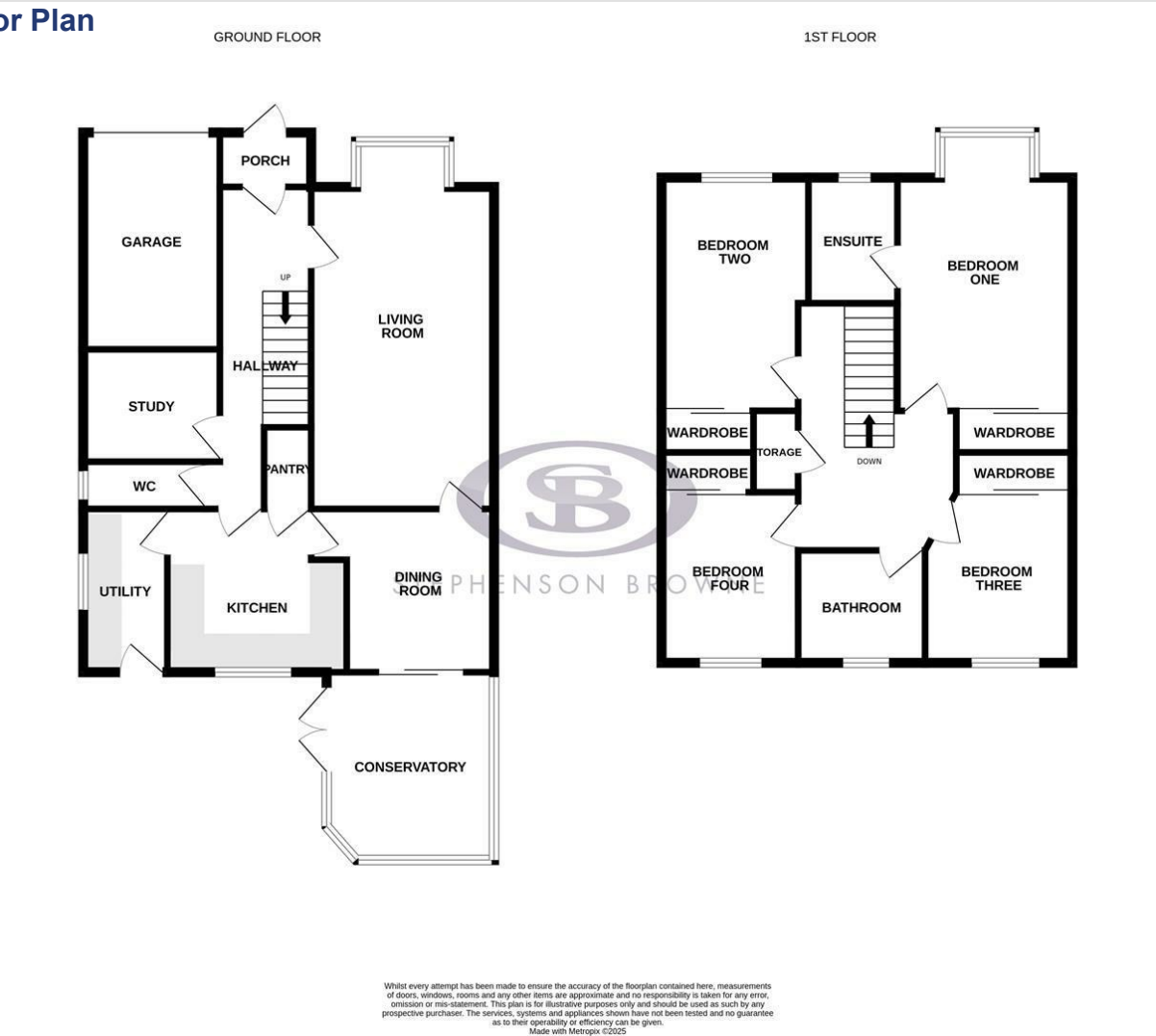

Area Map



Energy Efficiency Rating	
	Potential
Very energy efficient - lower running costs	
(92 plus) A	
(81-91) B	
(69-80) C	
(55-68) D	
(39-54) E	
(21-38) F	
(1-20) G	
Not energy efficient - higher running costs	
68	79
England & Wales	EU Directive 2002/91/EC

Environmental Impact (CO ₂) Rating	
	Potential
Very environmentally friendly - lower CO ₂ emissions	
(92 plus) A	
(81-91) B	
(69-80) C	
(55-68) D	
(39-54) E	
(21-38) F	
(1-20) G	
Not environmentally friendly - higher CO ₂ emissions	
England & Wales	EU Directive 2002/91/EC

Viewing

Please contact our Sandbach Office on 01270 763200 if you wish to arrange a viewing appointment for this property or require further information.

NOTICE: Stephenson Browne for themselves and for the vendors or lessors of this property whose agents they are give note that: (1) the particulars are set out as a general guideline only for the guidance of intending purchasers or lessees. and do not constitute, nor constitute part of, an offer or contract; (2) all descriptions, dimensions, references to condition and necessary permissions for use and occupation, and other details are given in good faith and are believed to be correct but any intending purchasers or tenants should not rely on them as statements or representations of fact but must satisfy themselves by inspection or otherwise as to be the correctness of each theme; (3) no person in the employment of Stephenson Browne has any authority to make representation or warranty in relation to this property; (4) fixtures and fittings are subject to a formal list supplied by the vendors solicitor. Referring to: Move with Us Ltd Average fee: £123.64