



**6 Oakwood Crescent**  
CW11 2LL  
**Offers Over £230,000**



3



1



1



D



STEPHENSON BROWNE



Nestled into a quiet cul-de-sac in the sought after locality of Sandbach Heath, this three bedroom bedroom true detached bungalow offers versatile accommodation and is offered for sale with the added benefit of no onwads chain.

The residence occupies a generous plot with a well maintained and established garden with established plant life and shrubbery, laid mostly to lawn with a patio immediately behind the home. Ample driveway parking for several cars, further to a detached single garage with up access from the front and rear.

Opening with an entrance hallway from the side aspect which provides access to all of the principal rooms, the home is laid out to comprise a modern fitted front aspect kitchen with, front aspect lounge, three bedrooms to the rear and middle of the home, and a modern three piece shower room.

No onwads vendor chain.





**Kitchen**

9'4" x 7'9"

**Living Room**

15'11" x 11'1" max

**Bedroom One**

12'1" x 8'11"

**Bedroom Two**

10'6" x 10'0"

**Bedroom Three**

6'11" x 6'5"

**Bathroom**

6'11" x 5'5"

**Garage**

19'8" x 8'1"





- True Bungalow
- Detached Residence
- Three Bedrooms
- Generous Front Lounge
- Modern Fitted Kitchen
- Three Piece Shower Room
- Driveway Parking and Detached Single Garage
- Generous Rear Garden
- Quiet Cul-De-Sac Location
- No Onwards Chain



Floor Plan

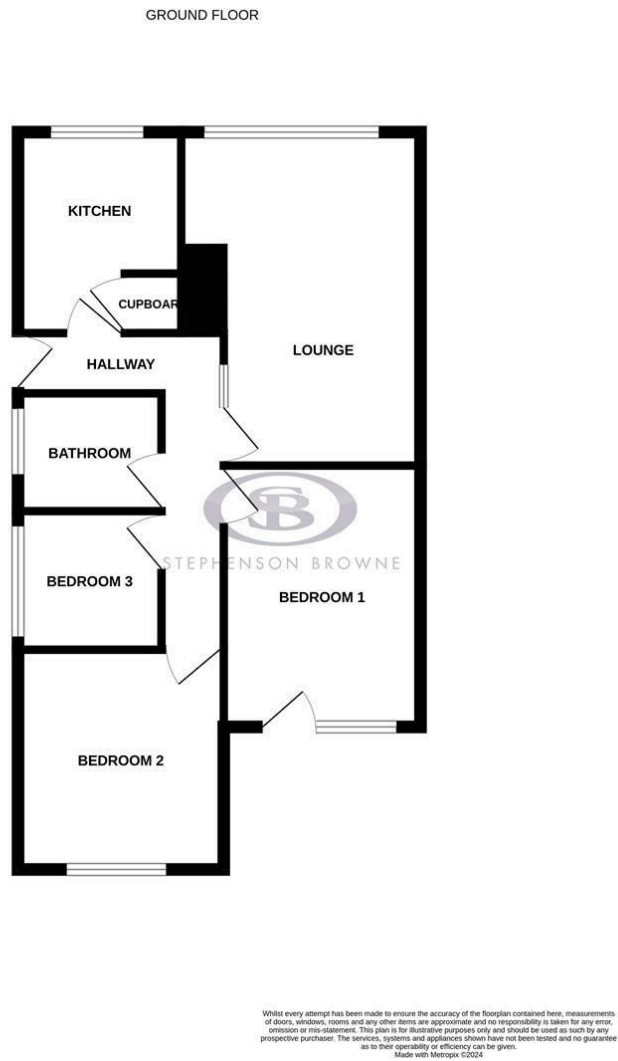

Area Map

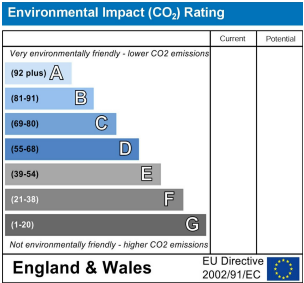
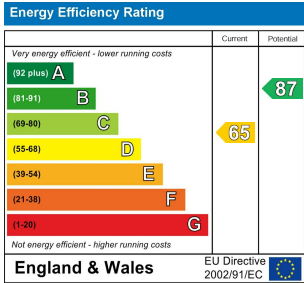

Viewing

Please contact our Sandbach office if you wish to arrange a viewing appointment or require further information.

NOTICE: Stephenson Browne for themselves and for the vendors or lessors of this property whose agents they are give note that: (1) the particulars are set out as a general guideline only for the guidance of intending purchasers or lessees. and do not constitute, nor constitute part of, an offer or contract; (2) all descriptions, dimensions, references to condition and necessary permissions for use and occupation, and other details are given in good faith and are believed to be correct but any intending purchasers or tenants should not rely on them as statements or representations of fact but must satisfy themselves by inspection or otherwise as to be the correctness of each theme; (3) no person in the employment of Stephenson Browne has any authority to make representation or warranty in relation to this property; (4) fixtures and fittings are subject to a formal list supplied by the vendors solicitor. Referring to: Move with Us Ltd Average fee: £123.64