



21 Elton Road

CW11 3NE

Guide Price £315,000



5



2



2



2



STEPHENSON BROWNE

Situated on a popular road this modernised 5 bedroom, detached family home provides excellent living space and room sizes of deceptive proportions.

Agents Remarks

This five bedroom, detached family home has so much to offer, and is found on a popular road close to Sandbach Town Centre and the Railway Station.

In brief the ground floor comprises; a stunning open plan dining/kitchen/snug, a good size lounge, and upon the first floor are FIVE bedrooms, with the master benefitting from an en-suite, and a family bathroom.

Outside, the rear garden has a patio and lawn area, and to the front is a tarmac and hardcore driveway for off-road parking.

This lovely home would suit a number of buyers, and is definitely not one to miss out on, call now to arrange your viewing!

Location

Sandbach is a thriving South Cheshire market town with historical monuments dating back to Anglo-Saxon times. Day to day essentials are easily accessible, with a range of speciality shops including bakers, grocers, delis, restaurants, boutiques, coffee shops, Waitrose, florists, fashion shops etc. On Thursdays a popular traditional Elizabethan street market extends into the Town Hall. There is also a Farmers Market every second Saturday of the month on the cobbled square.

Excellent travel and commuting links are provided by; quick access to the M6 Motorway junction 17, Sandbach railway station provides good links to Manchester, frequent trains from Crewe mainline railway station link Cheshire to London in 2 hours and Manchester International Airport is within a 40 minute drive. An ideal choice for the busy commuter. Local schools are held in high repute, many families move into the area with this in mind.

ACCOMMODATION

Entrance Hallway

Ceiling light point, radiator, stairs to the first floor, wood effect laminate flooring, UPVC double glazed front door and frosted window.

Lounge

15'2" x 12'10" (4.646m x 3.913m)

Two ceiling light points, two radiators, UPVC double glazed box bay window to the front elevation, TV point, wood effect laminate flooring, two ceiling light points.

Dining Kitchen

22'10" x 8'8" (6.980m x 2.643m)

A good range of white gloss wall and base units with wood effect laminate work-surface over, inset 1.5 bowl stainless steel sink with mixer tap and drainer, integrated washing machine, integrated double oven, four ring gas hob with extractor fan over, integrated fridge/freezer, two ceiling light points, UPVC double glazed window to the rear elevation, UPVC double glazed doors leading out to the garden, two radiators, wood effect laminate flooring. Open archway into:

Snug

7'11" x 8'9" (2.421m x 2.685m)

UPVC double glazed window to the side elevation and double doors leading out to the garden, ceiling light point, radiator, wood effect laminate flooring.





FIRST FLOOR

Landing

Ceiling light point, access to the loft space which is boarded with power, oak doors to all rooms, smoke alarm, storage cupboard.

Bedroom One

9'8" x 12'4" (2.954m x 3.770m)

UPVC double glazed window to the front elevation, two ceiling light points, radiator.

En-Suite

2'11" x 5'5" (0.893m x 1.653m)

Low level WC, wall hung wash hand basin, fully tiled shower enclosure with mixer shower over, ceiling light point, shaver point, UPVC double glazed frosted window to the side elevation, chrome ladder style radiator.

Bedroom Two

10'2" x 8'0" (3.115m x 2.454m)

UPVC double glazed window to the front elevation, ceiling light point, radiator.

Bedroom Three

8'6" x 9'2" (2.594m x 2.802m)

UPVC double glazed window to the rear elevation, ceiling light point, radiator.

Bedroom Four

8'0" x 8'6" (2.463m x 2.601m)

UPVC double glazed window to the rear elevation, ceiling light point, radiator.

Bedroom Five

6'1" x 7'1" (1.874m x 2.183m)

UPVC double glazed window to the front elevation, ceiling light point, radiator.

Bathroom

6'2" x 5'7" (1.891m x 1.722m)

Low level WC, pedestal wash hand basin, panel bath with mixer shower over, partly tiled walls, tile effect vinyl flooring, shaver point, chrome ladder style radiator, ceiling light point, UPVC double glazed frosted window to the side elevation.

Outside

Front

Tarmac driveway, hardcore driveway, lawn area, shrubbery and hedge boundaries.

Rear

Patio area. laid to lawn, shrubbery and fence and hedge boundaries.

Garage

Up and over door, power and lighting.

Floor Plan

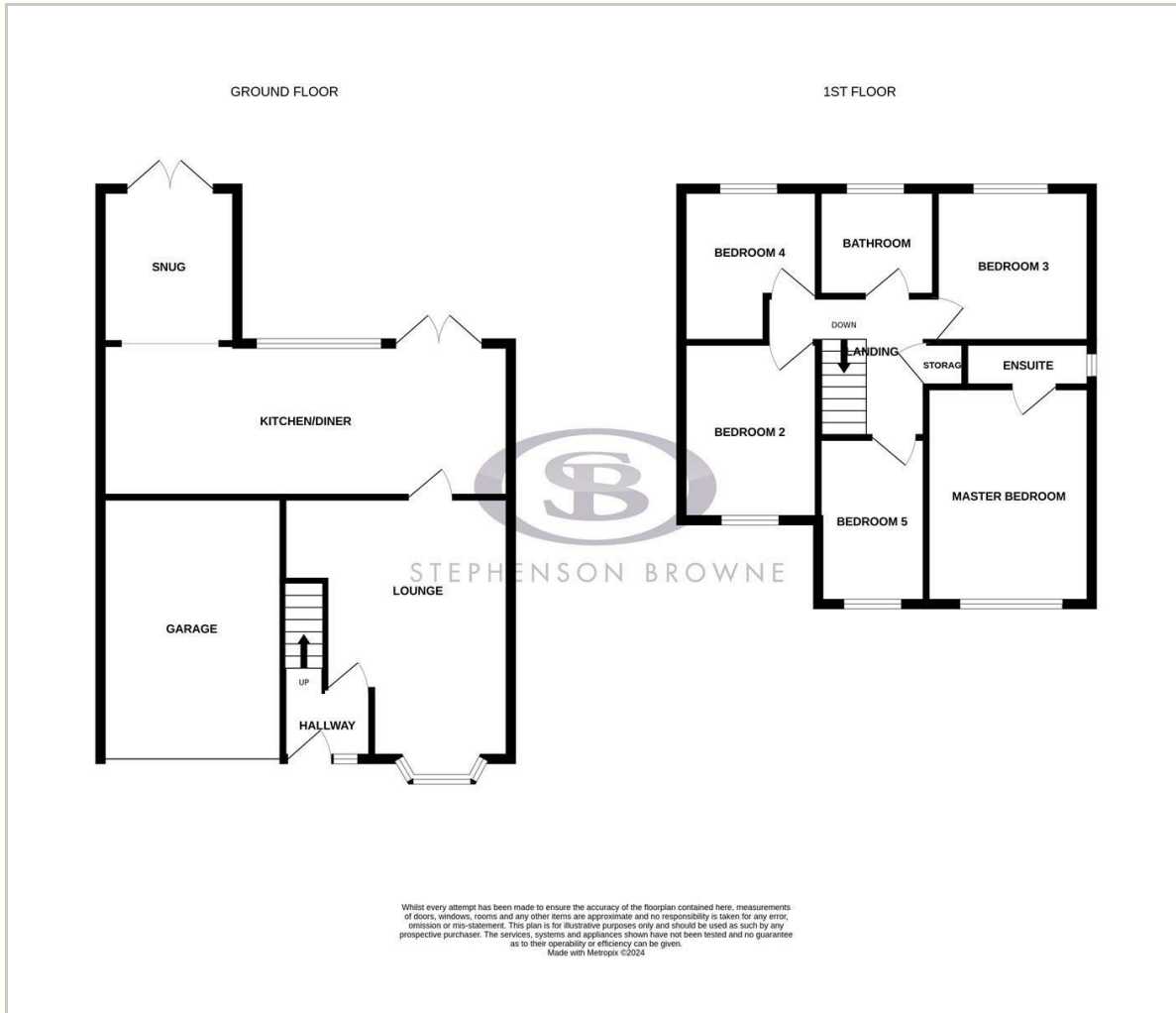

Viewing

Please contact our Sandbach Office on 01270 763200 if you wish to arrange a viewing appointment for this property or require further information.

Area Map

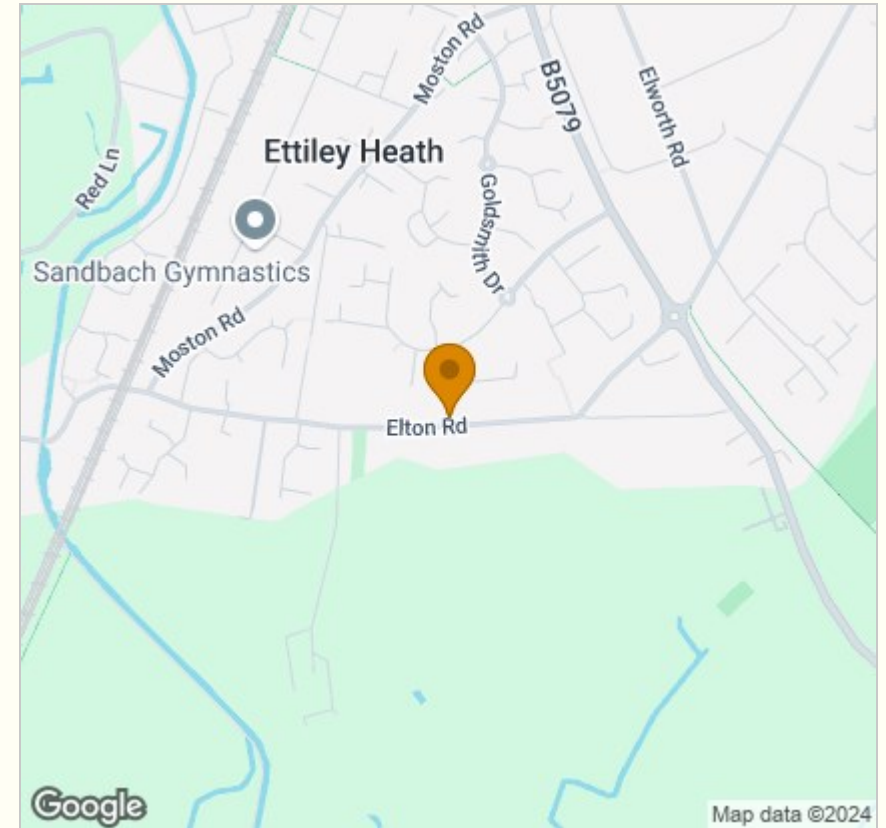

Energy Efficiency Graph

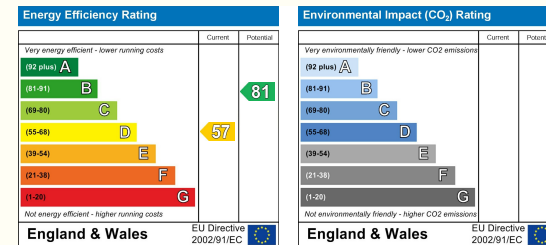

NOTICE: Stephenson Browne for themselves and for the vendors or lessors of this property whose agents they are give notice that: (1) the particulars are set out as a general guideline only for the guidance of intending purchasers or lessees, and do not constitute, nor constitute part of, an offer or contract; (2) all descriptions, dimensions, references to condition and necessary permissions for use and occupation, and other details are given in good faith and are believed to be correct but any intending purchasers or tenants should not rely on them as statements or representations of fact but must satisfy themselves by inspection or otherwise as to the correctness of each theme; (3) no person in the employment of Stephenson Browne has any authority to make representation or warranty whatever in relation to this property. (4) fixtures & fittings are subject to a formal list supplied by the vendors solicitors. **Referring to:** Move with Us Ltd **Average Fee:** £123.64

38 High Street, Sandbach, CW11 1AN

T: 01270 763200 E: sandbach@stephensonbrowne.co.uk | www.stephensonbrowne.co.uk