



Rathgar Close, Whitebushes Estate, Redhill, Surrey RH1 5LS

MARTIN&CO

- One double bedroom
- Ground floor apartment
- Well presented throughout
- Living room/diner
- Double glazed windows
- Gas central heating
- Front and rear communal gardens
- Walking distance of Earlswood Station
- EPC Rating C
- NO CHAIN

An immaculate one double bedroom ground floor flat offering spacious living accommodation, conveniently located within walking distance of East Surrey Hospital and Earlswood Railway Station. Decorated in neutral tones and flooded with natural light. The property comprises; entrance hall with entryphone system and ample storage space, good sized lounge/dining room with large front aspect window and additional walk-in storage cupboard, separate fully equipped kitchen. The master bedroom is a large double and adjacent to the bathroom which has white suite and shower over bath. This is a must see property - book your viewing today to avoid disappointment.

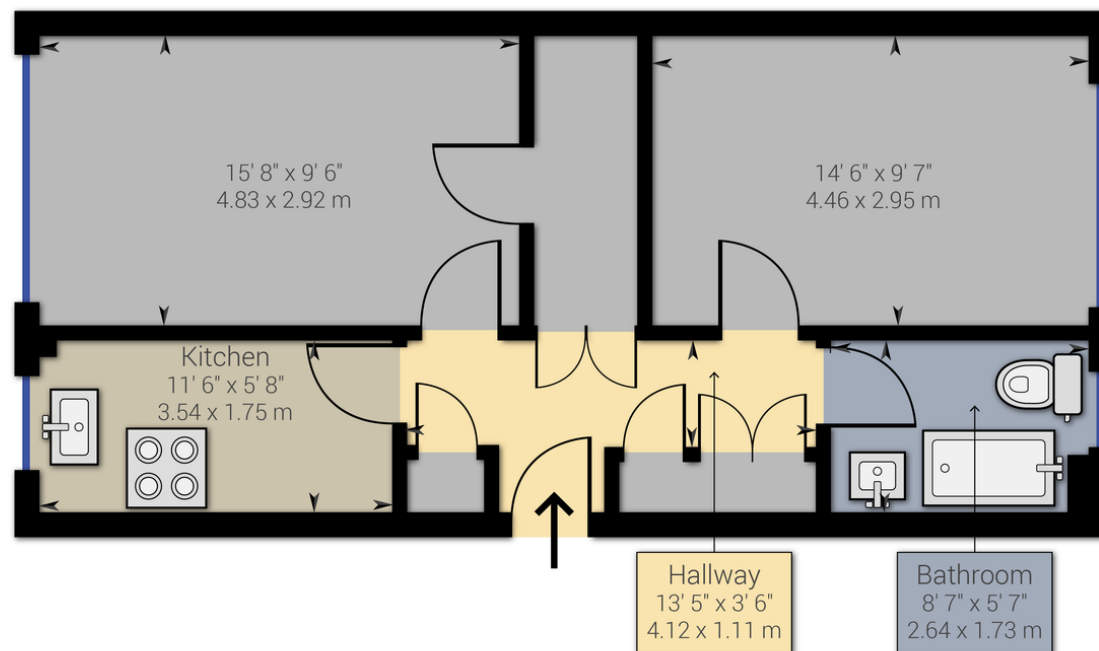

Approximate net internal area: 525.07 ft² / 48.78 m²
While every attempt has been made to ensure accuracy, all measurements are approximate, not to scale. This floor plan is for illustrative purpose only and should be used as such by any prospective tenant or purchaser.

Powered by Giraffe360

Martin & Co Crawley

3 Brittingham House • Orchard Street • Crawley • RH11 7AE
T: 01293 735000 • E: crawley@martinco.com

01293 735000

<http://www.martinco.com>



Accuracy: References to the Tenure of a Property are based on information supplied by the Seller. The Agent has not had sight of the title documents. A Buyer is advised to obtain verification from their Solicitor. Items shown in photographs including but not limited to carpets, fixtures and fittings are not included unless specifically mentioned within the sales particulars. They may however be available by separate negotiation. Buyers must check the availability of any property and make an appointment to view before embarking on any journey to see a property. No person in the employment of the agent has any authority to make any representation about the property, and accordingly any information given is entirely without responsibility on the part of the agents, sellers(s) or lessors(s). Any property particulars are not an offer or contract, nor form part of one. **Sonic / Laser Tape:** Measurements taken using a sonic / laser tape measure may be subject to a small margin of error. **All Measurements:** All Measurements are Approximate. **Services Not tested:** The Agent has not tested any apparatus, equipment, fixtures and fittings or services and so cannot verify that they are in working order or fit for the purpose. A Buyer is advised to obtain verification from their Solicitor or Surveyor.