



2



1



1



C

DavidJames
the estate agent

Kingsthorpe Close, Nottingham, NG3 3AZ

Guide Price £190,000

About This Property

This is a fantastic opportunity to purchase a well-presented two bedroom semi-detached townhouse available with no upward chain. Ideal for first-time buyers or landlords, this property offers modern living in a convenient location.

The ground floor features a contemporary kitchen with sleek grey gloss units, wood effect flooring and integrated appliances including an induction hob, electric oven, and stainless steel extractor hood. The stylish downstairs WC includes a modern pedestal sink, sleek WC and contemporary geometric wall detailing.

Upstairs, the first floor offers two good-sized double bedrooms. The front bedroom benefits from large windows that let in plenty of natural light whilst the second bedroom offers pleasant views of the rear garden. The modern bathroom features a white suite with a bath and overhead shower, stylish tile detailing, chrome fittings and a frosted window for natural light.

The rear garden can be easily accessed through the lounge patio doors is low maintenance and hard landscaped with a good sized initial slabbed patio area leading to a raised decking and a decorative white stone border with fencing for privacy and security.

To the side of the property is a private driveway and gated access to the rear garden.



- Well-presented semi-detached townhouse
- Ideal for first-time buyers or landlords
- Sold with no upward chain
- Modern kitchen with integrated appliances
- Lounge with patio doors leading to rear garden
- Contemporary ground floor WC
- Two double bedrooms with plenty of natural light
- Modern bathroom/WC with stylish detailing
- Landscaped rear garden with patio and decking
- Private driveway provides off road parking



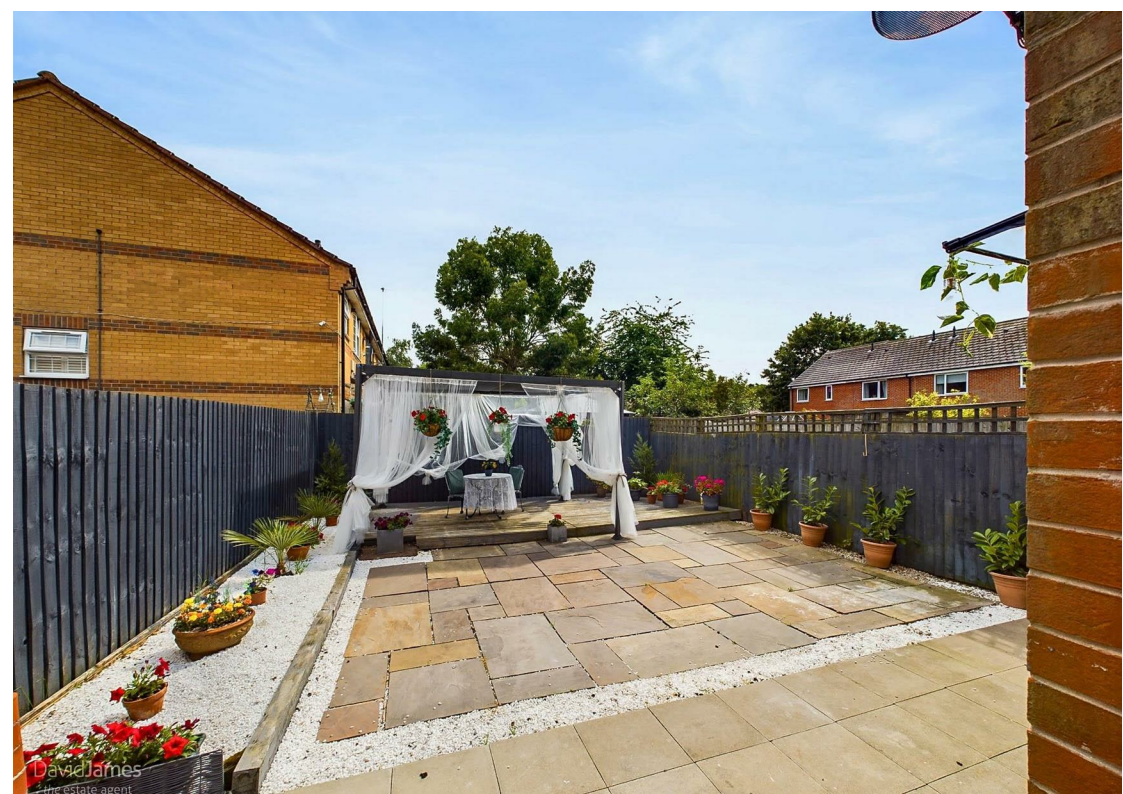



Entrance Hall
1.10 x 1.08 m
4'0" x 3'6"

WC
1.54 x 0.87 m
5'0" x 2'10"

Floor 0

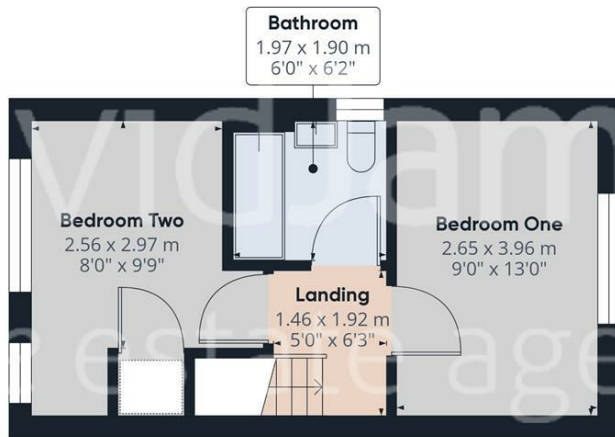

Floor 1



Approximate total area⁽¹⁾

55.29 m²
595.14 ft²

Reduced headroom

0.1 m²
1.08 ft²

(1) Excluding balconies and terraces

Reduced headroom
(below 1.5m/4.92ft)

While every attempt has been made to ensure accuracy, all measurements are approximate, not to scale. This floor plan is for illustrative purposes only.

GIRAFFE360



These particulars are produced in good faith, are set out as a general guide only and do not constitute any part of a contract. No person in the employment of David James Estate Agents Ltd has any authority to make any representation whatsoever in relation to the property. All services, together with electrical fittings or fitted appliances have NOT been tested. All the measurements given in the details are approximate. Floor plans are for illustrative purposes only and are not drawn to scale. The position and size of doors, windows, appliances and other features are approximate only. The photographs of this property have been taken with a 10mm wide-angle lens. No responsibility can be accepted for any loss or expense incurred in viewing. If you have a property to sell you may wish to take advantage of our free valuation service. David James Estate Agents have established professional relationships with third-party suppliers for the provision of services to Clients. As remuneration for this professional relationship, the agent receives referral commission from the third-party company. David James Estate Agents receives the following commission from each third party supplier on a per referral basis: W A Barnes Ltd: £60 including VAT. All Moves UK Ltd: 18% including VAT of the invoice total (£107 including VAT average). MoveWithUs Limited: £188 including VAT (average).

Council Tax Band: A
Nottingham City Council
Freehold

DavidJames
the estate agent

David James Estate Agents
45b Plains Road, Nottingham, NG3 5JU
t: 0115 962 4213 e: mapperley@david-james.com

