



DavidJames
the estate agent

Clifton Grove, Gedling, Nottingham, NG4 4DQ

Guide Price £180,000

About This Property

Welcome to this semi-detached home which provides an ideal opportunity for a first-time buyer eager to make their first step onto the property ladder! Just a short walk from frequent bus services to Nottingham City Centre, the property also sits within easy reach of Gedling, Mapperley and Carlton's variety of amenities!

Upon entering, you are greeted by a hallway equipped with the panel for the burglar alarm system, providing peace of mind. The heart of the home is a bright and spacious lounge, featuring French doors that open to the rear garden. This outdoor space, enclosed and mainly lawned, includes an initial patio area perfect for enjoying the stunning views over the local area.

The modern fitted kitchen boasts an integrated oven, hob, and extractor. Additionally, there's ample room for both a freestanding washing machine and an undercounter fridge.

Upstairs, the accommodation comprises two well-proportioned bedrooms, with the main bedroom benefiting from an in-built overstairs cupboard. A contemporary bathroom, equipped with a three-piece white suite and the addition of a towel radiator, completes the first-floor layout.

Additional perks include UPVC double glazing and a new storage heater system installed in 2022 which benefits from the remaining warranty.

For those with vehicles, off-street parking for 2 cars is available at the front, along with access to a useful garage featuring both power and lighting.



- Semi-detached house
- Perfect for a first-time buyer
- Cul-de-sac location in the ever-popular Gedling
- Entrance hall with burglar alarm system
- Bright and spacious lounge with French doors
- Modern kitchen with integrated cooking appliances
- Two first floor bedrooms
- Modern bathroom with white suite and a towel radiator
- Lawned rear garden with a feature patio area and fantastic views
- Parking and garage to the front



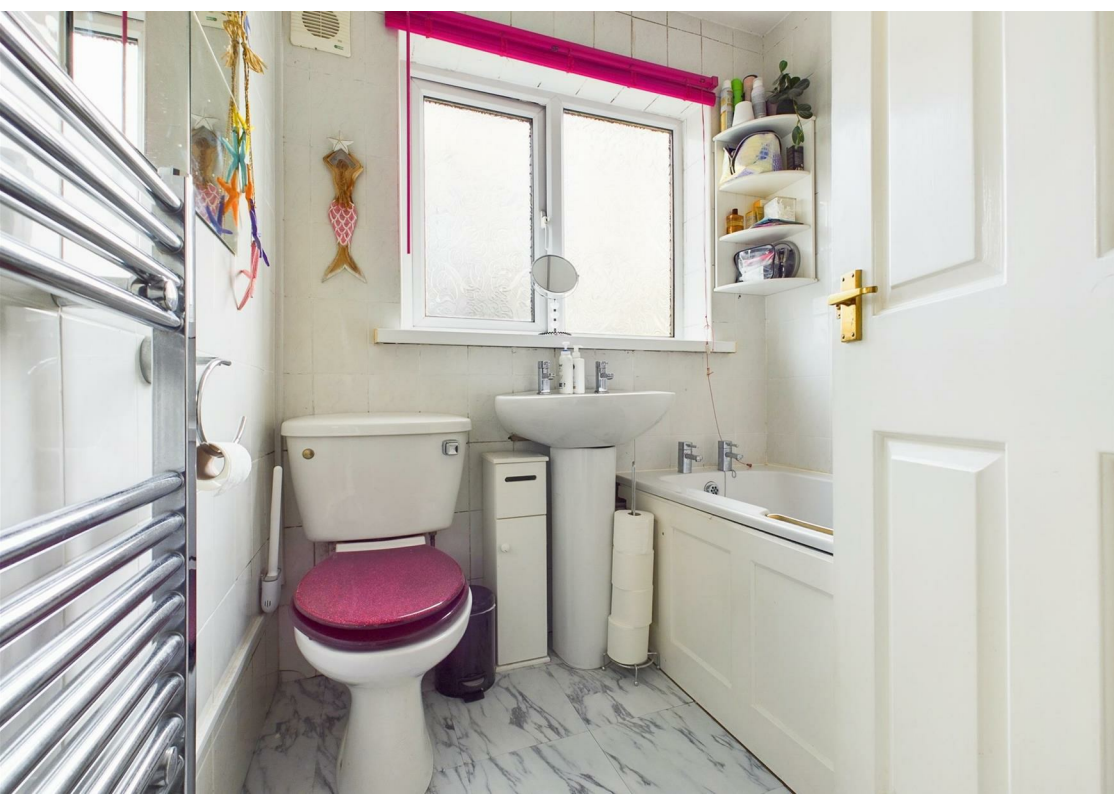

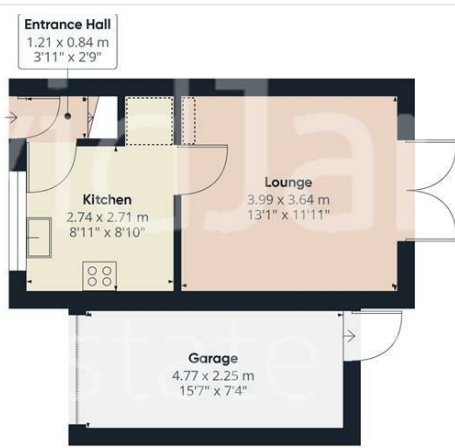

Floor 0



Floor 1



Approximate total area*
57.73 m²
621.43 ft²

Reduced headroom
1.11 m²
11.96 ft²

(†) Excluding balconies and terraces

Reduced headroom
(below 1.5m/4.92ft)

While every attempt has been made to ensure accuracy, all measurements are approximate, not to scale. This floor plan is for illustrative purposes only.

GIRAFFE360

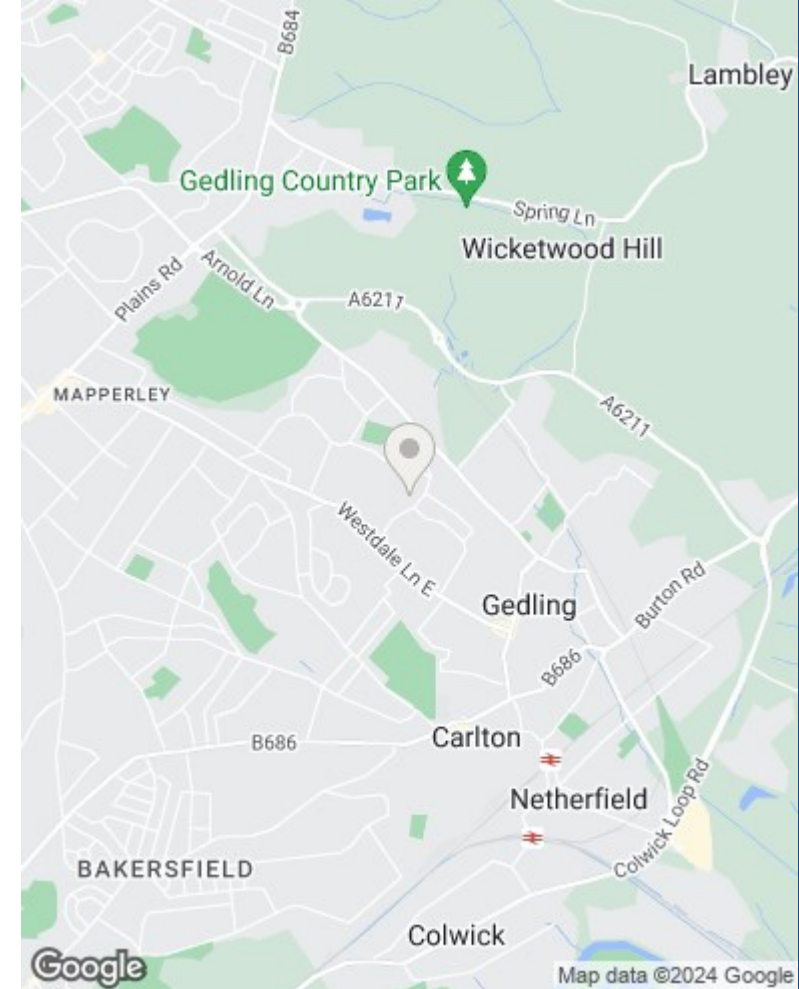

These particulars are produced in good faith, are set out as a general guide only and do not constitute any part of a contract. No person in the employment of David James Estate Agents Ltd has any authority to make any representation whatsoever in relation to the property. All services, together with electrical fittings or fitted appliances have NOT been tested. All the measurements given in the details are approximate. Floor plans are for illustrative purposes only and are not drawn to scale. The position and size of doors, windows, appliances and other features are approximate only. The photographs of this property have been taken with a 10mm wide-angle lens. No responsibility can be accepted for any loss or expense incurred in viewing. If you have a property to sell you may wish to take advantage of our free valuation service. David James Estate Agents have established professional relationships with third-party suppliers for the provision of services to Clients. As remuneration for this professional relationship, the agent receives referral commission from the third-party company. David James Estate Agents receives the following commission from each third party supplier on a per referral basis: W A Barnes Ltd: £60 including VAT. All Moves UK Ltd: 18% including VAT of the invoice total (£107 including VAT average). MoveWithUs Limited: £188 including VAT (average).

Council Tax Band:

Freehold

DavidJames
the estate agent

David James Estate Agents
45b Plains Road, Nottingham, NG3 5JU
t: 0115 962 4213 e: mapperley@david-james.com

