



 2

 1

 1

 D

DavidJames
the estate agent

Westdale Lane, Mapperley, Nottingham, NG3 6DH

Guide Price £200,000

About This Property

This semi-detached house is situated in the appealing area of Mapperley with the property boasting two generously sized double bedrooms. As you enter, the entrance hall has laminate flooring and leads to the lounge/dining room. The good sized kitchen has a range of units and an understairs storage cupboard. A bathroom features a white suite with a mains shower. The home benefits from gas central heating and UPVC double glazing. Outside, the property has a sizable rear garden, featuring a lawned area and borders ready for the gardening enthusiast to make their mark. This home is available without the complication of an upward chain and is perfectly located within walking distance of Mapperley's vibrant shops and restaurants. Additionally, it is positioned on a frequent bus route, offering excellent transport links.



- Period style semi detached house
- Two double bedrooms
- Entrance hall with laminate flooring
- Lounge/dining room with fireplace
- Good sized kitchen with a range of base and eye level units and an understairs storage cupboard
- Bathroom/Wc with white suite and mains shower
- Gas central heating, UPVC double glazing
- Good sized rear garden with lawned area and borders
- In walking distance of Mapperley's shops and restaurants and positioned on a frequent bus route
- Sold with no upward chain





Hallway
3.62 x 1.02 m
11'10" x 3'4"

Floor 0

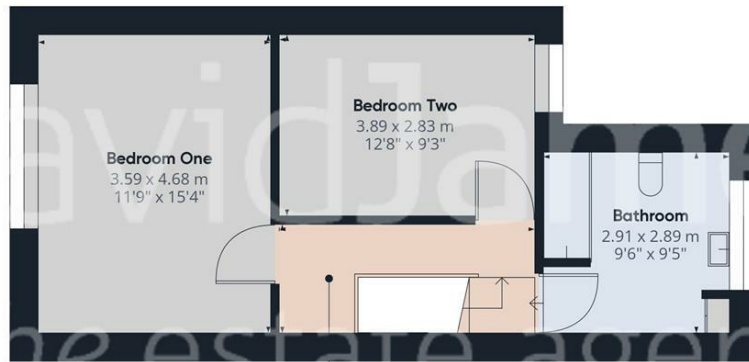

Landing
3.91 x 1.69 m
12'10" x 5'6"

Floor 1



Approximate total area*
88.85 m²
956.35 ft²

(*) Excluding balconies and terraces

While every attempt has been made to ensure accuracy, all measurements are approximate, not to scale. This floor plan is for illustrative purposes only.

GIRAFFE360

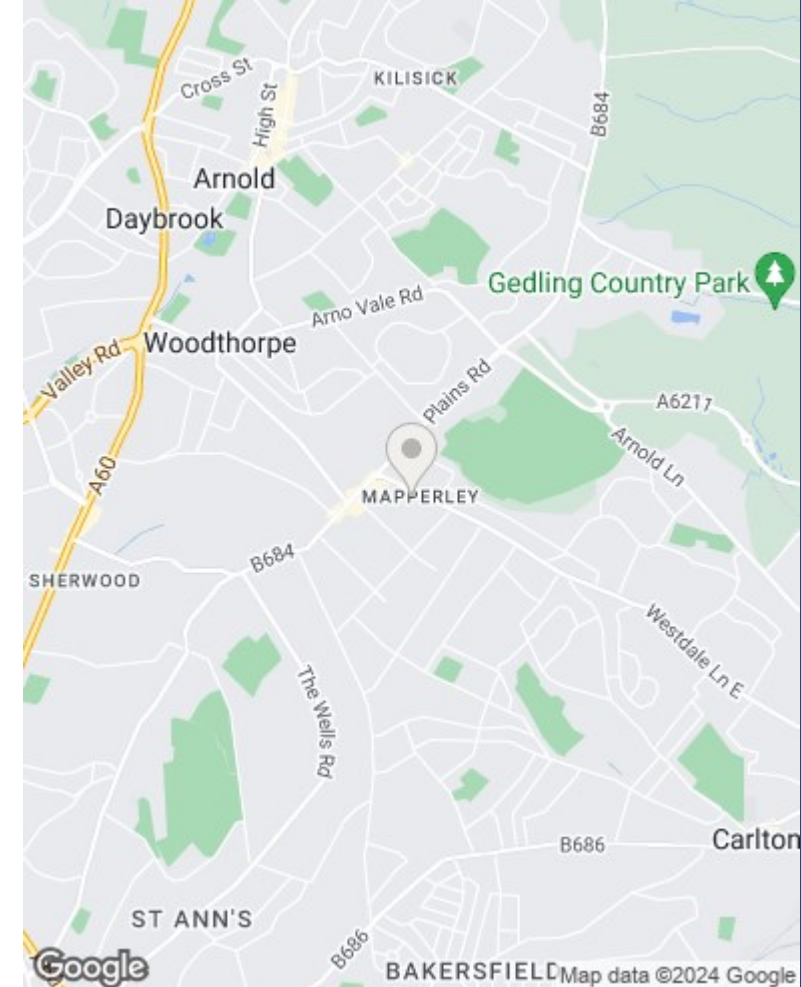

These particulars are produced in good faith, are set out as a general guide only and do not constitute any part of a contract. No person in the employment of David James Estate Agents Ltd has any authority to make any representation whatsoever in relation to the property. All services, together with electrical fittings or fitted appliances have NOT been tested. All the measurements given in the details are approximate. Floor plans are for illustrative purposes only and are not drawn to scale. The position and size of doors, windows, appliances and other features are approximate only. The photographs of this property have been taken with a 10mm wide-angle lens. No responsibility can be accepted for any loss or expense incurred in viewing. If you have a property to sell you may wish to take advantage of our free valuation service. David James Estate Agents have established professional relationships with third-party suppliers for the provision of services to Clients. As remuneration for this professional relationship, the agent receives referral commission from the third-party company. David James Estate Agents receives the following commission from each third party supplier on a per referral basis: W A Barnes Ltd: £60 including VAT. All Moves UK Ltd: 18% including VAT of the invoice total (£107 including VAT average). MoveWithUs Limited: £188 including VAT (average).

Council Tax Band: C
Gedling Borough Council
Freehold

DavidJames
the estate agent

David James Estate Agents
45b Plains Road, Nottingham, NG3 5JU
t: 0115 962 4213 e: mapperley@david-james.com

