



 3

 2

 1

 E

DavidJames
the estate agent

Coningsby Road, Woodthorpe, Nottingham, NG5 4LG

Guide Price £375,000

About This Property

GUIDE PRICE £375,000 - £390,000. Discover a world of opportunity with this traditional detached family home, poised on a corner plot in the highly desirable Woodthorpe! A perfect canvas for those looking to infuse a property with their personal touch, this residence has lots of character and is offered to the market with no upward chain!

The location is exceptional, nestled close to both Mapperley and Arnold's amenities, with a variety of sought-after schools within walking distance. Convenience is further enhanced by nearby bus services to Nottingham City Centre.

Inside, the home boasts an impressive entrance hall complete with a handy cloakroom/store, leading into a spacious lounge highlighted by a charming bow window. A separate dining room provides versatility and views over the garden, while the fitted kitchen, complemented by a rear lobby/utility room and a downstairs WC, adds practicality.

Upstairs, three well-proportioned bedrooms and a bathroom with a three-piece suite, plus a separate WC, accommodate family living.

Outside, the low-maintenance rear garden, featuring a decked patio and two timber sheds, provides space for relaxing or entertaining. The addition of a garage and driveway accessed via the side of the house completes this appealing property package!

- Traditional detached family home
- Offered to the market with no upward chain
- Lots of potential
- Fantastic corner-plot location in Woodthorpe
- Impressive entrance hall with useful cloaks/store
- Spacious lounge with separate dining room
- Kitchen with adjoining rear lobby/utility and downstairs WC
- Three bedrooms
- Bathroom with three-piece suite and separate WC
- Low-maintenance rear garden, driveway and garage





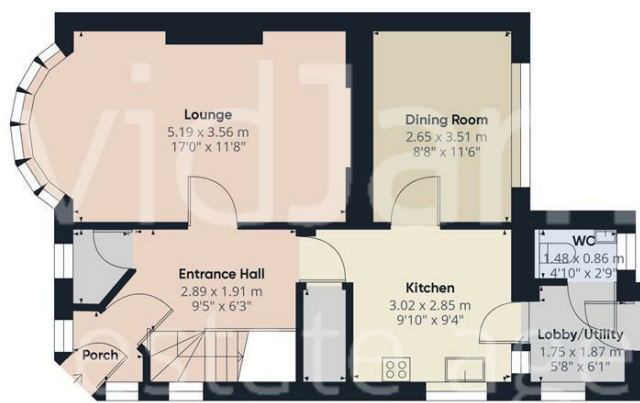

Floor 0

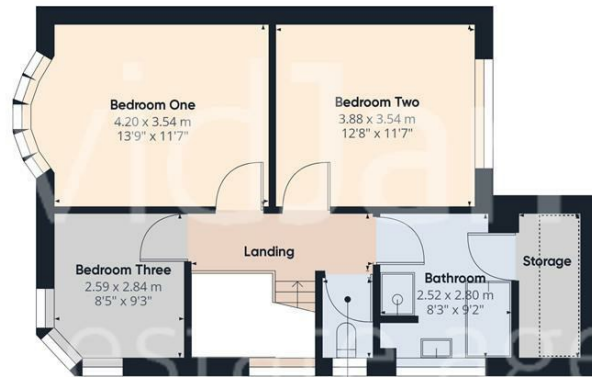

Floor 1



Approximate total area*

112.29 m²
1208.69 ft²

Reduced headroom

2.25 m²
24.26 ft²

Excluding balconies and terraces

Reduced headroom (below 1.5m/4.92ft)

While every attempt has been made to ensure accuracy, all measurements are approximate, not to scale. This floor plan is for illustrative purposes only.

GIRAFFE360

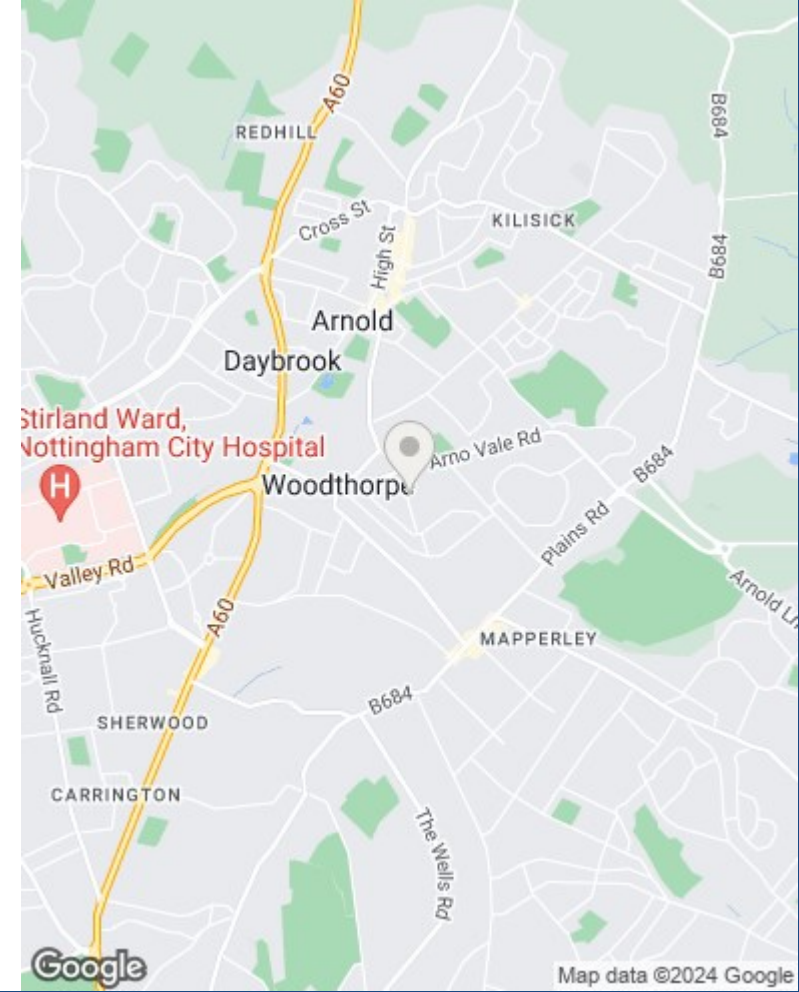

These particulars are produced in good faith, are set out as a general guide only and do not constitute any part of a contract. No person in the employment of David James Estate Agents Ltd has any authority to make any representation whatsoever in relation to the property. All services, together with electrical fittings or fitted appliances have NOT been tested. All the measurements given in the details are approximate. Floor plans are for illustrative purposes only and are not drawn to scale. The position and size of doors, windows, appliances and other features are approximate only. The photographs of this property have been taken with a 10mm wide-angle lens. No responsibility can be accepted for any loss or expense incurred in viewing. If you have a property to sell you may wish to take advantage of our free valuation service. David James Estate Agents have established professional relationships with third-party suppliers for the provision of services to Clients. As remuneration for this professional relationship, the agent receives referral commission from the third-party company. David James Estate Agents receives the following commission from each third party supplier on a per referral basis: W A Barnes Ltd: £60 including VAT. All Moves UK Ltd: 18% including VAT of the invoice total (£107 including VAT average). MoveWithUs Limited: £188 including VAT (average).

Council Tax Band: D
Gedling Borough Council
Freehold

DavidJames
the estate agent

David James Estate Agents
45b Plains Road, Nottingham, NG3 5JU
t: 0115 962 4213 e: mapperley@david-james.com

