



WILMINGTON HOUSE CHURCH WALK WILMINGTON  
DA2 7EX  
£295,000 | Leasehold



Park Estates are delighted to offer onto the market this well presented two double bedroom first floor apartment, which forms part of a sought after gated development. Located in the popular village of Wilmington, this luxury apartment offers spacious living accommodation comprising of entrance hall, two double bedrooms, bathroom and an open plan fitted kitchen / living area. Benefits to note include sash windows, gas central heating, entry phone, security alarm system, secure allocated parking and communal gardens. Viewing really is a must to fully appreciate this excellent apartment.

Local Authority: Dartford

Council Tax Band: C

Energy Efficiency Rating			
Score	Energy rating	Current	Potential
92+	A		
81-91	B		
69-80	C	80   C	81   B
55-68	D		
39-54	E		
21-38	F		
1-20	G		



**01322 553322**

60-62 High Street, Bexley, Kent DA5 1AH

bexley@parkestates.co.uk

www.parkestates.co.uk

## Wilmington House, DA2

Approximate Gross Internal Area = 62.7 sq m / 675 sq ft

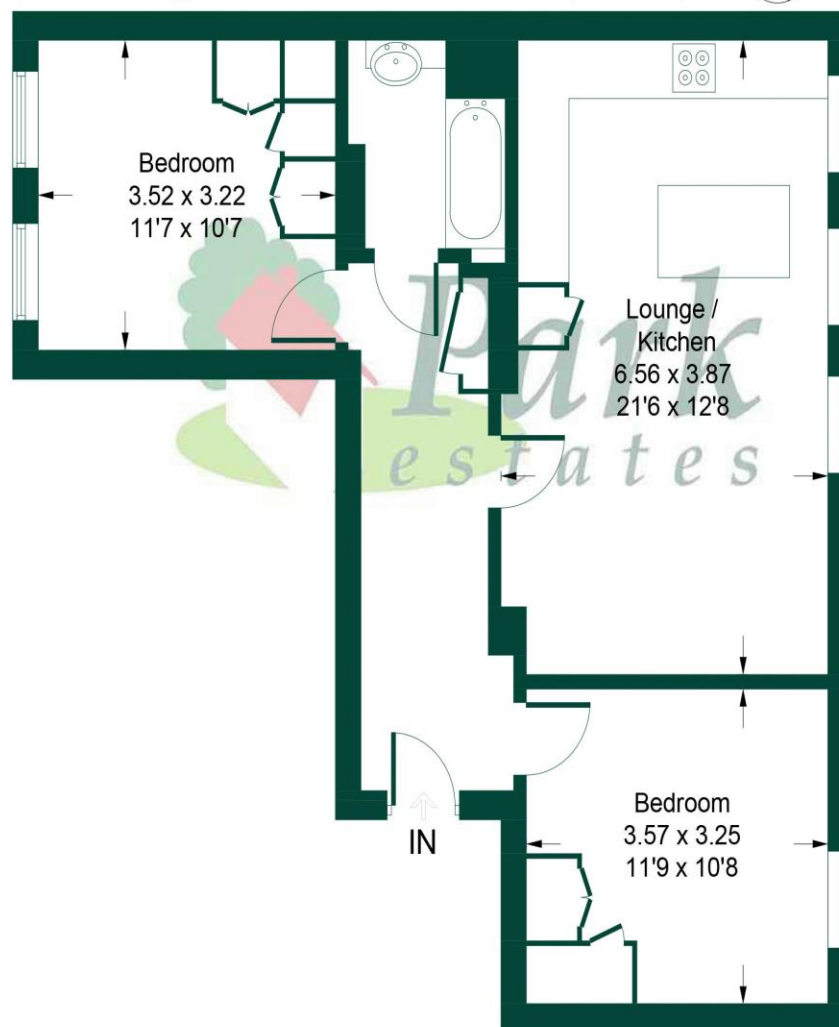

This plan is for layout guidance only. Not drawn to scale unless stated. Windows and door openings are approximate. Whilst every care is taken in the preparation of this plan, please check all dimensions, shapes and compass bearings before making any decisions reliant upon them. Produced by Planpix on behalf of Park Estates (ID738850)

Every care has been taken with the preparation of details, but accuracy is in no way guaranteed. These particulars do not constitute a contract and are issued and accepted on the express understanding that all negotiations will be conducted through Park Estates. The seller does not make or give, nor do we or our employees have any authority to give a representation or warranty in relation to the property. Please contact this office before viewing the property. If there is any point which is of particular importance to you, we will be pleased to check the information for you and confirm that the property remains available. This is particularly important if you are contemplating travelling some distance to view the property. We would strongly recommend that all the information that we provide about the property is verified by yourself on inspection and also by your conveyancer, especially where statements have been made by us to the effect that the information provided by us has not been verified.