

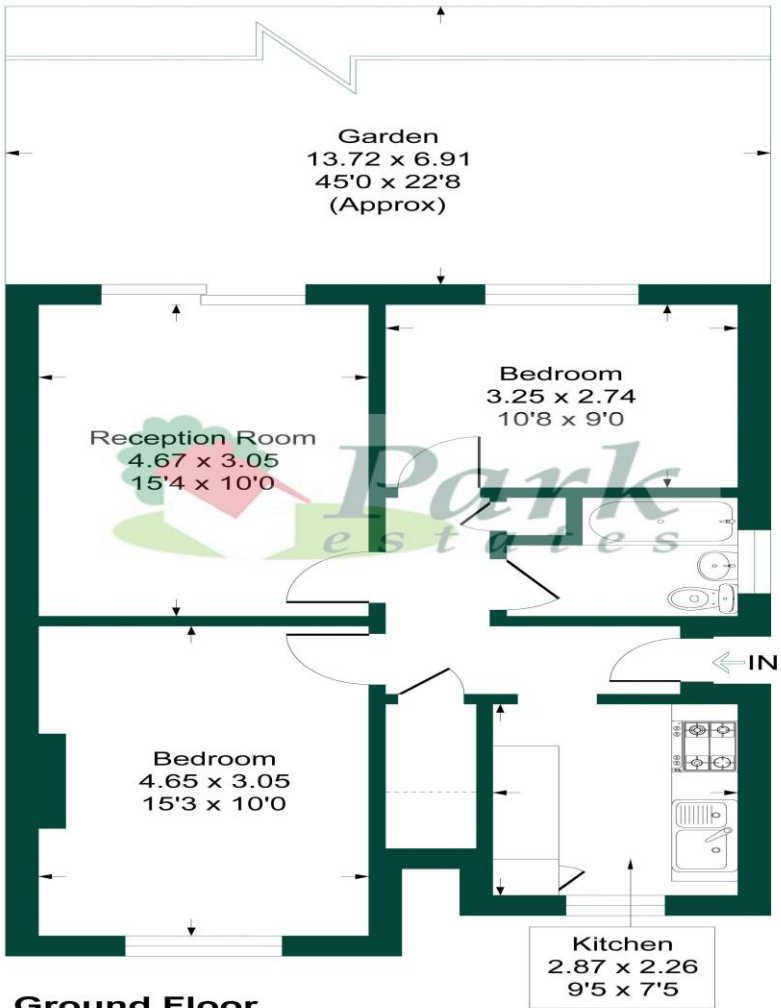

Woodside Lane, DA5

Approximate Gross Internal Area = 57.5 sq m / 619 sq ft



This plan is for layout guidance only. Not drawn to scale unless stated. Windows and door openings are approximate. Whilst every care is taken in the preparation of this plan, please check all dimensions, shapes and compass bearings before making any decisions reliant upon them. Produced By Planpix



Score	Energy rating	Current	Potential
92+	A		
81-91	B		
69-80	C	69 C	77 C
55-68	D		
39-54	E		
21-38	F		
1-20	G		



**\*CASH BUYERS ONLY\*** Spacious two bedroom ground floor maisonette, offered onto the market with a short lease. This spacious property comprises of entrance hall, two double bedrooms, kitchen, bathroom and one reception room with direct access onto a well presented private garden. Additional benefits to note include double glazing, gas central heating, off street parking, air conditioning, no chain and being located conveniently for local shops, transport links and schools. Viewing is recommended.

Lease: 65 years remaining  
Local Authority: Bexley  
Council Tax Band: C

