

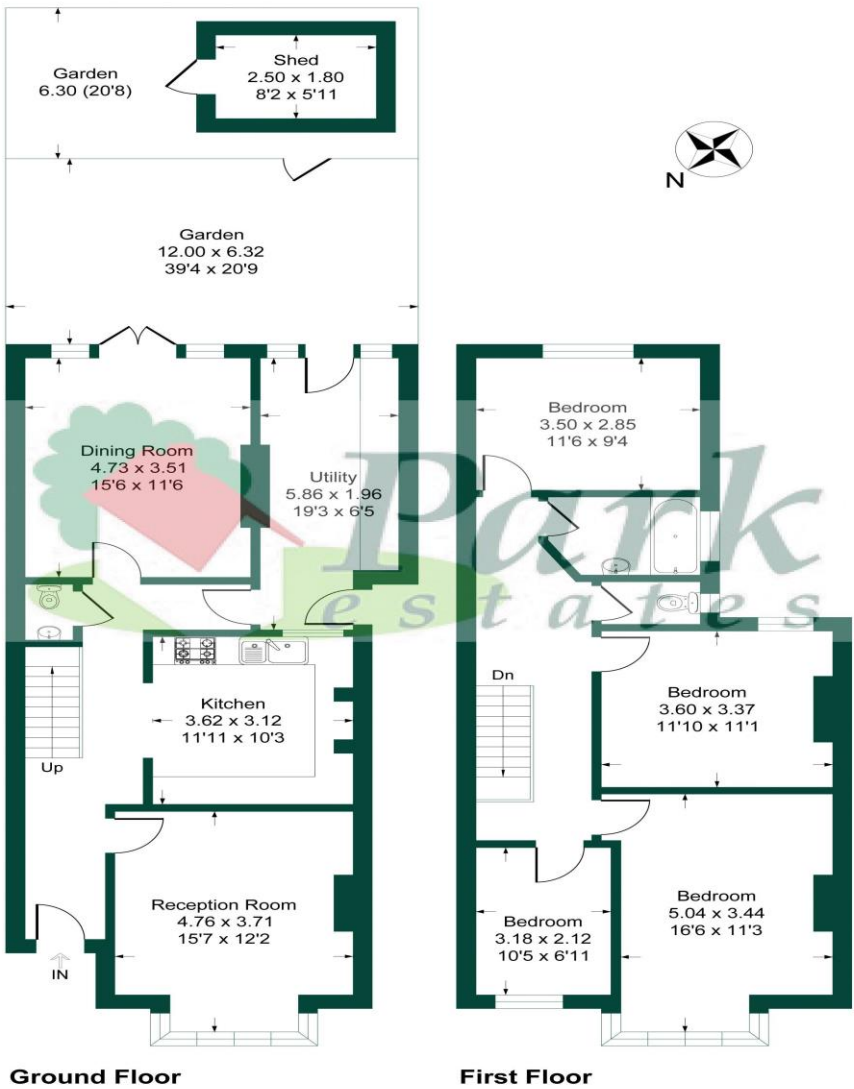

Heath Close Road, DA1

Approximate Gross Internal Area = 139.1 sq m / 1498 sq ft
Shed = 4.5 sq m / 48 sq ft
Total = 143.6 sq m / 1546 sq ft



Ground Floor

First Floor

This plan is for layout guidance only. Not drawn to scale unless stated. Windows and door openings are approximate. Whilst every care is taken in the preparation of this plan, please check all dimensions, shapes and compass bearings before making any decisions reliant upon them. Produced By Planpix



Score	Energy rating	Current	Potential
92+	A		
81-91	B		
69-80	C		
55-68	D	62 D	84 B
39-54	E		
21-38	F		
1-20	G		

Situated in the lovely Dartford Heath location, close to all popular schools and transport links, is this very well presented beautiful period 4 bedroom end of terrace family home. With accommodation comprising of entrance hall, downstairs WC, living room, fitted kitchen, large utility room and a dining room with French doors to a secluded landscaped garden with a secret door to a further garden area with a storage shed. There are 4 spacious bedrooms to the first floor and a family bathroom. In addition, the property overlooks Dartford Heath and also features double glazing, gas central heating, off road parking, garage en bloc which includes a parking space at the front for one car and easy access from the front to the rear garden. Your earliest viewing would be very highly recommended of this lovely family home.

Local Authority: Dartford
Council Tax Band: D

