

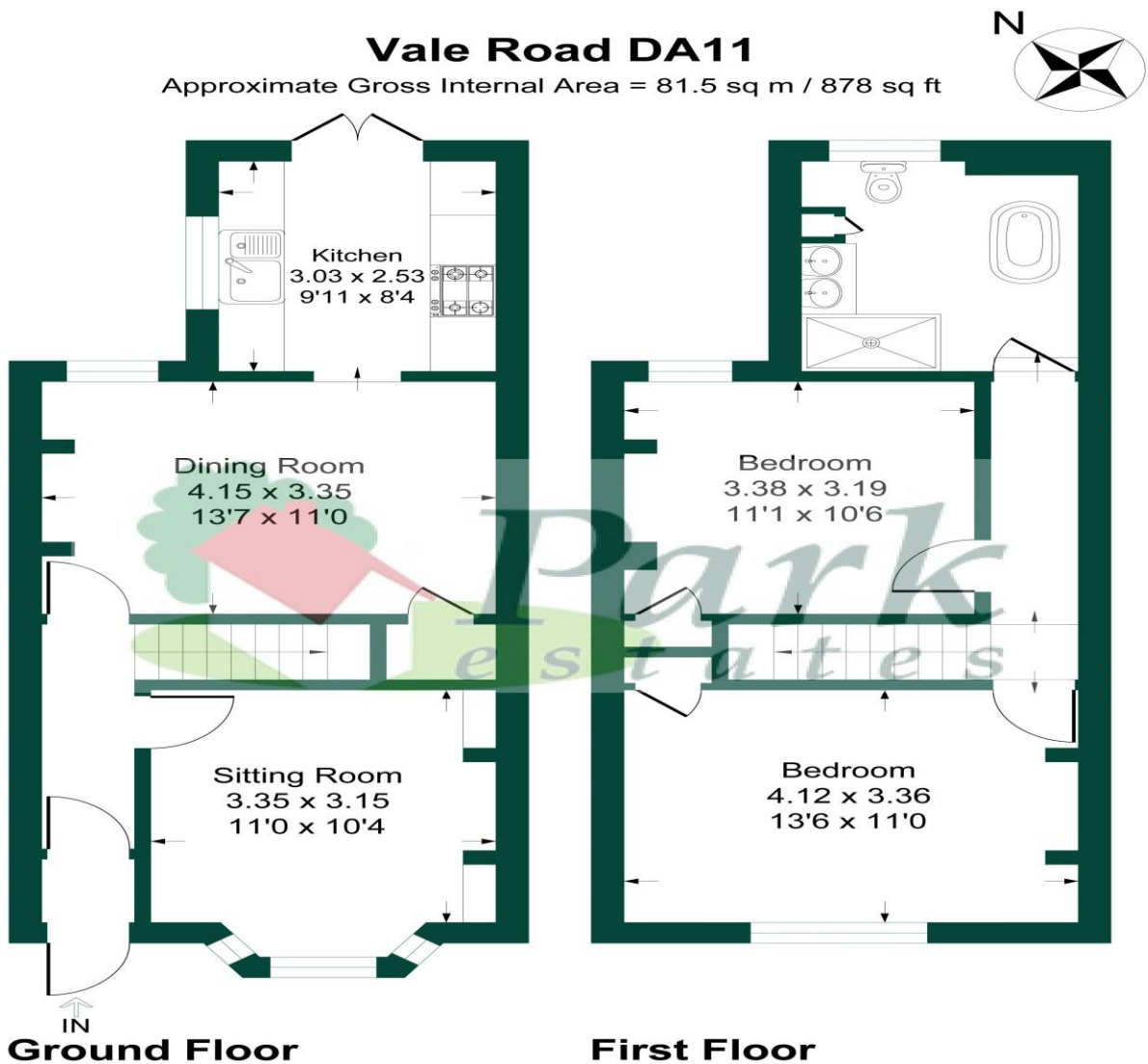

Score	Energy rating	Current	Potential
92+	A		
81-91	B		85 B
69-80	C		
55-68	D	68 D	
39-54	E		
21-38	F		
1-20	G		



This plan is for layout guidance only. Not drawn to scale unless stated. Windows and door openings are approximate. Whilst every care is taken in the preparation of this plan, please check all dimensions, shapes and compass bearings before making any decisions reliant upon them.  
Produced By Planpix

Every care has been taken with the preparation of details, but accuracy is in no way guaranteed. These particulars do not constitute a contract and are issued and accepted on the express understanding that all negotiations will be conducted through Park Estates. The seller does not make or give, nor do we or our employees have any authority to give a representation or warranty in relation to the property. Please contact this office before viewing the property. If there is any point which is of particular importance to you, we will be pleased to check the information for you and confirm that the property remains available. This is particularly important if you are contemplating travelling some distance to view the property. We would strongly recommend that all the information that we provide about the property is verified by yourself on inspection and also by your conveyancer, especially where statements have been made by us to the effect that the information provided by us has not been verified.



Conveniently situated for Northfleet & Ebbsfleet International stations is this spacious and very well maintained 2 bedroom terraced house, which comprises of 2 reception rooms, fully fitted kitchen with double glazed French doors, rear garden, 2 bedrooms and a large bathroom with twin basins, slipper bath and a separate shower. Other features to note include gas central heating and double glazed sash windows with shutters. An excellent first time buy, your earliest viewing would be very highly recommended.

Local Authority: Gravesham  
Council Tax Band: B

