



PARKHILL ROAD BEXLEY
DA5 1HY
GUIDE PRICE: £145,000 | Leasehold



Offered with no forward chain and vacant possession, is this ground floor studio flat, located in the heart of Old Bexley Village, just a short walk from all local amenities including local shops and schools, Bexley Station and all other transport links. An ideal first time buy or investment purchase, accommodation comprises of entrance hall, bathroom, reception / bedroom and a kitchenette. Benefits to note include double glazing, electric storage heaters, parking, communal gardens and a long lease.

Lease: 121 years
Ground Rent: £150 per annum
Service Charge: £2000 per annum
Local Authority: Bexley
Council Tax Band: A

Energy Efficiency Rating			
Score	Energy rating	Current	Potential
92+	A		
81-91	B		
69-80	C		
55-68	D		
39-54	E	52 E	81 B
21-38	F		
1-20	G		

 **Park**
estates
01322 553322

60-62 High Street, Bexley, Kent DA5 1AH
bexley@parkestates.co.uk
www.parkestates.co.uk

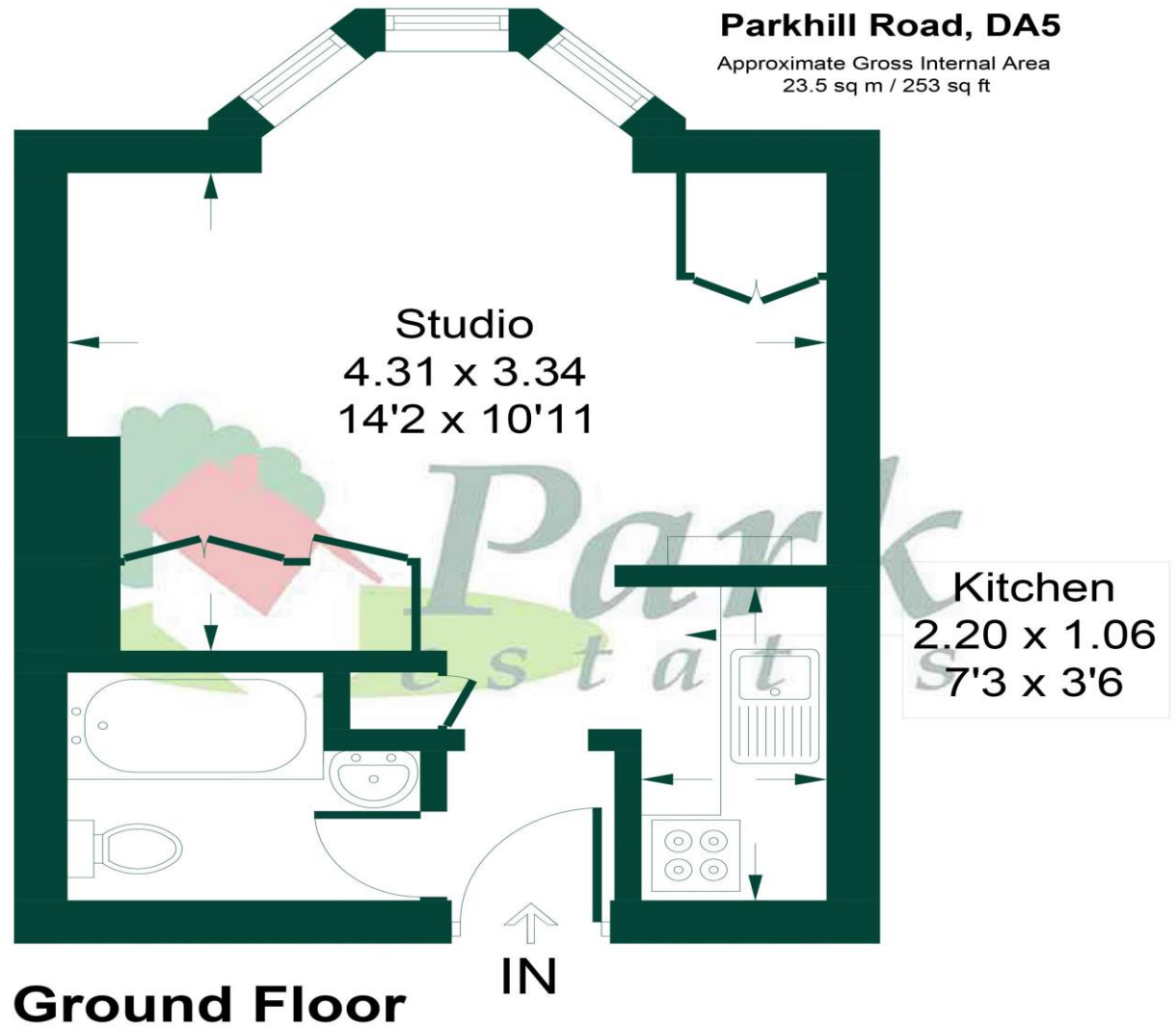

This plan is for layout guidance only. Not drawn to scale unless stated. Windows and door openings are approximate. Whilst every care is taken in the preparation of this plan, please check all dimensions, shapes and compass bearings before making any decisions reliant upon them.
Produced by Planpix on behalf of Park Estates (ID773800)

Every care has been taken with the preparation of details, but accuracy is in no way guaranteed. These particulars do not constitute a contract and are issued and accepted on the express understanding that all negotiations will be conducted through Park Estates. The seller does not make or give, nor do we or our employees have any authority to give a representation or warranty in relation to the property. Please contact this office before viewing the property. If there is any point which is of particular importance to you, we will be pleased to check the information for you and confirm that the property remains available. This is particularly important if you are contemplating travelling some distance to view the property. We would strongly recommend that all the information that we provide about the property is verified by yourself on inspection and also by your conveyancer, especially where statements have been made by us to the effect that the information provided by us has not been verified.