



FORESTERS CRESCENT BEXLEYHEATH KENT
DA7 4JW
Guide Price: £325,000 - £350,000 | Share of Freehold



Chain free, two double bedroom first floor maisonette, located within a quiet close, just a short walk from Bexleyheath town centre giving convenient access to Broadway Shopping Centre, selection of popular schools, Bexleyheath and Barnehurst stations and all other transport links including 'superloop' bus service to Abbey Wood Elizabeth line. This spacious property comprises of entrance hall, landing, two double bedrooms, bathroom and a generous lounge opening into a modern kitchen. Externally there is a garage en bloc and private rear garden. Benefits to note include double glazing and gas central heating. Viewing is recommended.

Lease: 936 years remaining

Share of Freehold

Local Authority: Bexley

Council Tax Band: C

Score	Energy rating	Current	Potential
92+	A		
81-91	B		
69-80	C	70 C	75 C
55-68	D		
39-54	E		
21-38	F		
1-20	G		



Park
estates
01322 553322

60-62 High Street, Bexley, Kent DA5 1AH

bexley@parkstates.co.uk

www.parkstates.co.uk

Foresters Crescent, DA7

Approximate Gross Internal Area = 66.7 sq m / 718 sq ft

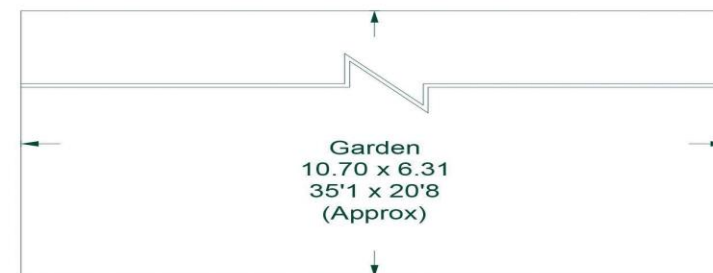

(Not Shown In Actual Location / Orientation)

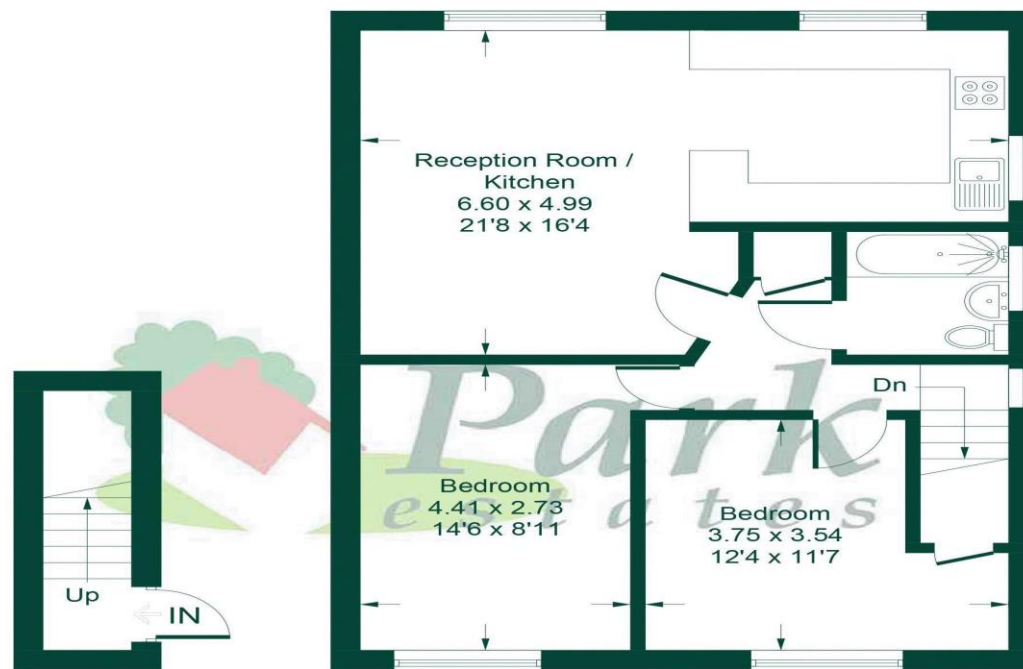

Ground Floor

First Floor

This plan is for layout guidance only. Not drawn to scale unless stated. Windows and door openings are approximate. Whilst every care is taken in the preparation of this plan, please check all dimensions, shapes and compass bearings before making any decisions reliant upon them.
Produced by Planpix on behalf of Park Estates (ID825465)

Every care has been taken with the preparation of details, but accuracy is in no way guaranteed. These particulars do not constitute a contract and are issued and accepted on the express understanding that all negotiations will be conducted through Park Estates. The seller does not make or give, nor do we or our employees have any authority to give a representation or warranty in relation to the property. Please contact this office before viewing the property. If there is any point which is of particular importance to you, we will be pleased to check the information for you and confirm that the property remains available. This is particularly important if you are contemplating travelling some distance to view the property. We would strongly recommend that all the information that we provide about the property is verified by yourself on inspection and also by your conveyancer, especially where statements have been made by us to the effect that the information provided by us has not been verified.