



WOODSIDE LANE BEXLEY KENT
DA5 1EY
Price: £280,000 | Leasehold



Spacious two double bedroom first floor maisonette, offered onto the market chain free. Located conveniently for a selection of popular local amenities including shops, schools, Danson Park and transport links. An ideal first time buy or buy to let investment purchase, the accommodation comprises of entrance hall, two double bedrooms, bathroom, fitted kitchen and one reception room. Externally there is a double garage to the rear and a private rear garden. Viewing is recommended.

102 years remaining. The lease expires 21st June 2127.

Local Authority: Bexley

Council Tax Band: C

Energy Efficiency Rating			
Score	Energy rating	Current	Potent
92+	A		
81-91	B		
69-80	C		
55-68	D	63 D	75
39-54	E		
21-38	F		
1-20	G		



01322 553322

60-62 High Street, Bexley, Kent DA5 1AH

bexley@parkestates.co.uk

Woodside Lane

Approximate Gross Internal Area = 60.4 sq m / 650 sq ft

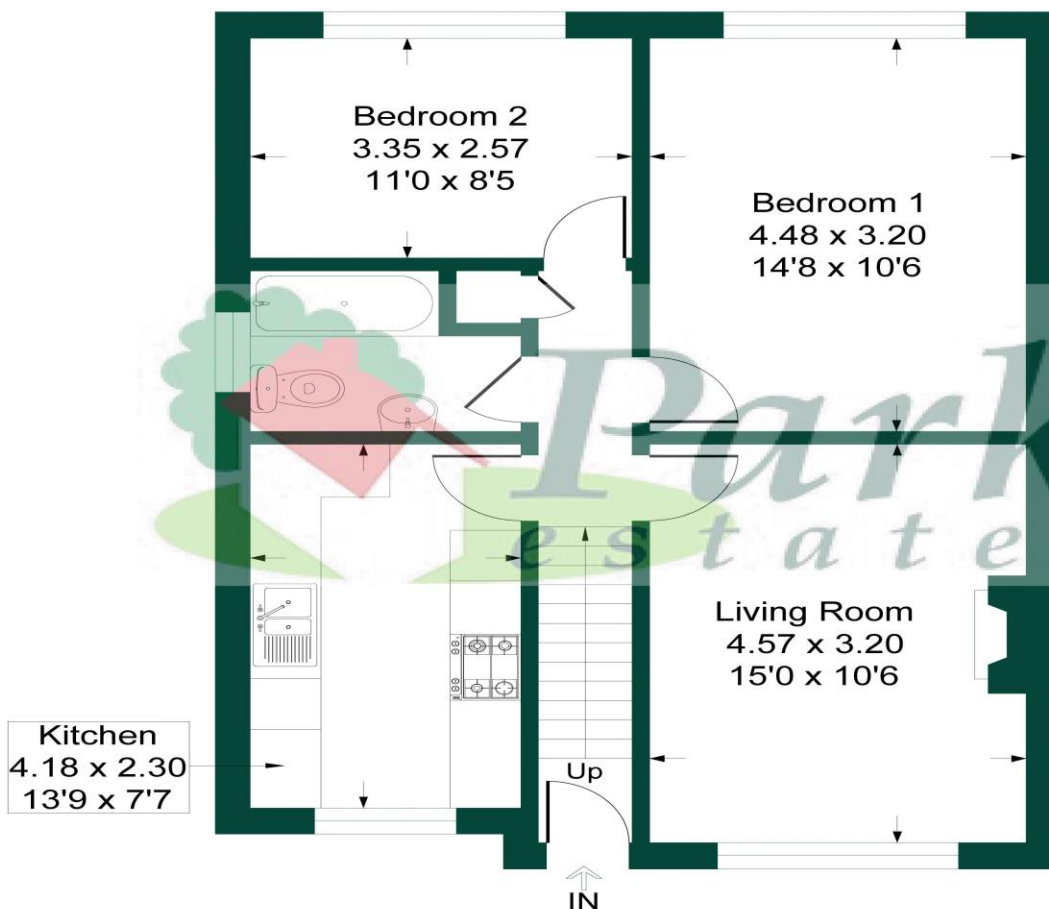

This plan is for layout guidance only. Not drawn to scale unless stated. Windows and door openings are approximate. Whilst every care is taken in the preparation of this plan, please check all dimensions, shapes and compass bearings before making any decisions reliant upon them.
Produced By Planpix

Every care has been taken with the preparation of details, but accuracy is in no way guaranteed. These particulars do not constitute a contract and are issued and accepted on the express understanding that all negotiations will be conducted through Park Estates. The seller does not make or give, nor do we or our employees have any authority to give a representation or warranty in relation to the property. Please contact this office before viewing the property. If there is any point which is of particular importance to you, we will be pleased to check the information for you and confirm that the property remains available. This is particularly important if you are contemplating travelling some distance to view the property. We would strongly recommend that all the information that we provide about the property is verified by yourself on inspection and also by your conveyancer, especially where statements have been made by us to the effect that the information provided by us has not been verified.