

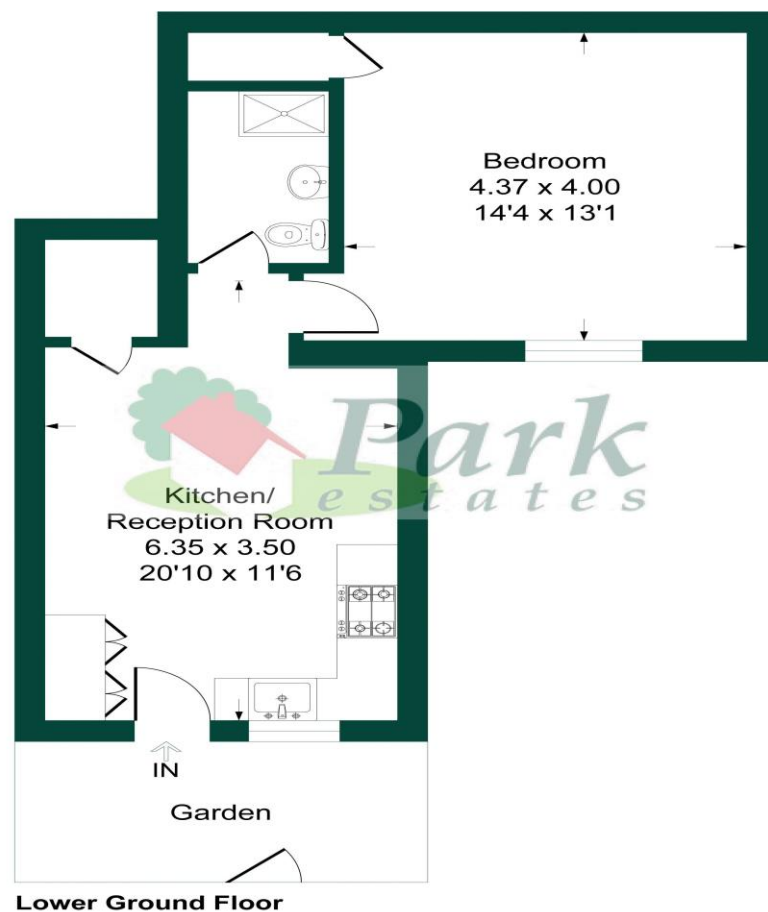

North Cray Road

Approximate Gross Internal Area = 45.1 sq m / 486 sq ft



This plan is for layout guidance only. Not drawn to scale unless stated. Windows and door openings are approximate. Whilst every care is taken in the preparation of this plan, please check all dimensions, shapes and compass bearings before making any decisions reliant upon them.
Produced By Planpix



Park Estates are delighted to offer this newly converted 1 bedroom ground floor flat with its own entrance, courtyard garden and allocated parking. This is one of 3 x 2 bedroom and 1 x 1 bedrooms flats in a small high quality development situated within a short walk of Bexley High Street. There is a high standard finish throughout which includes a luxury fitted kitchen and open plan living area, shower room, carpeted bedrooms, laminate flooring, gas central heating and double glazing. Available immediately and chain free your early viewing is very highly recommended.

Local Authority: Bexley

