

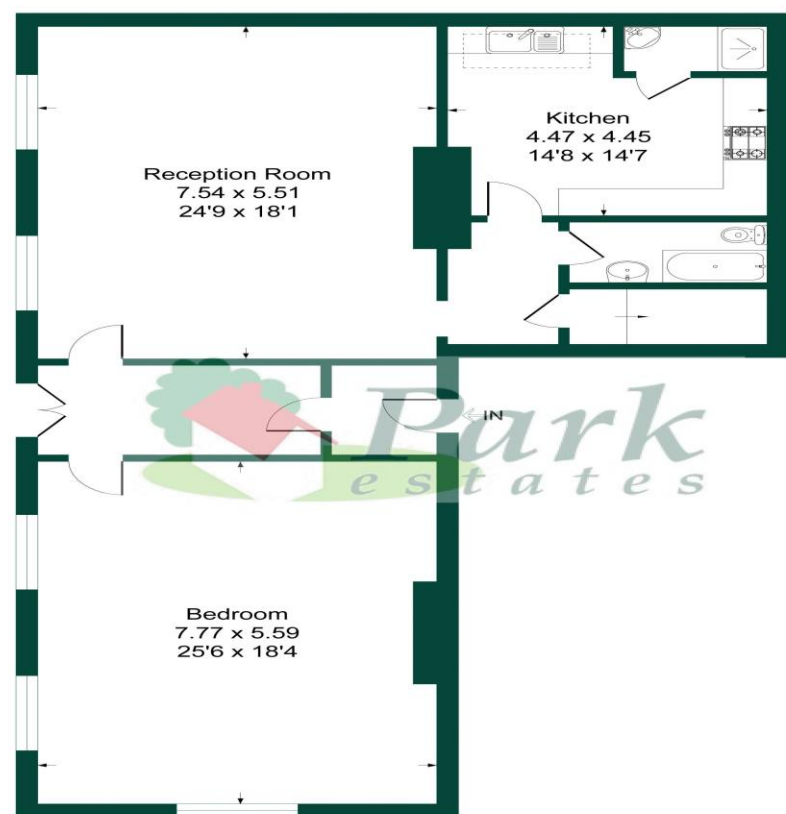

The Manor House, DA5

Approximate Gross Internal Area = 131.9 sq m / 1421 sq ft



Ground Floor

This plan is for layout guidance only. Not drawn to scale unless stated. Windows and door openings are approximate. Whilst every care is taken in the preparation of this plan, please check all dimensions, shapes and compass bearings before making any decisions reliant upon them. Produced By Planpix



Energy Efficiency Rating			
Score	Energy rating	Current	Potential
92+	A		
81-91	B		
69-80	C		71 C
55-68	D		
39-54	E	49 E	
21-38	F		
1-20	G		

The Manor House is a much sought after private gated development of immense character in the Bexley Village conservation area. We are delighted to offer this unique and very large period ground floor apartment, with direct access to a private patio area and extensive communal formal gardens extending to approx 2.08 acres. Boasting many original features such as coving, cornicing, internal doors, windows and window shutters, there is just so much potential to create a beautiful home. Tucked away within a very short walk to Bexley Village and all amenities and boasting 1421 sq ft of accommodation, 12'5" high ceilings, allocated parking, long lease and no forward chain, your early viewing would be very highly recommended.

Lease: 125 years from 1.1.99 (100 years remaining)

Service Charge: £2,543.76 per annum.

Local Authority: Bexley

Council Tax Band: E

