

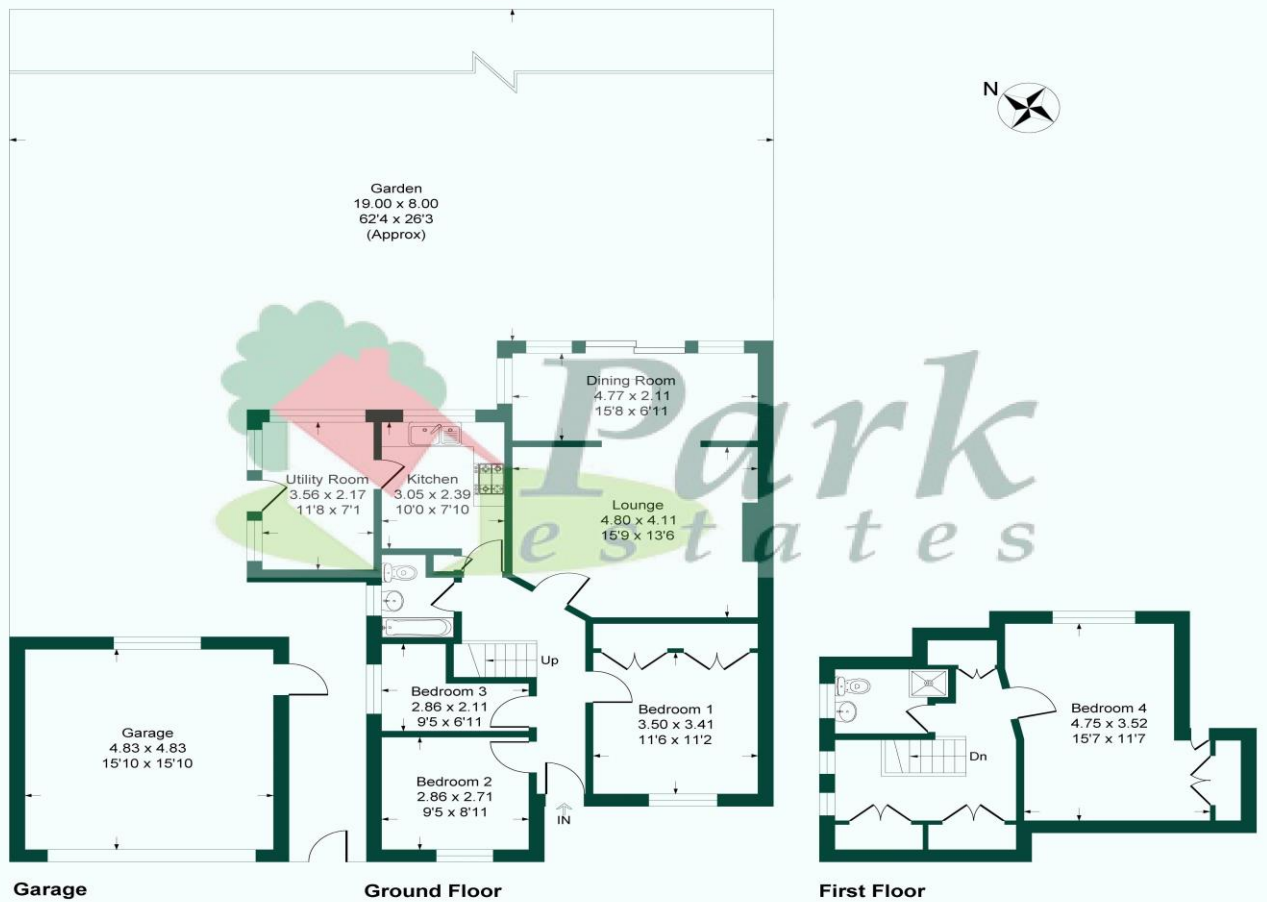

Birchwood Drive

Approximate Gross Internal Area = 119.2 sq m / 1284 sq ft
 Garage = 23.3 sq m / 251 sq ft
 Total = 142.5 sq m / 1535 sq ft



This plan is for layout guidance only. Not drawn to scale unless stated. Windows and door openings are approximate. Whilst every care is taken in the preparation of this plan, please check all dimensions, shapes and compass bearings before making any decisions reliant upon them.
 Produced By Planpix



Energy Efficiency Rating			
Score	Energy rating	Current	Potential
92+	A		
81-91	B		
69-80	C		71 C
55-68	D		
39-54	E		
21-38	F	34 F	
1-20	G		

First time on market since 1959 and occupying a very wide plot in a sought-after road and location, within close proximity of excellent schools, we are delighted to offer this CHAIN FREE 4 bedroom semi-detached chalet bungalow, with flexible living space and lots of potential to extend. Well presented throughout, the property comprises of extended lounge and fitted kitchen, 3 generous ground floor bedrooms, ground floor bathroom and to the first floor, a very large 4th bedroom and shower room. In addition there is a double garage, 62'4 approx rear garden, double glazing, gas central heating and plenty of off road parking. Your early viewing is very highly recommended.

Local Authority: Dartford
Council Tax Band: F

