



VILLAGE MEWS THANET ROAD BEXLEY
DA5 1AP
GUIDE PRICE: £325,000 - £350,000 | LEASEHOLD



Situated within the heart of Old Bexley Village, just a few minutes' walk from Bexley Station and all other popular local amenities, is this two double bedroom ground floor apartment. The property is well presented throughout and comprises of entrance hall, two bedrooms, shower room, one reception room and a kitchen. Other benefits to note include some double glazing, gas central heating, allocated parking and no chain. Viewing is highly recommended.

Lease: Approximately 100 years remaining.

Service Charge: £100 per month.

Local Authority: Bexley

Council Tax Band: D

Energy Efficiency Rating			
Score	Energy rating	Current	Potential
92+	A		
81-91	B		
69-80	C	71 C	78 C
55-68	D		
39-54	E		
21-38	F		
1-20	G		

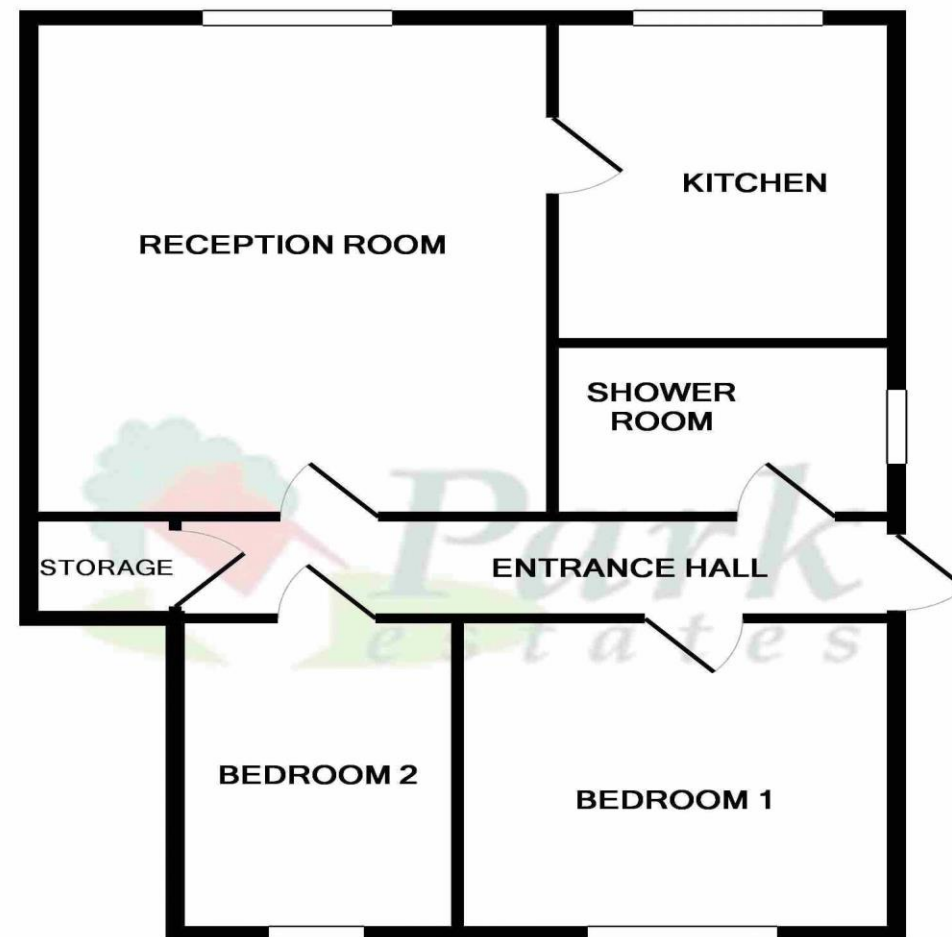

Whilst every attempt has been made to ensure the accuracy of the floor plan contained here, measurements of doors, windows, rooms and any other items are approximate and no responsibility is taken for any error, omission, or mis-statement. This plan is for illustrative purposes only and should be used as such by any prospective purchaser. The services, systems and appliances shown have not been tested and no guarantee as to their operability or efficiency can be given
Made with Metropix ©2019



01322 553322

60-62 High Street, Bexley, Kent DA5 1AH

bexley@parkestates.co.uk

www.parkestates.co.uk

Every care has been taken with the preparation of details, but accuracy is in no way guaranteed. These particulars do not constitute a contract and are issued and accepted on the express understanding that all negotiations will be conducted through Park Estates. The seller does not make or give, nor do we or our employees have any authority to give a representation or warranty in relation to the property. Please contact this office before viewing the property. If there is any point which is of particular importance to you, we will be pleased to check the information for you and confirm that the property remains available. This is particularly important if you are contemplating travelling some distance to view the property. We would strongly recommend that all the information that we provide about the property is verified by yourself on inspection and also by your conveyancer, especially where statements have been made by us to the effect that the information provided by us has not been verified.