

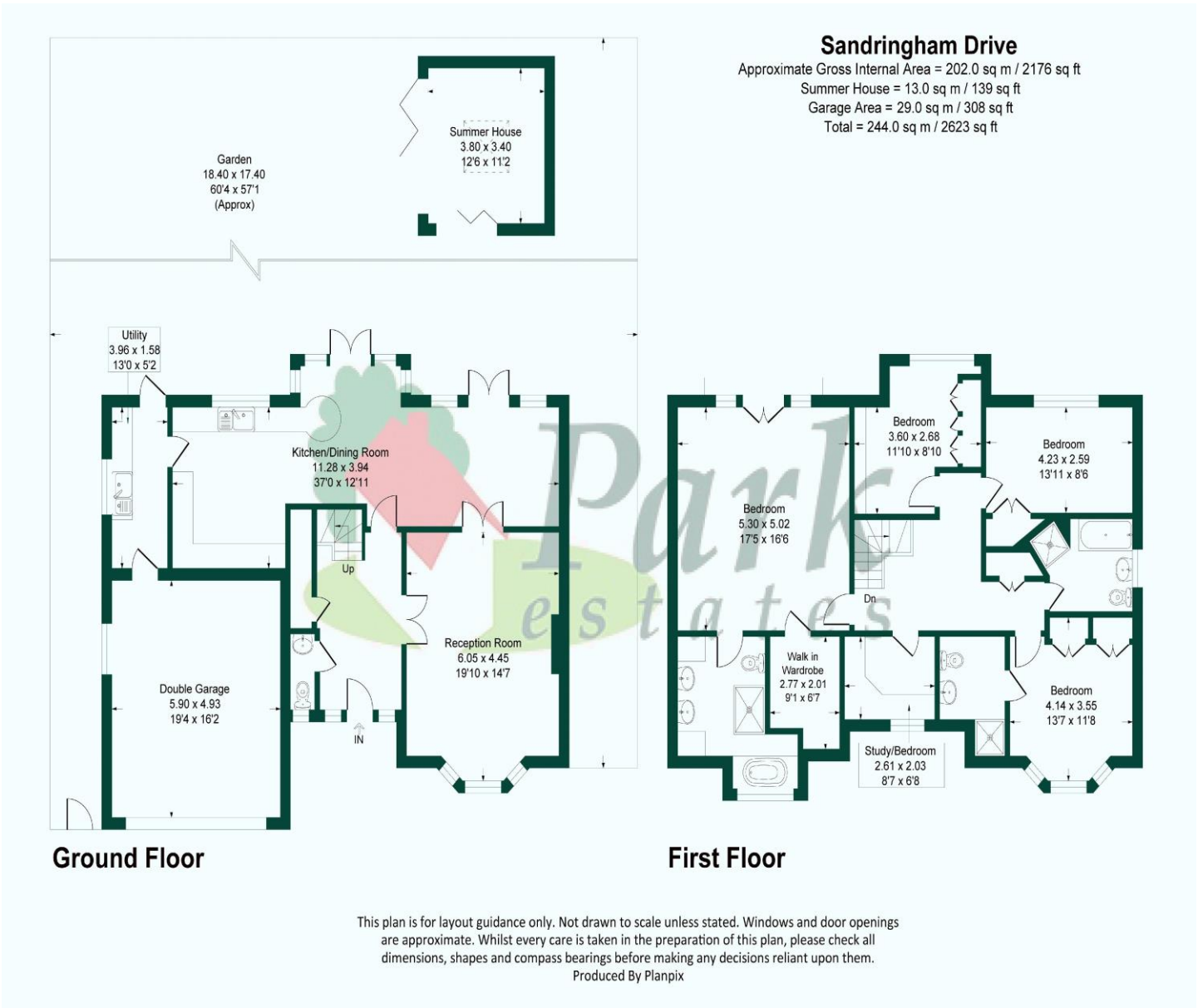

Energy Efficiency Rating			
Score	Energy rating	Current	Potential
92+	A		
81-91	B		
69-80	C		
55-68	D		
39-54	E		
21-38	F		
1-20	G		



Park Estates are delighted to offer onto the market this beautifully presented five bedroom detached house, located conveniently for popular local schools including primary and grammar, local shops and transport links, on the popular Bexley Park development. A truly ideal family home, the property is tastefully decorated throughout, with generous living accommodation comprising of entrance hall, ground floor wc, spacious living room, luxury hand made fitted kitchen / dining and living area to the rear and a separate utility room. To the first floor there is a spacious landing, five bedrooms - of which four are doubles, two beautifully fitted ensuites and the master bedroom with a walk in wardrobe. In addition there is also a separate family bathroom. Additional benefits to note include front garden with off street parking, landscaped rear garden with artificial grass and golfing green, double integral garage, double glazing, gas central heating, CCTV and underfloor heating. Viewing is highly recommended to fully appreciate this superb home.

Local Authority: Dartford
Maintenance Charge: £300 per year
Council Tax Band: G

