

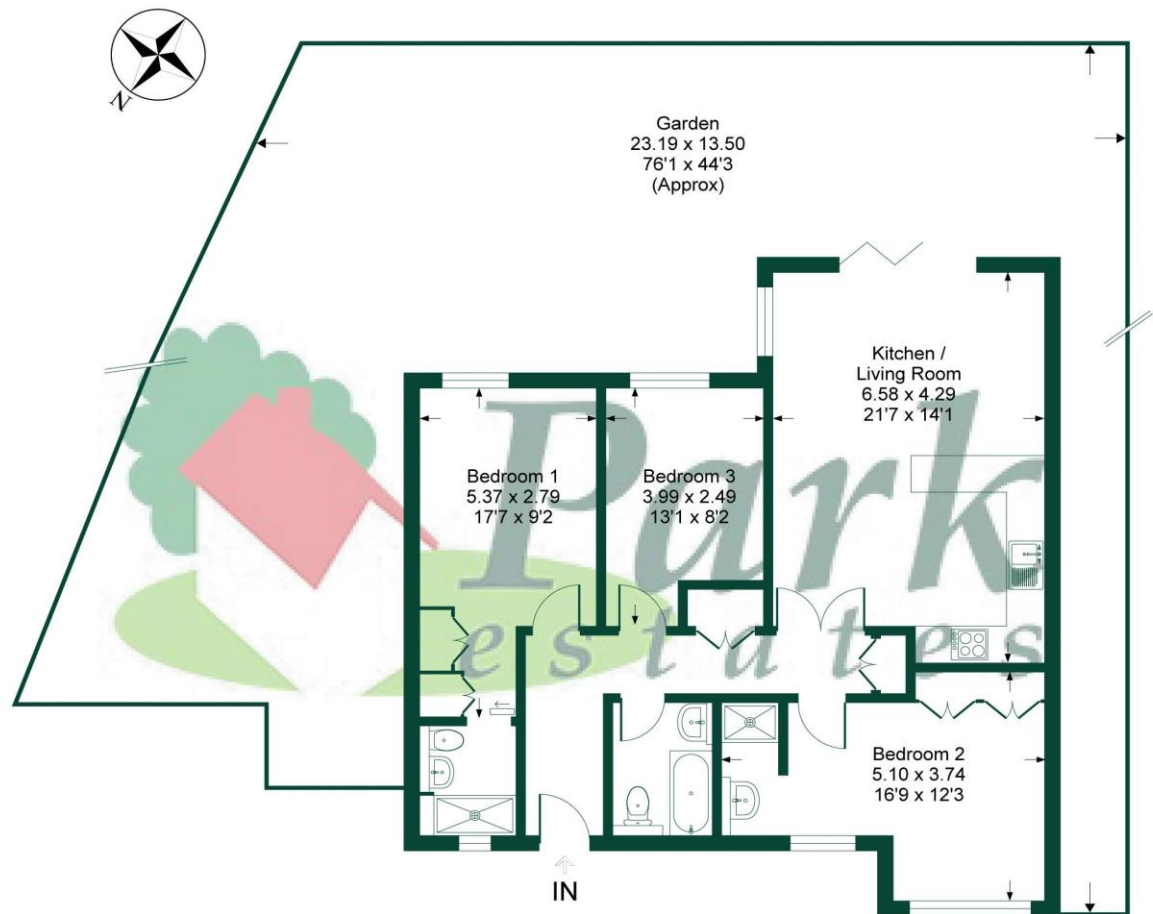

**Trafalgar Road, DA1**

Approximate Gross Internal Area = 83 sq m / 893 sq ft



This plan is for layout guidance only. Not drawn to scale unless stated. Windows and door openings are approximate. Whilst every care is taken in the preparation of this plan, please check all dimensions, shapes and compass bearings before making any decisions reliant upon them.  
Produced by Planpix

Park Estates are delighted to offer this spacious architecturally designed NEW BUILD 3 bedroom detached bungalow, situated in a small gated private development within close proximity of all local amenities. Built to a very high specification which includes green roof and walls, high quality flooring, double glazing, electric heating with solar powered heat pump, built in wardrobes and cupboards, large open plan living area with luxury fitted kitchen with Bosch appliances, main bathroom, ensuite shower room and open plan wash and shower area - all with Hansgrohe and RAK fittings, 76ft x 44ft approx rear garden with very easy access, parking (for two cars) and a 10 year ICW building warranty. Early viewing is highly recommended.

Local Authority: Dartford

Council Tax Band: TBC

