



OAKFIELD PARK ROAD DARTFORD KENT
DA1 2ST
£325,000 | Freehold



Three bedroom end of terrace house in need of complete modernisation throughout, but offering a wealth of potential to create an ideal family home. Located within a quiet road offering convenient access to local shops, popular schools including Wilmington and Dartford Grammar Schools, Oakfield Park and local transport links. The property offers potential to extend subject to relevant planning consents, with current accommodation comprising of entrance hall, two reception rooms, kitchen and a conservatory. To the first floor there is a bathroom and three bedrooms. Additional benefits include double glazing, gas central heating, external storage, front and rear gardens, off street parking and no chain.

Local Authority: Dartford
Council Tax Band: D

Oakfield Park Road, DA1

Approximate Gross Internal Area = 84 sq m / 905 sq ft
Approximate Store Internal Area = 16 sq m / 172 sq ft
Approximate Total Internal Area = 100 sq m / 1077 sq ft

Energy Efficiency Rating			
Score	Energy rating	Current	Potential
92+	A		
81-91	B		82 B
69-80	C		
55-68	D	57 D	
39-54	E		
21-38	F		
1-20	G		

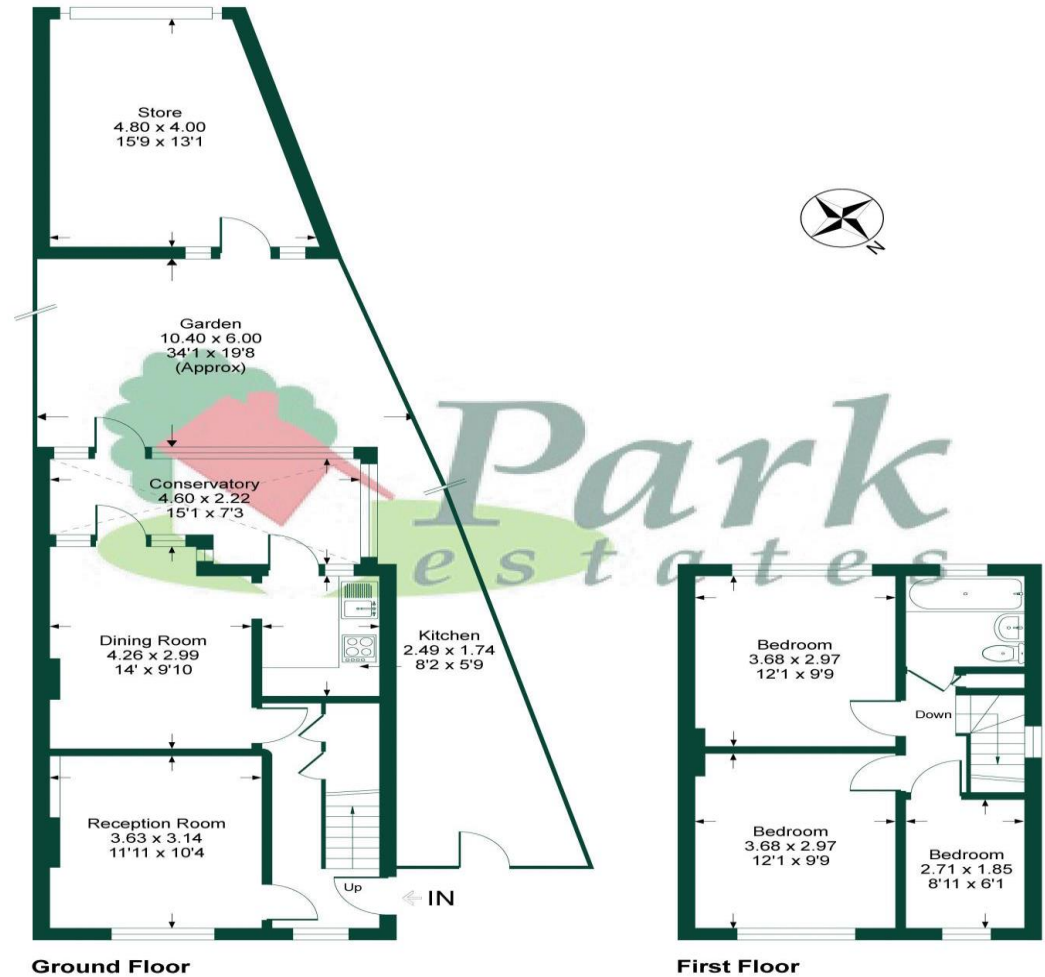

This plan is for layout guidance only. Not drawn to scale unless stated. Windows and door openings are approximate. Whilst every care is taken in the preparation of this plan, please check all dimensions, shapes and compass bearings before making any decisions reliant upon them.
Produced by Planpix



01322 553322

60-62 High Street, Bexley, Kent DA5 1AH

bexley@parkestates.co.uk
www.parkestates.co.uk

Every care has been taken with the preparation of details, but accuracy is in no way guaranteed. These particulars do not constitute a contract and are issued and accepted on the express understanding that all negotiations will be conducted through Park Estates. The seller does not make or give, nor do we or our employees have any authority to give a representation or warranty in relation to the property. Please contact this office before viewing the property. If there is any point which is of particular importance to you, we will be pleased to check the information for you and confirm that the property remains available. This is particularly important if you are contemplating travelling some distance to view the property. We would strongly recommend that all the information that we provide about the property is verified by yourself on inspection and also by your conveyancer, especially where statements have been made by us to the effect that the information provided by us has not been verified.