



BEACONSFIELD ROAD BEXLEY KENT
DA5 2AE
£399,995 | Freehold



Three bedroom semi detached bungalow, offered with the benefit of no chain and located within a quiet road, offering convenient access to popular local schools including Wilmington Grammar, shops, Dartford Heath and transport links. The property comprises of entrance hall, three bedrooms, two reception rooms and a modern bathroom and kitchen. Additional benefits to note include double glazing, gas central heating, off street parking and rear garden. Viewing is recommended.

Local Authority:
Council Tax Band: D

| Energy Efficiency Rating | | | |
|--------------------------|---------------|---------|-----------|
| Score | Energy rating | Current | Potential |
| 92+ | A | | |
| 81-91 | B | | |
| 69-80 | C | | 80 C |
| 55-68 | D | | |
| 39-54 | E | 50 E | |
| 21-38 | F | | |
| 1-20 | G | | |



01322 553322

60-62 High Street, Bexley, Kent DA5 1AH

bexley@parkestates.co.uk

www.parkestates.co.uk

Beaconsfield Road

Approximate Gross Internal Area = 83 sq m / 891 sq ft

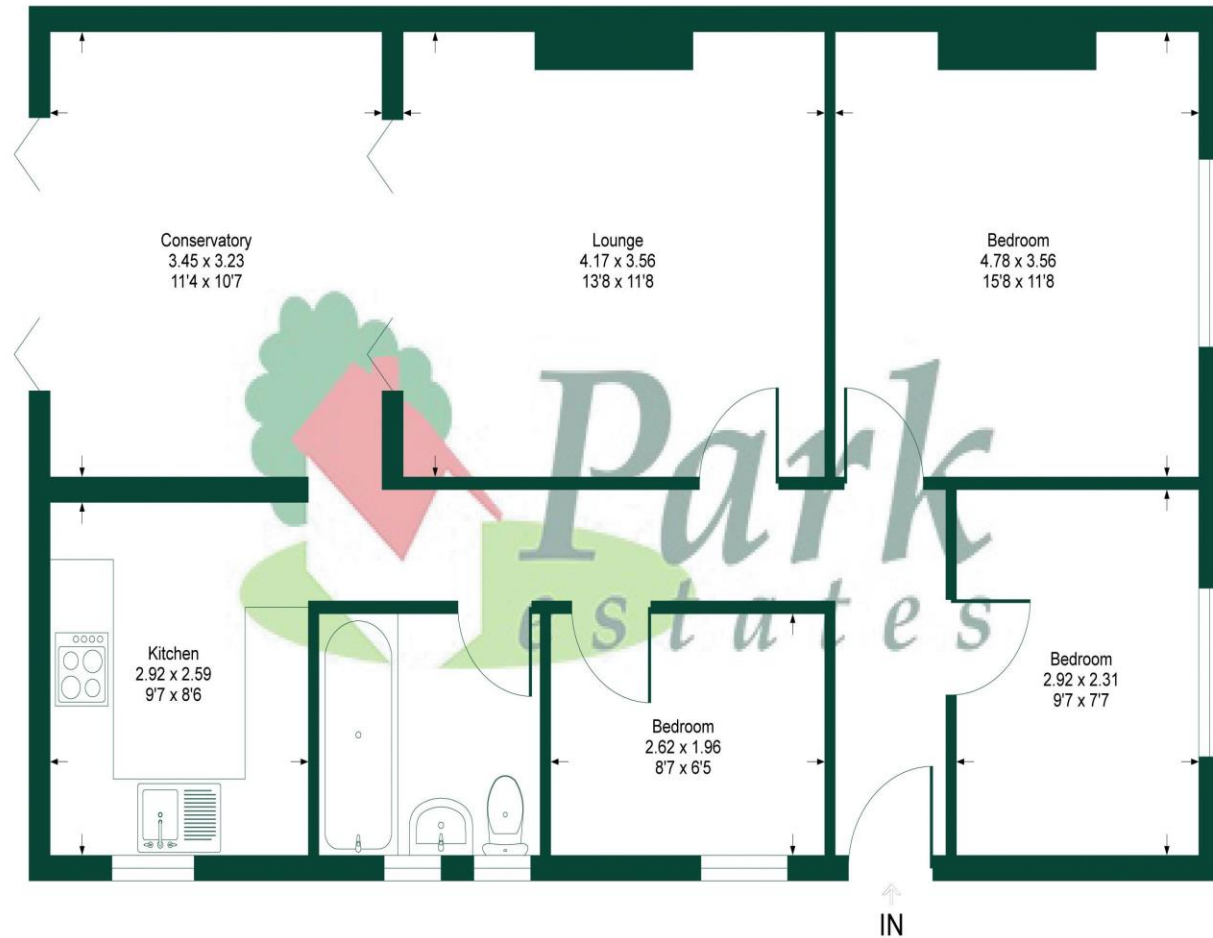

This plan is for layout guidance only. Not drawn to scale unless stated. Windows and door openings are approximate. Whilst every care is taken in the preparation of this plan, please check all dimensions, shapes and compass bearings before making any decisions reliant upon them.

Produced by Planpix

Every care has been taken with the preparation of details, but accuracy is in no way guaranteed. These particulars do not constitute a contract and are issued and accepted on the express understanding that all negotiations will be conducted through Park Estates. The seller does not make or give, nor do we or our employees have any authority to give a representation or warranty in relation to the property. Please contact this office before viewing the property. If there is any point which is of particular importance to you, we will be pleased to check the information for you and confirm that the property remains available. This is particularly important if you are contemplating travelling some distance to view the property. We would strongly recommend that all the information that we provide about the property is verified by yourself on inspection and also by your conveyancer, especially where statements have been made by us to the effect that the information provided by us has not been verified.