



Apartment

MILLHAVEN CLOSE, ROMFORD, RM6 4PW

PCM

£1,250

FEATURES

- Purpose built apartment
- Kitchen
- Bathroom
- Communal gardens
- First floor
- lounge
- Communal parking



1 Bedroom Apartment located in Romford

Steps Estate Agents are pleased to offer TO LET this one bedroom first floor, purpose built apartment located in Chadwell Heath. The property has been recently refurbished with a modern kitchen and bathroom and the added benefit of communal parking. Call early to avoid disappointment.

Call us on
020 8593 5933

dagenham@steps.me.uk
www.steps.me.uk

Council Tax Band
B

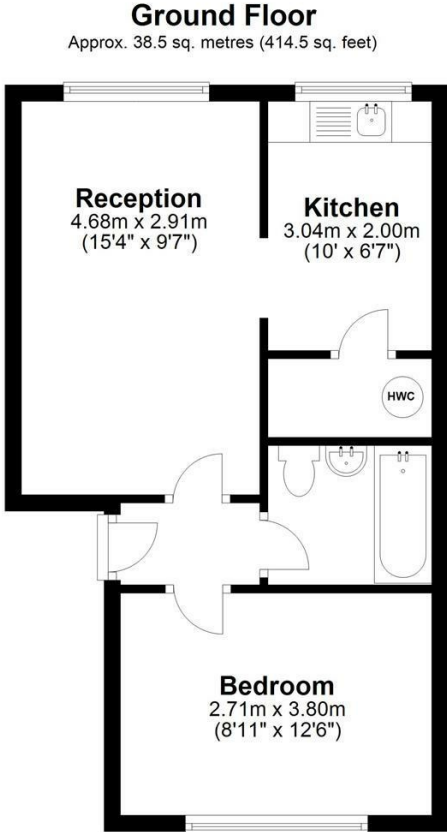

Total area: approx. 38.5 sq. metres (414.5 sq. feet)

Energy Efficiency Rating		Current	Potential
<i>Very energy efficient - lower running costs</i>			
(92 plus)	A		
(81-91)	B		80
(69-80)	C	69	
(55-68)	D		
(39-54)	E		
(21-38)	F		
(1-20)	G		
<i>Not energy efficient - higher running costs</i>			
England & Wales		EU Directive 2002/91/EC	

Agents Note: Whilst every care has been taken to prepare these particulars, they are for guidance purposes only. All measurements are approximate and are for general guidance purposes only and whilst every care has been taken to ensure their accuracy, they should not be relied upon and potential buyers are advised to recheck the measurements.

