

FREEHOLD



House - End Terrace

# VALENCE CIRCUS, DAGENHAM, RM8 3LX

Asking Price

## £385,000

### FEATURES

- CHAIN FREE
- Lounge
- Ground Floor Bathroom
- Double Glazing
- Three Bedrooms
- Fitted Kitchen
- Gas Central Heating
- Off Street Parking



## STEPS

Estate Agents

# 3 Bedroom House - End Terrace located in Dagenham

## Entrance

Via double glazed door to hallway.

## Hallway

Double glazed window to side, doors to lounge, kitchen and bathroom, stairs to first floor.

## Lounge

14'4" x 11'1"

Double glazed window to front radiator, laminated flooring.

## Kitchen

15'5" x 8'9"

Double glazed window to rear, stable style door to rear garden, single bowl sink, matching eye and base level units, integrated oven and hob, space for fridge and washing machine.

## Bathroom

8'9" x 5'4"

Double window to front, panel bath with mixer taps, splash screen and a electric shower, vanity wash hand basin, low flush w/c, tiled splash backs and floor, radiator.

## Landing

Double glazed window to side, access to loft.

## Bedroom One

17'3" x 14'00" x 9'2"

Double glazed window to front, radiator

## Bedroom Two

10'11" x 8'9"

Double glazed window to rear, radiator.

## Bedroom Three

8'2" x 7'8"

Double glazed window to rear, radiator.

## Rear Garden

70 approx

Side access grass section, bushes and trees.

We routinely refer potential purchasers to Move with Us Ltd. It is your decision whether you choose to deal with Move with Us Ltd. In making that decision, you should know that we receive an annual payment benefits from Move with Us Ltd, equating to approximately £314.48 per referral.



DAGENHAM SALES | STEPS ESTATE AGENTS, 298 HEATHWAY, DAGENHAM, ESSEX, RM10 8LU



Call us on

**020 8593 5933**

[dagenham@steps.me.uk](mailto:dagenham@steps.me.uk)

[www.steps.me.uk](http://www.steps.me.uk)

**Council Tax Band**

**C**

GROUND FLOOR

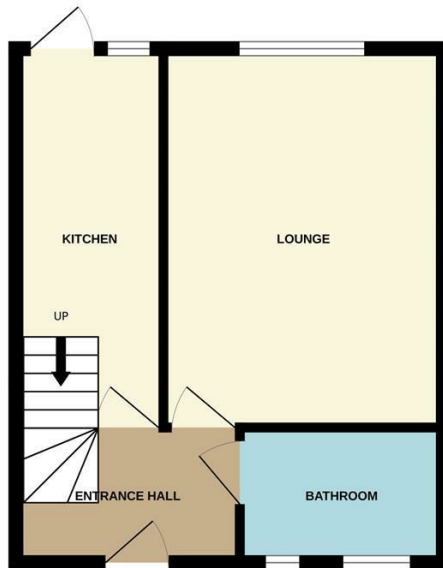

1ST FLOOR

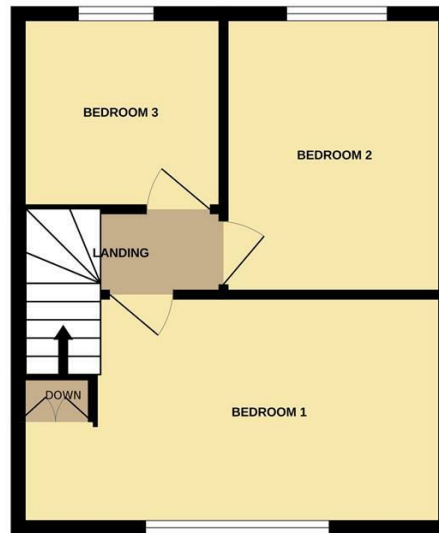

Whilst every attempt has been made to ensure the accuracy of the floorplan contained here, measurements of doors, windows, rooms and any other items are approximate and no responsibility is taken for any error, omission or mis-statement. This plan is for illustrative purposes only and should be used as such by any prospective purchaser. The services, systems and appliances shown have not been tested and no guarantee as to their operability or efficiency can be given.  
Made with Metropix ©2024

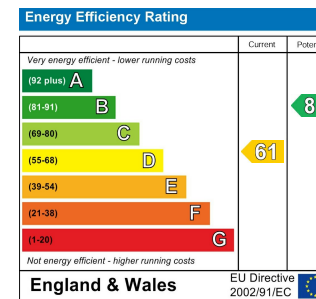

Agents Note: Whilst every care has been taken to prepare these particulars, they are for guidance purposes only. All measurements are approximate and are for general guidance purposes only and whilst every care has been taken to ensure their accuracy, they should not be relied upon and potential buyers are advised to recheck the measurements.

