



## Gautrey Road, SE15

£285,000

Situated on the first floor of a converted Victorian end terrace house, this one bedroom flat is sold with a share of freehold and no onward chain. Requiring some updating this is the perfect opportunity to create a fantastic first home.

Enviably located on a tree lined street the property is a short walk from Nunhead (zone 2) and Queens Road stations, the green spaces of Telegraph Hill, Nunhead Cemetery and Peckham Rye, and the area's wide range of restaurants, bars and community events.

### Features

First Floor  
Requires Updating  
Bright Accommodation  
Share Of Freehold  
No Onward Chain

**Gautrey Road,  
London, SE15**

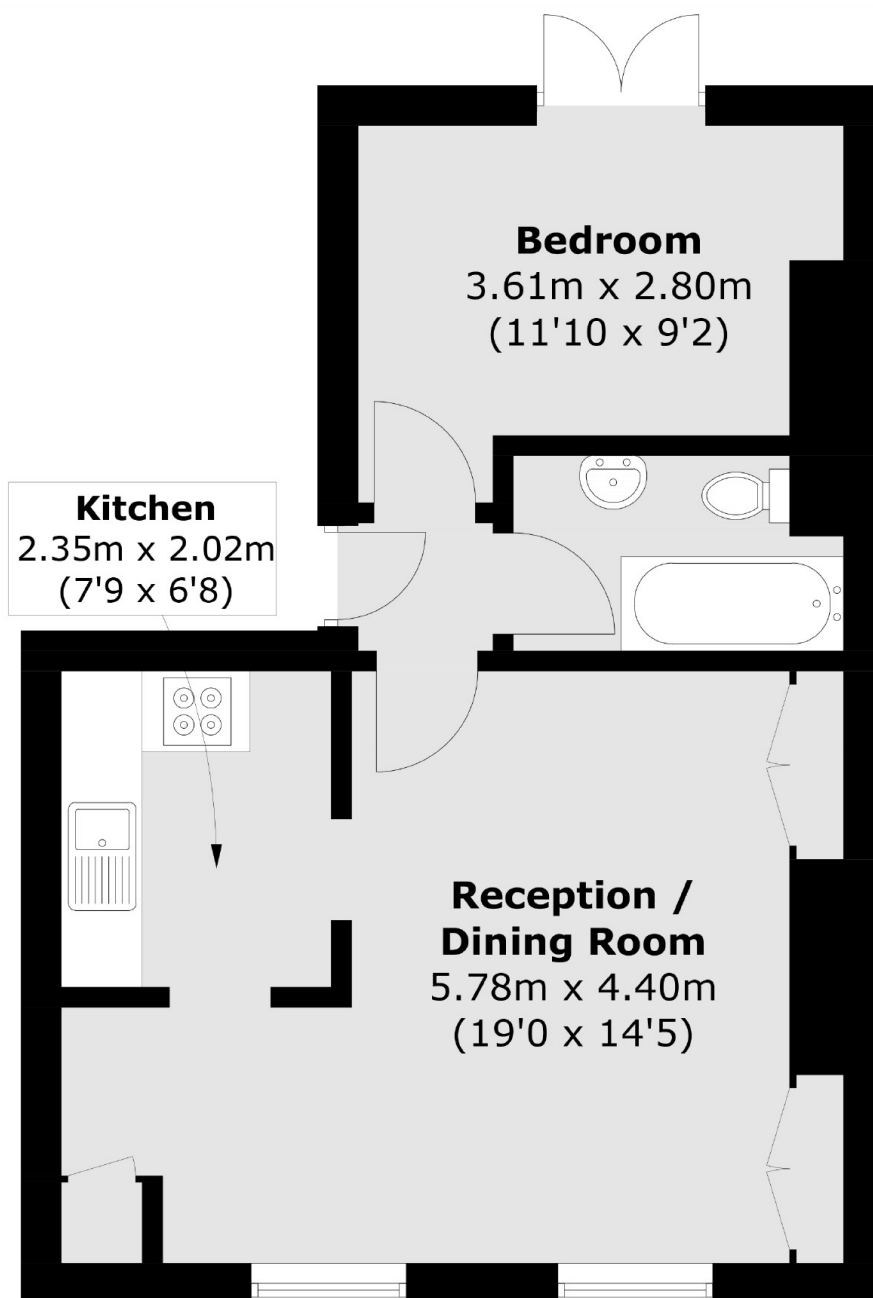

## **First Floor**

Total area (approx.): 40.4 sq. m (434.9 sq. ft)

**Dexters**

Peckham Rye  
2 Barry Parade  
Barry Road  
London  
Sales  
020 8742 4146

Energy Rating: D. We aim to make our particulars both accurate and reliable. However they are not guaranteed; nor do they form part of an offer or contract. If you require clarification on any points then please contact us, especially if you're traveling some distance to view. Please note that appliances and heating systems have not been tested and therefore no warranties can be given as to their good working order.

 **RICS** | Regulated  
Estate Agent  
and Letting Agent

dexters.co.uk