



## Ivydale Road, SE15

### £1,000,000

A 1503 square foot Victorian terraced house with four bedrooms in need of updating throughout and being sold with no onward chain.

Ivydale Road is perfectly placed for Nunhead station with frequent trains to Victoria, Blackfriars, City Thameslink, Farringdon and St Pancras or Brockley station if the East London line is required. The green open spaces of Peckham Rye, Nunhead Cemetery and the Telegraph Hill Parks are all within easy reach.

### Features

Victorian Terrace  
No Onward Chain  
Four Bedrooms  
Great Location  
1503 Square Foot  
Period Features

# Ivydale Road, London, SE15

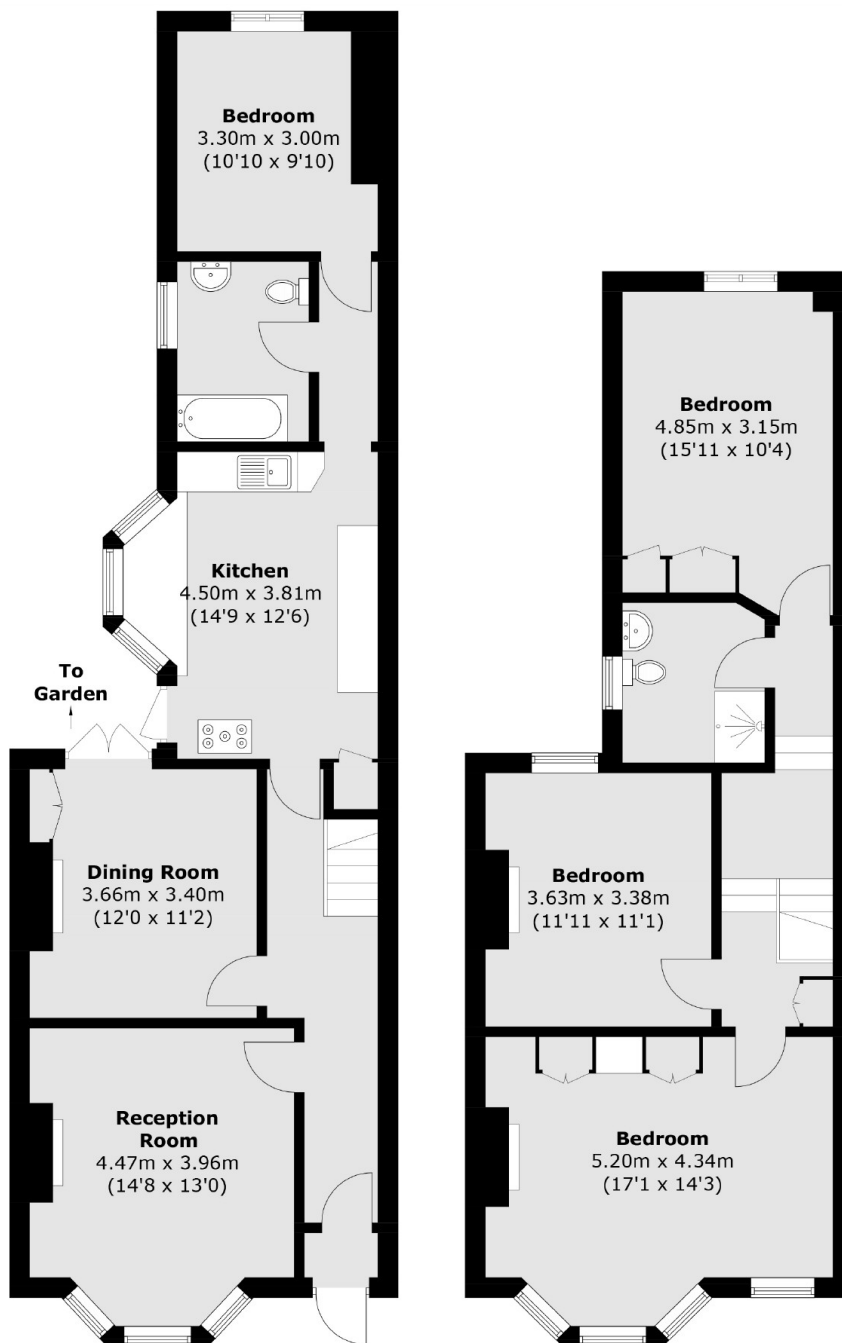

**First Floor**

**Second Floor**

Total area (approx.): 139.7 sq. m (1,503.7 sq. ft)

**Dexters**

Peckham Rye  
2 Barry Parade  
Barry Road  
London  
Sales  
020 8742 4146

Energy Rating: D. We aim to make our particulars both accurate and reliable. However they are not guaranteed; nor do they form part of an offer or contract. If you require clarification on any points then please contact us, especially if you're traveling some distance to view. Please note that appliances and heating systems have not been tested and therefore no warranties can be given as to their good working order.

 **RICS** | Regulated  
Estate Agent  
and Letting Agent

[dexters.co.uk](https://www.dexters.co.uk)