



Colegrove Road, SE15

£450,000

A spacious two double bedroom top floor flat at 767 square foot in a purpose built modern development on Colegrove Road. With the added benefit of an allocated parking space and access to a beautiful communal garden, this property provides a superb balance of privacy and community.

Colegrove Road is conveniently located for access into Central London via Peckham Rye Station or Queens Road Station which are equidistant from the property. Residents benefit from proximity to green spaces such as Burgess Park and local amenities, enhancing the area's appeal for families and professionals alike.

Features

- Two Double Bedrooms
- Top Floor Flat
- Communal Garden
- Parking Space
- Good Storage
- Excellent Condition

Colegrove Road, London, SE15

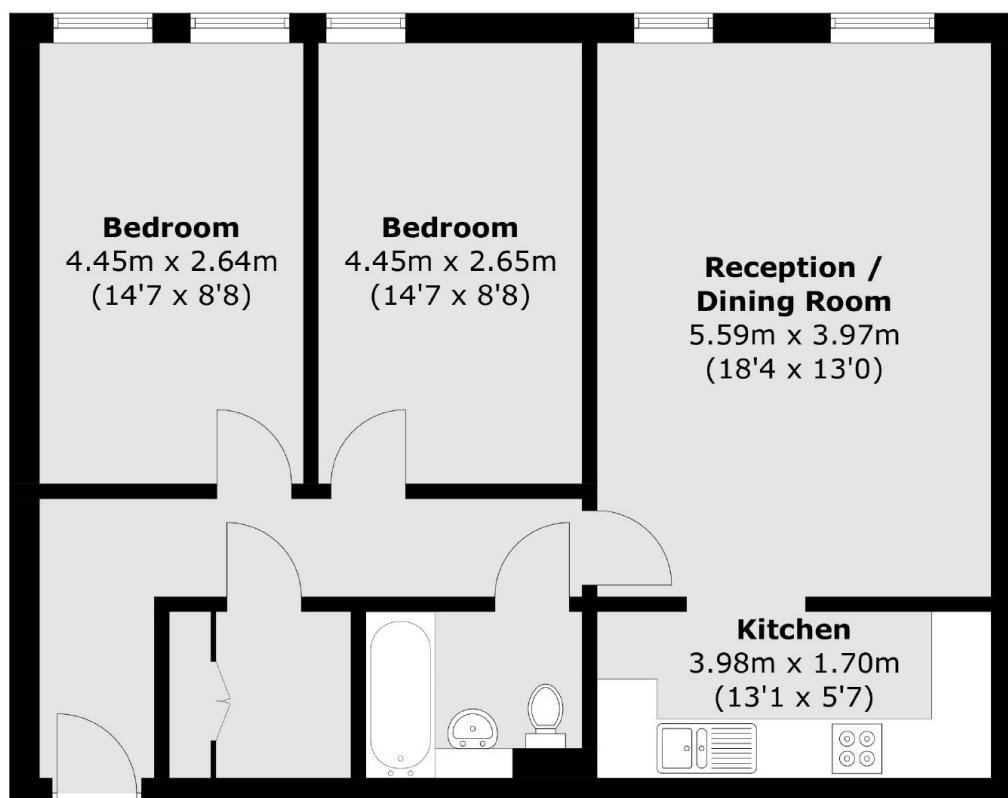

Total area (approx.): 71.3 sq. m (767.5 sq. ft)

Dexters

Peckham Rye
2 Barry Parade
Barry Road
London
Sales
020 8742 4146

Energy Rating: B. We aim to make our particulars both accurate and reliable. However they are not guaranteed; nor do they form part of an offer or contract. If you require clarification on any points then please contact us, especially if you're traveling some distance to view. Please note that appliances and heating systems have not been tested and therefore no warranties can be given as to their good working order.

 **RICS** | Regulated
Estate Agent
and Letting Agent

dexters.co.uk