



## Brayards Road, SE15

### £325,000

This delightful one-bedroom flat offers an abundance of natural light and a sense of space that's rare to find in a property of its size. Located on the top floor of a purpose-built building, the flat boasts a bright and airy atmosphere, making it an inviting place to both relax and entertain. The flat's immaculate condition is evident throughout, with clean, well-maintained communal areas that ensure a welcoming and pleasant living environment.

Location is key, and this flat benefits from an excellent position between Peckham Rye Station and Queens Road Station, both only a short walk away, making it incredibly well connected to transport links. Whether you're commuting to work or heading out to explore, you'll have access to everything you need. This flat is also just a stone's throw away from the vibrant buzz of Peckham, where you'll find a diverse range of bars, café, and eateries to enjoy.

### Features

- No Onward Chain
- Top Floor
- Excellent Condition
- Long Lease
- Great Location
- Purpose Built

# Brayards Road, London, SE15

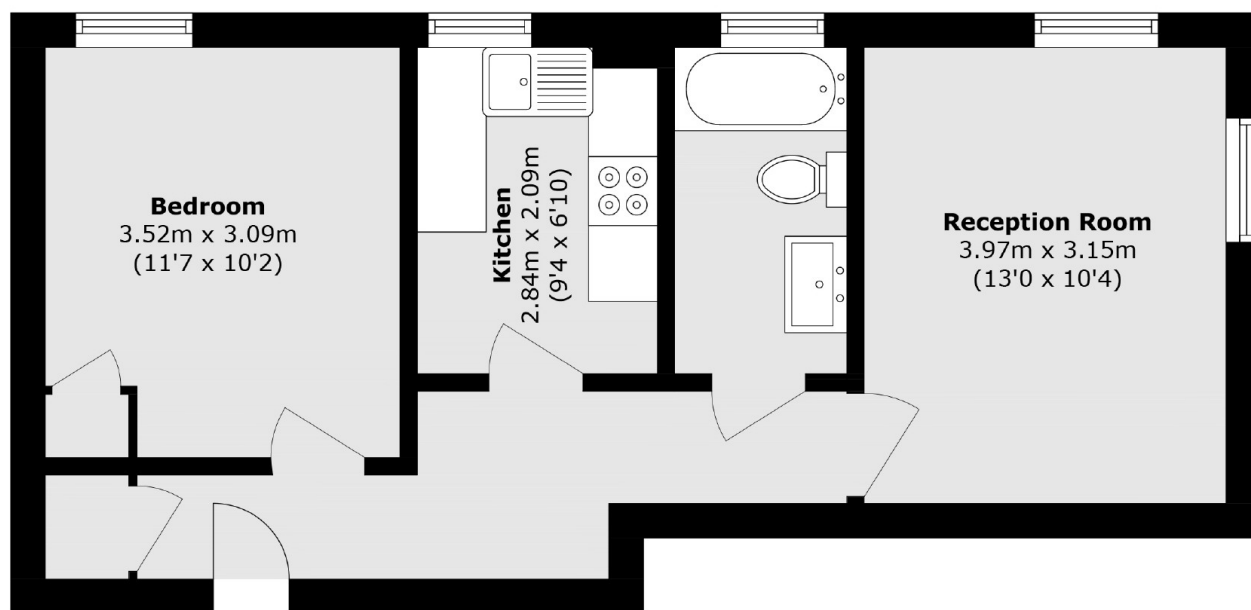

Total area (approx.): 44.0 sq. m (473.6 sq. ft)