



Torridge Gardens, SE15

£700,000

This bright and spacious three bedroom mid-century house has been fully renovated by the current owners creating a fresh contemporary home, and is located just a stones throw away from the beautiful green spaces of Peckham Rye park.

Conveniently located and within easy reach of Peckham Rye & Nunhead stations. Lordship Lane & Nunhead Lane are both within close proximity, and offer an array of independent shops, cafés and restaurants.

Features

- Freehold House
- Three Bedrooms
- Open Plan Kitchen / Reception
- Good Size Private Garden
- Close To Peckham Rye Park
- Fully Renovated



Torridge Gardens, SE15

The downstairs has been opened up creating a well-balanced living space, with beautiful parquet flooring, modern fully fitted kitchen with bi-fold doors opening onto a good size landscaped garden. There is also a handy downstairs W.C and utility cupboard.

Upstairs is a good size family bathroom, two good size double bedrooms with built in wardrobes, and a smaller third bedroom, ideal as a home office or nursery.



Torridge Gardens, London, SE15

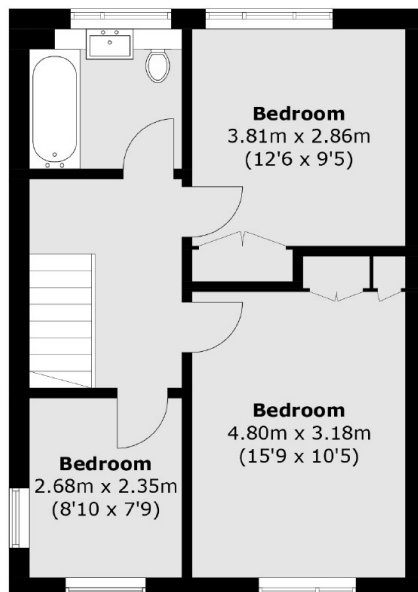

First Floor

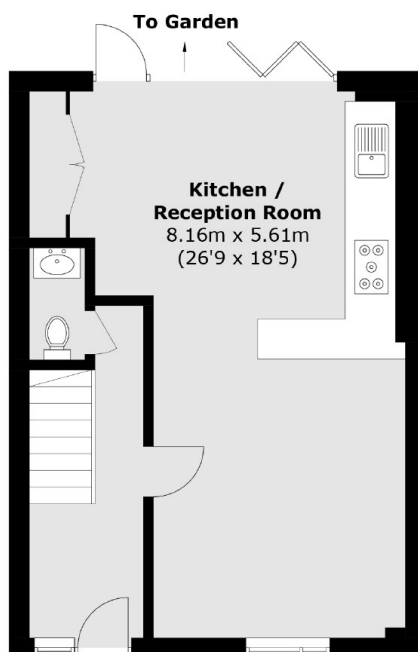

Ground Floor

Total area (approx.): 92.3 sq. m (993.5 sq. ft)