



Galatea Square, SE15

£225,000

This top floor flat occupies 518 sq/ft of internal space and is presented in good condition throughout. The living room is spacious with lots of natural light, and includes a private balcony with views over the communal gardens. The kitchen and bathroom are both recently refurbished, and there is also a good size double bedroom. An ideal first time purchase that also benefits of being sold with no onward chain.

Situated within close proximity to Rye Lane with its eclectic mix of independent bars and restaurants. It is close to the open spaces of Peckham Rye Park with East Dulwich and Lordship Lane easily accessible. Train links are provided via Peckham Rye station for the London Overground and frequent rail links to Victoria, London Bridge, Blackfriars and City Thameslink.

Features

- Top Floor Flat
- One Double Bedroom
- Balcony
- Spacious Living Area
- Close To Peckham Rye Park
- Chain Free

Galatea Square, London, SE15

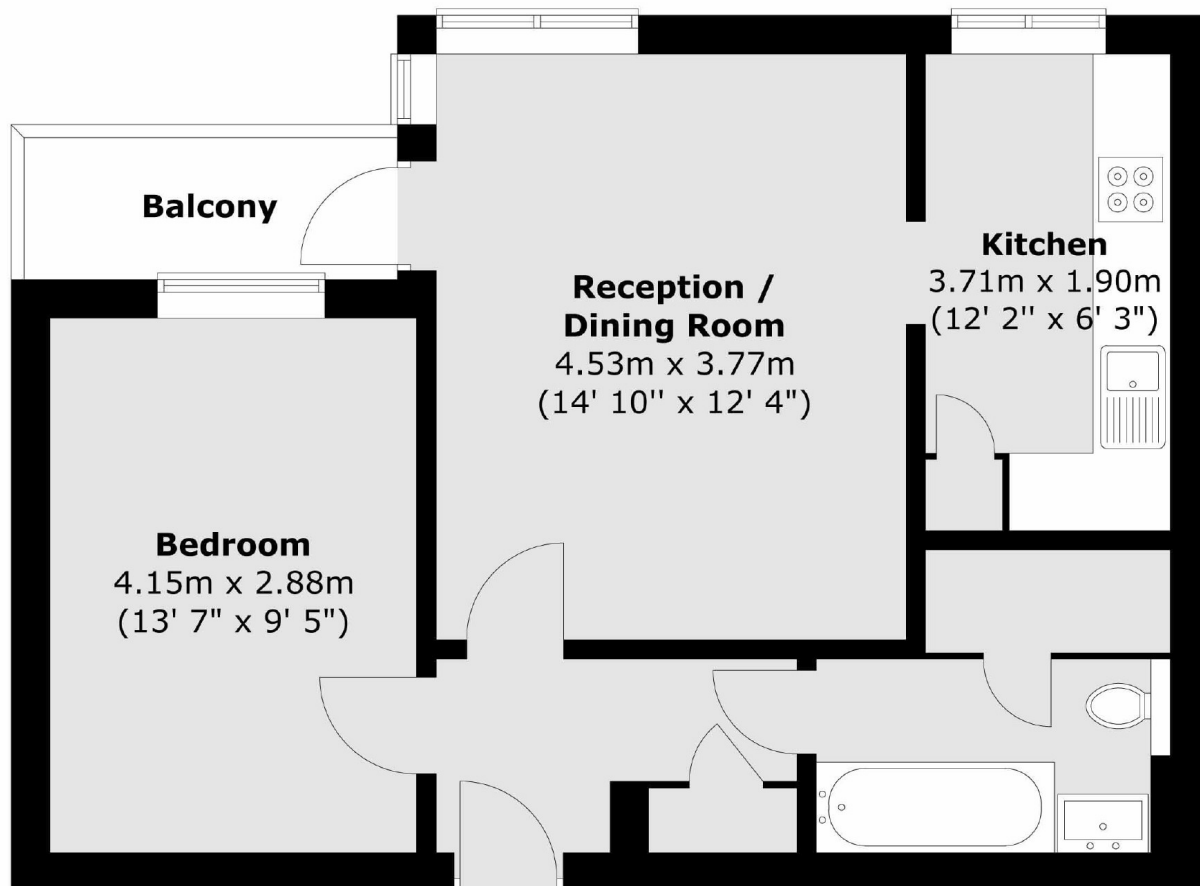

Total area (approx.) : 48.1 sq. m (518 sq. ft)
Total balcony area (approx.) : 3.2 sq. m (34 sq. ft)