



## Marmont Road, SE15

£360,000

A two double bedroom apartment situated within a desirable development just off Peckham High Street. The property offers an abundance of natural light comprising reception with direct access to a private balcony, Modern fitted kitchen and well kept communal gardens.

The property is superbly located for Queens Road Peckham which offers frequent services to The City and West End. Queens Road for its well known independent bars, shops and restaurants is on your doorstep

### Features

- Modern Decor
- Private Balcony
- Modern Kitchen
- Two Double Bedrooms
- Communal Gardens
- Convenient Location

# Marmont Road, London, SE15

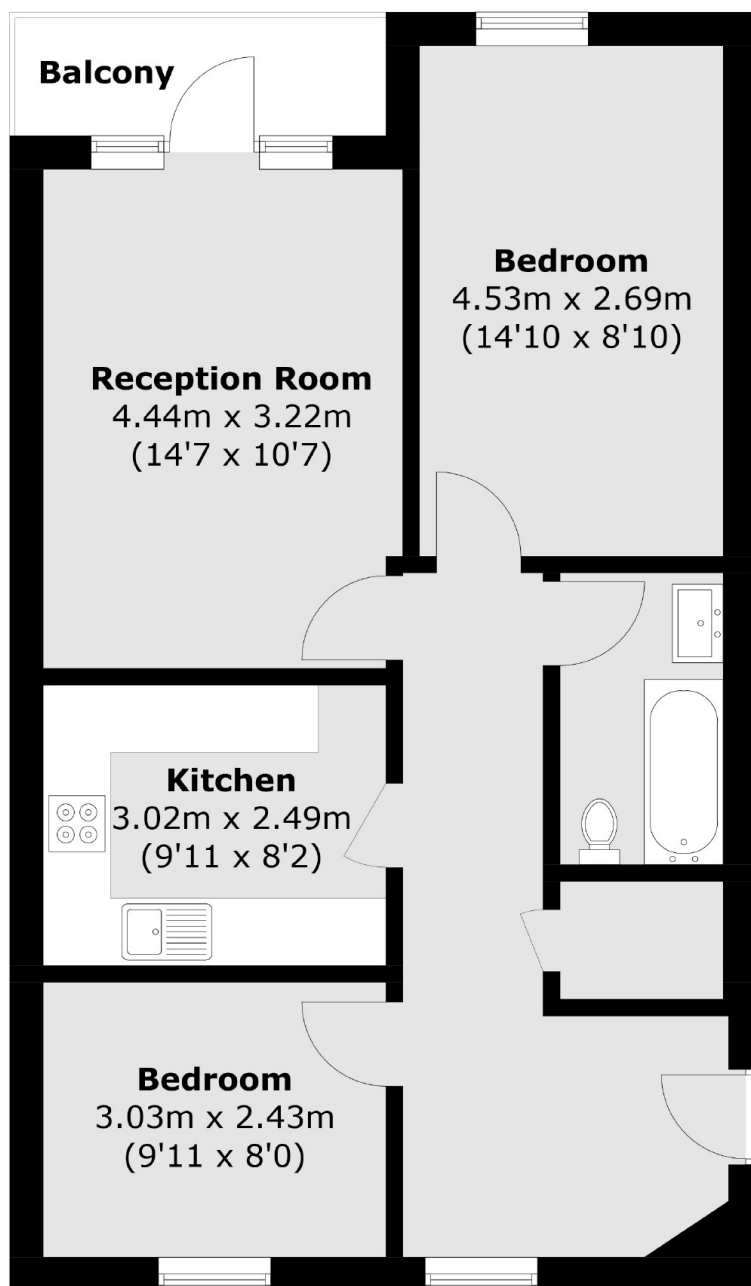

Total area (approx.): 62.0 sq. m (667.4 sq. ft)  
Balcony: 3.5 sq. m (37.7 sq. ft)