



Dagmar Road, SE5

£425,000

Quietly nestled in the historic and leafy surroundings of the much sought after Camberwell Grove neighbourhood, this well cared for one bedroom conversion flat offers a spacious home complete with stunning private garden.

The best of both worlds, Camberwell offers on your doorstep an exciting gastronomic and leisure culture: a choice of fantastic dine-in pubs, independent coffee shops and restaurants, leisure centre and shopping. The open green spaces of Lucas Gardens, Ruskin Park and Brunswick Park, also surround. East Dulwich's Lordship Lane, Bellenden road, and Peckham Rye are close by as are the superb train links from Denmark Hill.

Features

- Period Conversion
- Private Entrance
- Double Bedroom
- Stunning Garden
- Desirable Location
- Close To Transport Links



Dagmar Road, SE5

Occupying the lower ground floor of a wonderful Victorian property and with its own private entrance, accommodation comprises bright front reception with space for dining, galley style kitchen and double bedroom with fitted wardrobes served by a modern bathroom/WC, The property has direct access to a wonderful large garden, fully landscaped with a brick paved seating area and lawn.



Dagmar Road, London, SE5

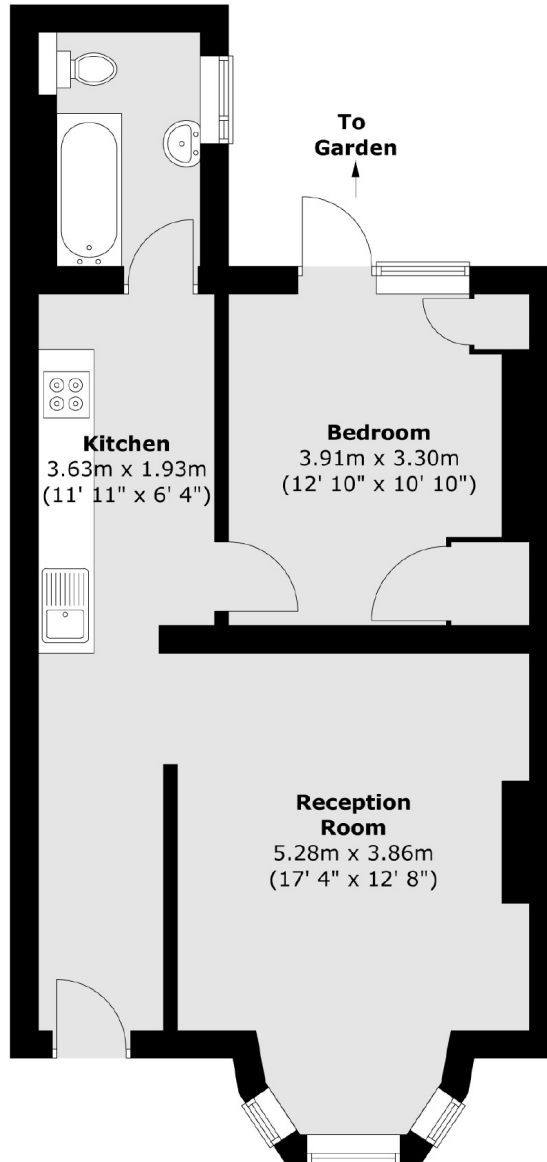

Total area (approx.) : 51 sq. m (549 sq. ft)