



Carlton Grove, SE15

£325,000

Entering via its own front door and located on the first floor is this good size one bedroom flat, located close to all the amenities of Peckham. The property comprises a large open plan living room with fully fitted modern kitchen, good size double bedroom, modern bathroom, and ample storage space. The property also benefits from having an allocated parking space and well maintained communal gardens. A perfect first time buy for someone looking to get on the property ladder.

Carlton Grove is located just off Queens Road within easy reach of Kudu and Smokey Kudu, Peckham Cellars and blackbird bakery amongst others. Transport facilities include Queens Road station for frequent trains to London Bridge and Victoria, plus overground links to Clapham Junction.

Features

- Own Entrance
- First Floor
- Open Plan Layout
- Allocated Parking Space
- Communal Gardens
- Close To Transport Links

Carlton Grove, London, SE15

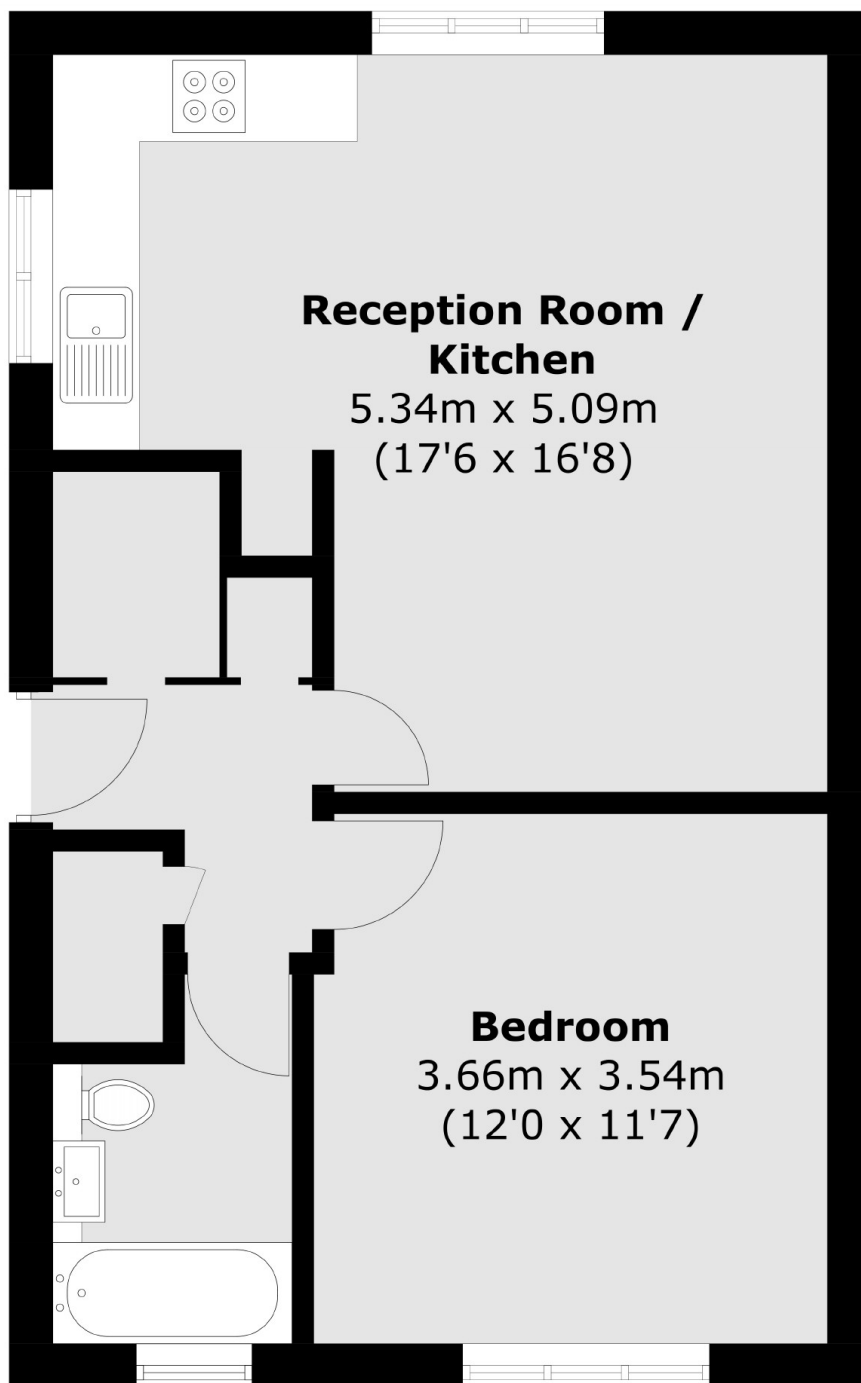

Total area (approx.): 47.7 sq. m (513.4 sq. ft)