



Hanover Park, SE15

£685,000

Dexters



Hanover Park, SE15

Occupying the whole ground floor of a converted and extended Victorian house in a prime central Peckham position, this large, cleverly-designed, two bedroom garden flat has a superb layout measuring just over 750 square feet. It features fantastic living space, a delightful garden and is sold with a share of Freehold.

The properties extended reception room, situated to the rear of the property is wonderfully bright with a designated dining area, it is open plan to a well fitted kitchen with smart-looking units and leads out through bi-fold doors to a superb, landscaped garden with mature borders and a secluded decked, outside sitting area.

The property's two double bedrooms are arranged to the front; the first a large double with bay window, the second with double doors opening onto a cosy and secluded outside seating area. Both have fitted wardrobes and are served by a family bathroom/wc finished in a contemporary style.

Hanover Park is perfectly placed for the green spaces and recreational facilities of Peckham Rye Park. Nunhead and Peckham Rye stations, with excellent transport links into the City and the West End are a short walk away whilst the shops, bars and restaurants of Lordship Lane are close by.

Features

- Naturally Bright
- Excellent Condition
- Two Bedrooms
- Private Garden
- Share Of Freehold
- No Onward Chain



Hanover Park, London, SE15

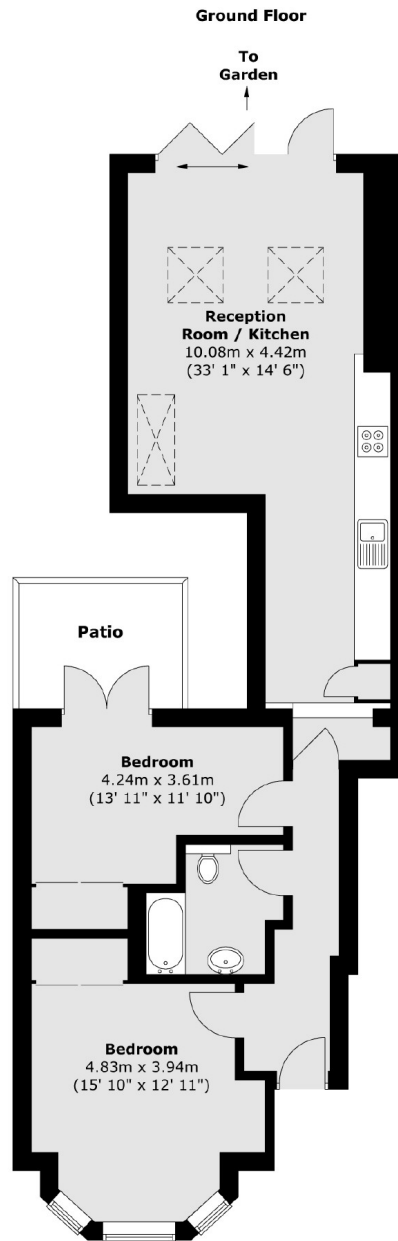

Total area (approx.) : 70.2 sq. m (755 sq. ft)
Total patio area (approx.) : 5.8 sq. m (62 sq. ft)