



Evan Cook Close, SE15

£365,000

This bright, beautifully designed, one bedroom, first floor apartment boasts a generous open-plan kitchen reception room leading to a sunny south-facing wrap around balcony.

Evan Cook Close is superbly located just off Queens Road with its bars, shops, and restaurants on your doorstep. Queens Road Peckham station is a few-minutes walk away which offers frequent services to The City and West End.

Features

- Excellent Condition
- Open Plan Kitchen/Reception
- South Facing Balcony
- Double Bedroom
- Allocated Parking Space
- Bike Storage



Evan Cook Close, SE15

The kitchen features modern units and integrated appliances, and the reception, which leads directly to the private balcony, is spacious enough to accommodate a dining table and desk which provides a perfect home-work space. The good-size double bedroom, with built-in wardrobes, leads off an entrance hall which contains useful storage and is well served by a contemporary bathroom/WC.



Evan Cook Close, London, SE15

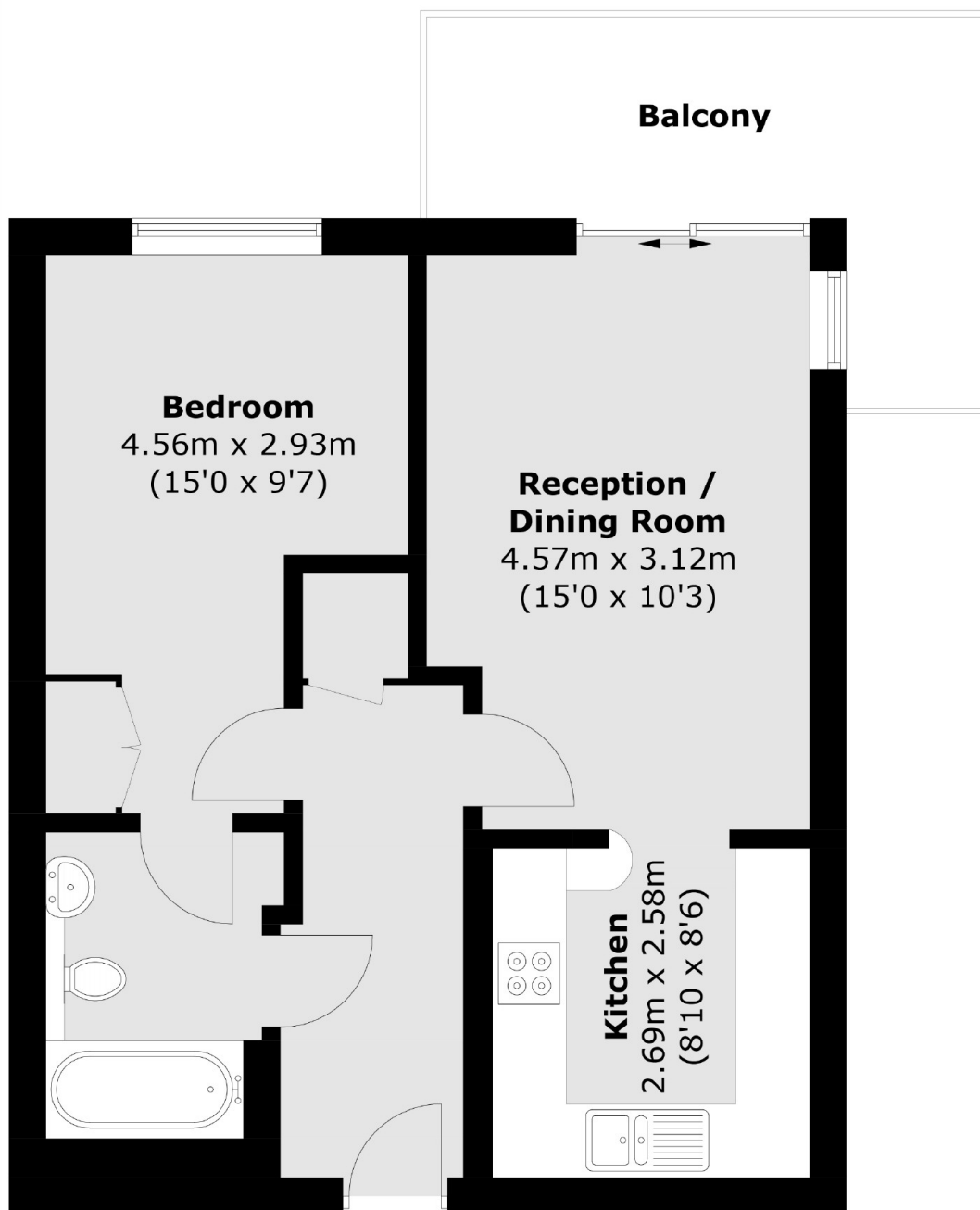

Total area (approx.): 46.6 sq. m (501.6 sq. ft)
Balcony: 9.2 sq. m (99.0 sq. ft)