



Southwell Road, SE5

£350,000

A fantastic first time purchase or buy to let opportunity.

The property is situated very close to Kings College Hospital with easy access to Ruskin Park. Denmark Hill Station is just 7 mins walk with the new Overground Line and trains to Victoria (10 mins) London Bridge (12 mins) and Blackfriars (12 mins). Loughborough Junction station is even closer, with regular trains to Blackfriars (9 minutes). Easy walking distance from the many shops, bars and restaurants of Camberwell (10 mins walk) and Brixton Village (20 minutes walk) and Clapham High Street is one stop on the train.

Features

- Top Floor Period Conversion
- One Bedroom
- Great First Time Buy
- Fantastic Transport Links
- Close To Local Amenities
- Offered Chain Free



Southwell Road, SE5

This top floor conversion flat comes with a good size double bedroom, fitted kitchen, separate living area and modern tiled bathroom and is offered chain free.



Southwell Road, London, SE5

Second Floor

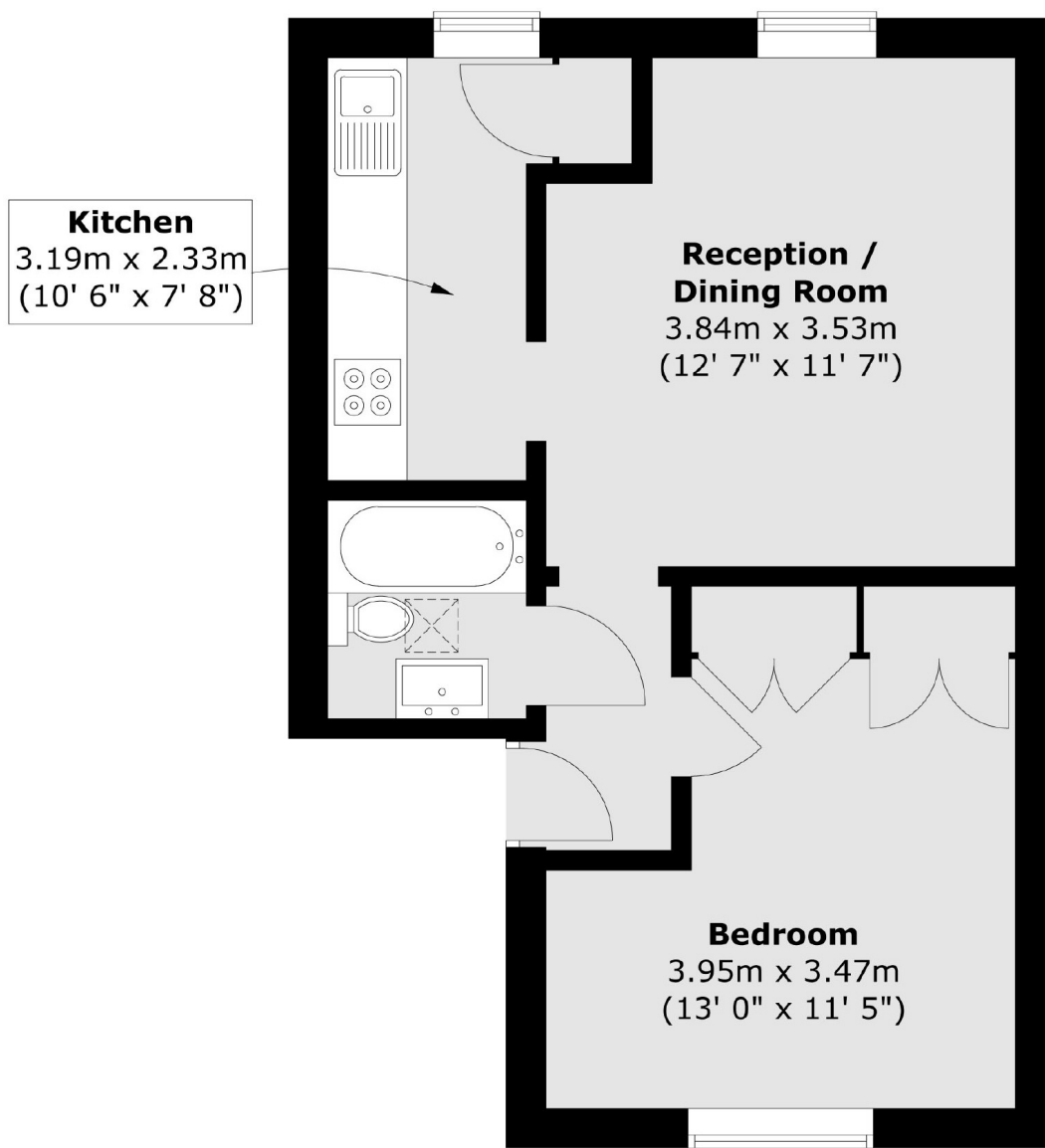

Total area (approx.) : 36.6 sq. m (394 sq. ft)