



Hichisson Road, SE15

£850,000

Stylishly designed and extended to the rear and into the loft with a fresh, contemporary feel throughout, this superb, Victorian, three-bedroom house of just over 1000 square feet offers great living space and a wonderful rear garden.

Hichisson Road is situated within easy reach of Nunhead station for trains to Victoria and Peckham Rye station for trains to London Bridge and Blackfriars, A number of independent local shops can be found on Nunhead Lane with more well known High street restaurants easily accessible on Lordship Lane.

Features

- Fully Extended
- Bright Interior
- Secluded Garden
- Three Bedrooms
- Converted Loft
- Residential Road



Hichisson Road, SE15

The bright through reception room with square bay and feature fireplace leads through to the extended kitchen / breakfast room with white high gloss units and bi-fold doors opening onto the sunny rear garden.

Upstairs on the first floor are two double bedrooms and a family bathroom, with a third large double bedroom within the converted loft.



Hichisson Road, , SE15

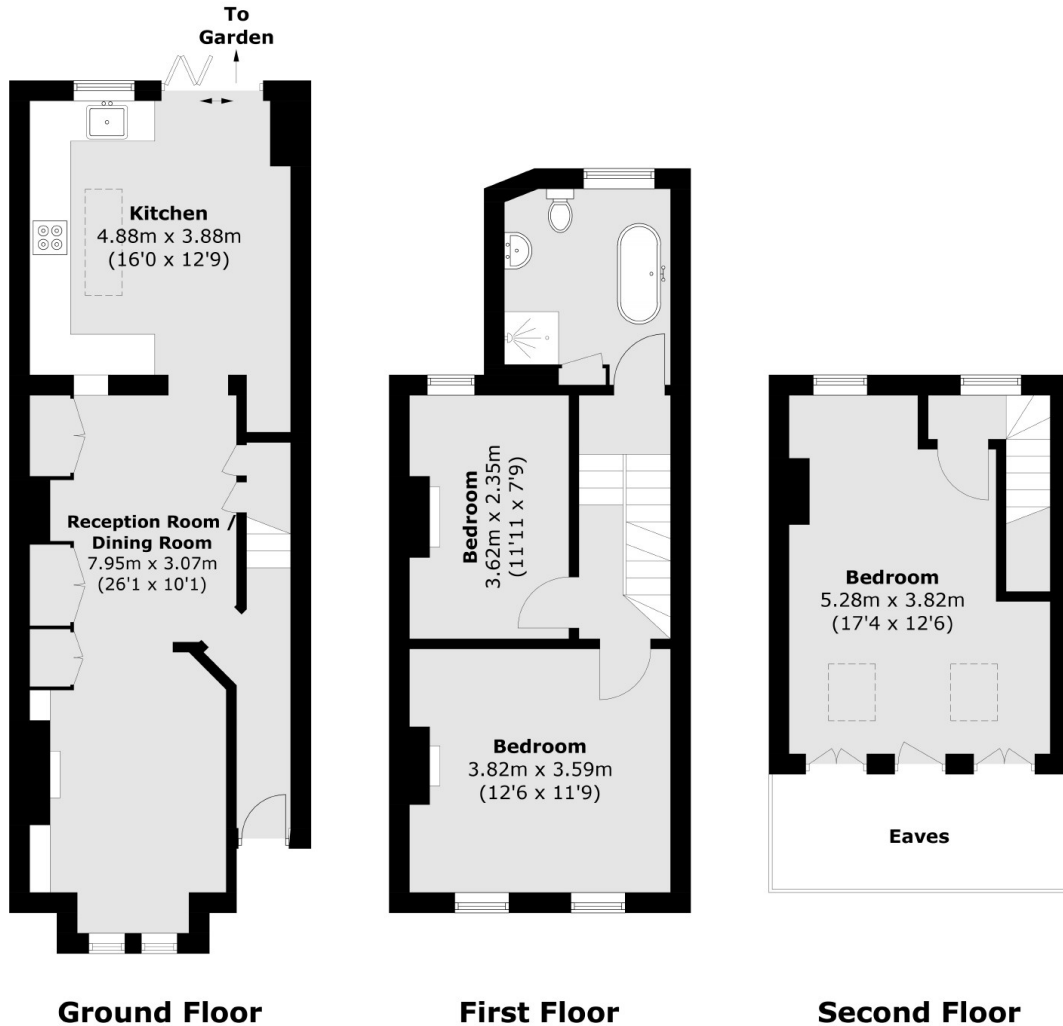

Total area (approx.): 102.0 sq. m (1,097.9 sq. ft)
(Excluding Eaves)