



26 Rosewood Heights
Coombe Valley Road Dover CT17 0FJ
£995 PCM



26 Rosewood Heights, Coombe Valley Road, Dover, CT17 0FJ

The property available is a two bedroom ground floor apartment comprising of an open plan lounge-diner-kitchen with integrated appliances and French doors onto a large garden space, two bedrooms and bathroom. The property will be offered with one allocated parking space.

Dover is steeped in history and rich with heritage. Today it is one of the busiest ports in Europe, with excellent links to the continent.

From Rosewood Heights, Coombe Valley Road provides access to the centre of Dover via the A256, as well as access to the A2 and A20. You are within easy reach of Ashford, Folkestone, Canterbury and Dover.

Note: 12 Months. Council Tax Band B. Guarantors must be provided.



Area Map

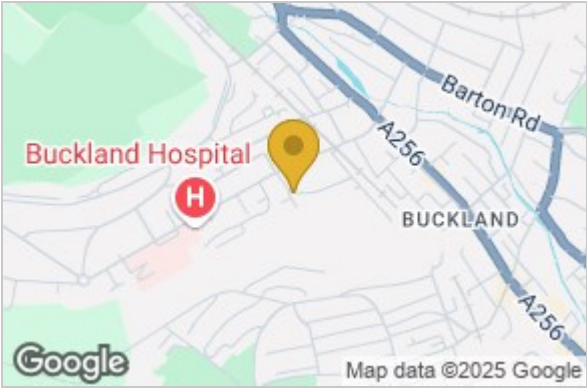

Floor Plan

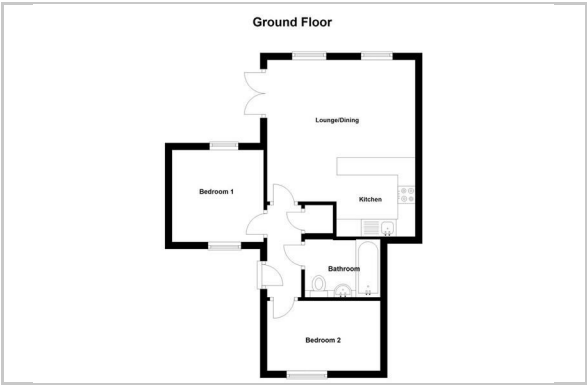

Energy Efficiency Graph

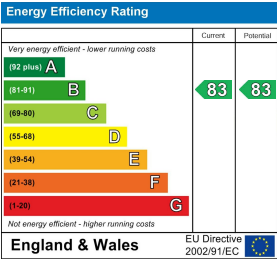

These particulars, whilst believed to be accurate are set out as a general outline only for guidance and do not constitute any part of an offer or contract. Intending purchasers should not rely on them as statements of representation of fact, but must satisfy themselves by inspection or otherwise as to their accuracy. No person in this firms employment has the authority to make or give any representation or warranty in respect of the property.