



11 St Johns Place
Canterbury Kent CT1 1BD
£950 PCM



11 St Johns Place, Canterbury, Kent, CT1 1BD

A split level city centre flat with its own courtyard!! A viewing highly recommended on this maisonette conveniently located for the City Centre. The property comprises fitted kitchen with door onto a courtyard garden, stairs to a lounge, double bedroom and bathroom. Parking is by permit via Canterbury City Council.

NOTE: Regret nopets and not suitable for children. Council Tax Band B.



Area Map



Floor Plan

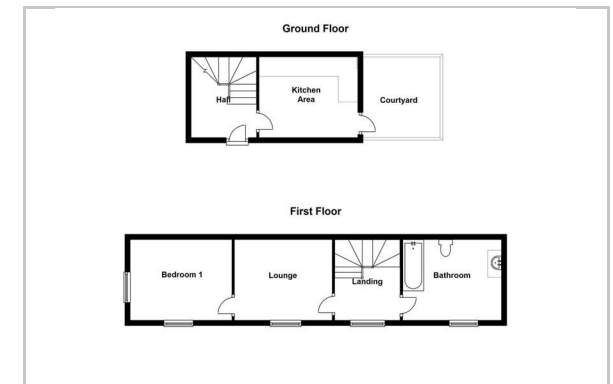

Energy Efficiency Graph

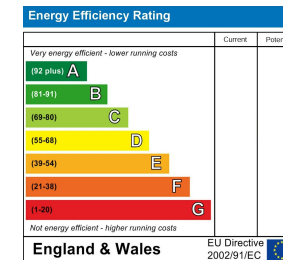

These particulars, whilst believed to be accurate are set out as a general outline only for guidance and do not constitute any part of an offer or contract. Intending purchasers should not rely on them as statements of representation of fact, but must satisfy themselves by inspection or otherwise as to their accuracy. No person in this firm's employment has the authority to make or give any representation or warranty in respect of the property.