



23 Henry Court
Gordon Road Canterbury CT1 3PL
£880 PCM



23 Henry Court, Gordon Road, Canterbury, CT1 3PL

Ground floor one bedroom apartment close to Canterbury East mainline railway station and the City Centre. The property comprises of bedroom, lounge/diner with a modern kitchen and bathroom. Other benefits include UPVC double glazing, ample storage and residents parking. Unfurnished with white goods.

NOTE: 12 Months. Council Tax Band B.



Area Map

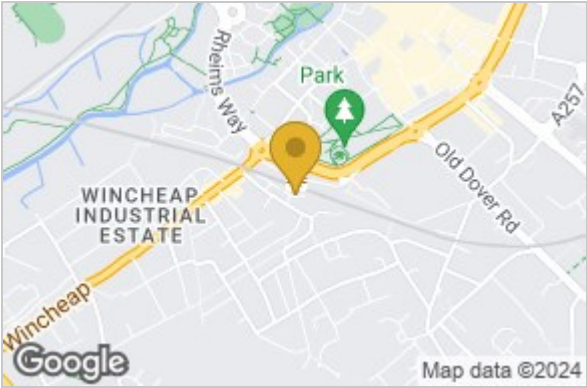

Floor Plan

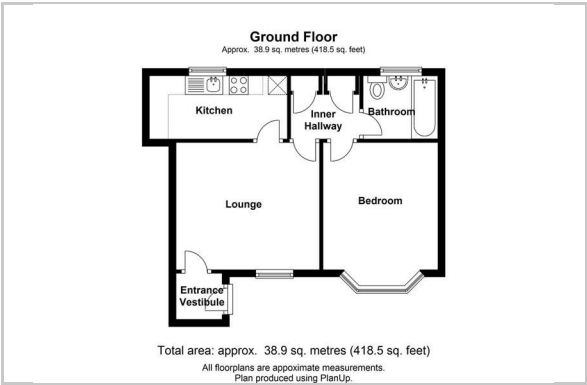

Energy Efficiency Graph

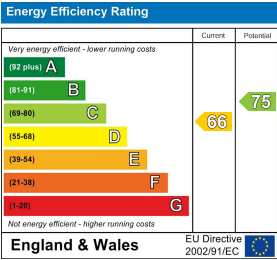

These particulars, whilst believed to be accurate are set out as a general outline only for guidance and do not constitute any part of an offer or contract. Intending purchasers should not rely on them as statements of representation of fact, but must satisfy themselves by inspection or otherwise as to their accuracy. No person in this firms employment has the authority to make or give any representation or warranty in respect of the property.